

RATCHET BUCKLES

Kinedyne offers a complete line of ratchet buckles to handle all types of tie-down applications. All buckles are designed for strength, durability and ease of operation. Ratchet buckles are available for webbing widths 1" to 4" with various handle configurations to satisfy user preferences.

Kinedyne ratchet buckles are made from heat treated carbon steel with a zinc plated finish for corrosion protection.

Operating Instructions:

To tension: Pull webbing through reel bars to eliminate slack. Operate handle back and forth until webbing is properly tensioned. Reel bars must have at least two wraps of webbing to ensure no slippage. Wrench drive models require the use of a socket or wrench.

To release: Pull handle pawl back and rotate handle over center to full open position.

1" STANDARD HANDLE

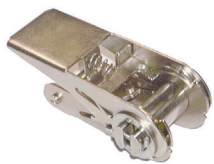

810

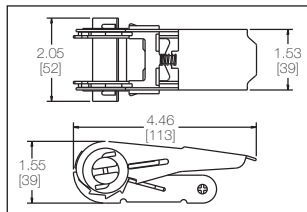

Working Load Limit: 500 lbs./230 kgs.
Weight: 0.51 lbs./0.23 kgs.

Code: 23

1" WIDE HANDLE



809

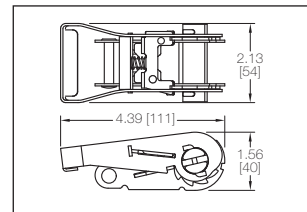

Working Load Limit: 500 lbs./230 kgs.
Weight: 0.54 lbs./0.24 kgs.

Code: 25

1-3/4" WRENCH DRIVE LIFT-TO-RELEASE



FE7630-7

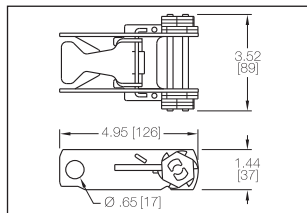

Working Load Limit: 1,235 lbs./560 kgs.
Weight: 1.3 lbs./0.6 kgs.

Code: 90

1" WIDE HANDLE



800

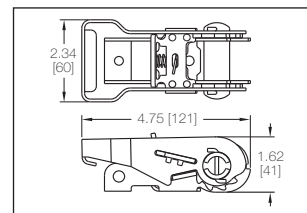

Working Load Limit: 1,100 lbs./500 kgs.
Weight: 0.74 lbs./0.34 kgs.

Code: 27

1-3/4" HOOK END



31000

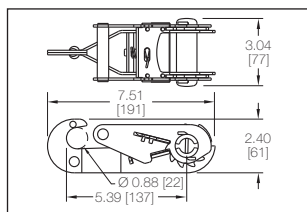

Working Load Limit: 2,000 lbs./910 kgs.
Weight: 1.62 lbs./0.73 kgs.

Code: 39

1-3/4" HOOK END WITH KEEPER



31003

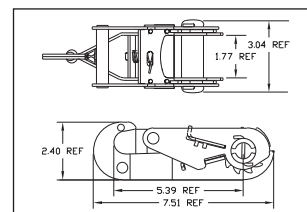

Working Load Limit: 2,000 lbs./909 kgs.
Weight: 1.8 lbs./0.8 kgs.

Code: 34

2" STANDARD HANDLE



811

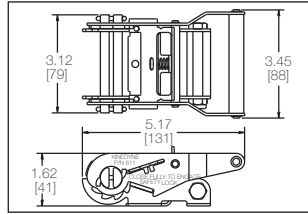

Working Load Limit: 1,670 lbs./751 kgs.
Weight: 1.15 lbs./0.52 kgs.

Code: 37

2" STANDARD HANDLE



802

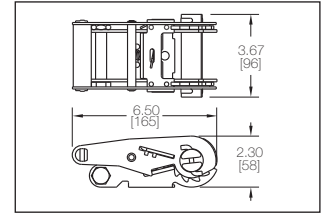

Working Load Limit: 3,670 lbs./1665 kgs.
Weight: 2.25 lbs./1.02 kgs.

Code: 29

2" LONG HANDLE



FE7700-1

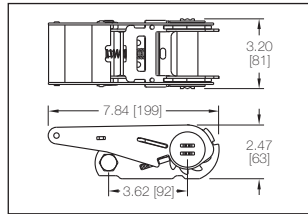

Working Load Limit: 3,750 lbs./1705 kgs.
Weight: 2.57 lbs./1.17 kgs.

Code: 91

2" WIDE HANDLE



804

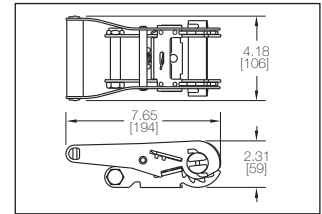

Working Load Limit: 4,000 lbs./1814 kgs.
Weight: 2.41 lbs./1.09 kgs.

Code: 30

2" STANDARD HANDLE WITH WIDE RELEASE



815

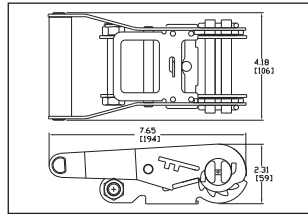

Working Load Limit: 3,670 lbs./1665 kgs.
Weight: 2.41 lbs./1.09 kgs.

2" LONG WIDE HANDLE



803

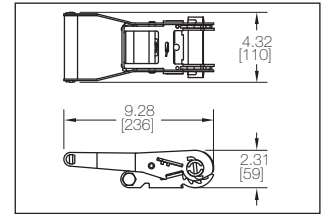

Working Load Limit: 4,000 lbs./1814 kgs.
Weight: 2.44 lbs./1.11 kgs.

Code: 35

2" STAINLESS STEEL WITH WIDE HANDLE



804SS

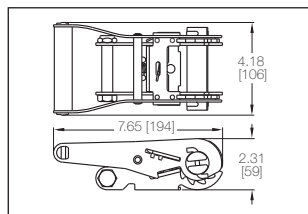

Working Load Limit: 2,935 lbs./1335 kgs.
Weight: 2.91 lbs./1.32 kgs.

Code: 31

2" WIDE HANDLE WITH HOOK



804HK

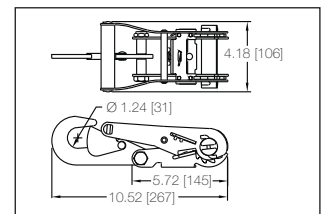

Working Load Limit: 3,670 lbs./1665 kgs.
Weight: 3.21 lbs./1.46 kgs.

Code: 86

3" LONG HANDLE

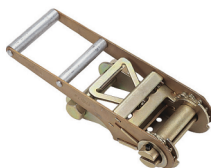

806

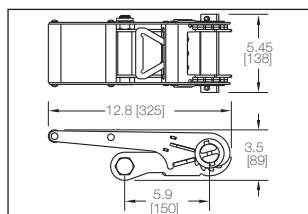

Working Load Limit: 5,670 lbs./2575 kgs.
Weight: 7.09 lbs./3.26 kgs.

Code: 33

4" LONG HANDLE

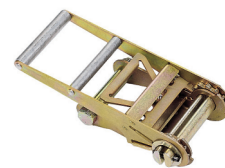

808

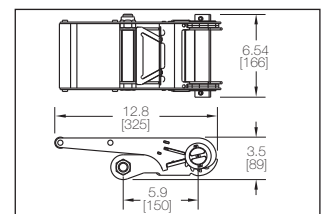

Working Load Limit: 8,000 lbs./3630 kgs.
Weight: 8.17 lbs./3.71 kgs.

Code: 24



CAM BUCKLES

Kinedyne cam buckles are designed to provide a fast and efficient tie-down method. These buckles are exceptionally durable and easy to operate. Strength ratings are contingent upon the use of recommended webbing.

Kinedyne cam buckles are made from diecast zinc alloys and carbon steel with a zinc plated finish.

NOTE: Cam pin joint should be periodically lubricated with a spray lubricant to keep lever operating properly.

Operating Instructions:

To tension: Pull handhold until desired tension is achieved.

To release: Press cam.

1" CAM BUCKLE



607

Working Load Limit: 200 lbs./95 kgs.
Weight: 0.08 lbs./0.04 kgs.

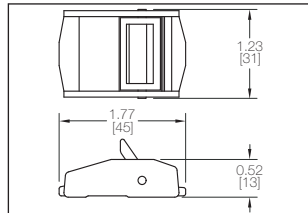

Code: 60

1" CAM BUCKLE



608

Working Load Limit: 235 lbs./110 kgs.
Weight: 0.13 lbs./0.06 kgs.

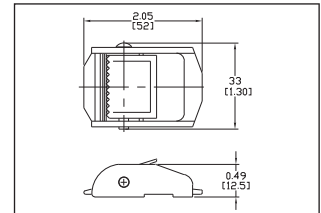

Code: 26

Webbing: FE129 or 1010 & 1000

1" CAM BUCKLE ONE-PIECE FRAME



605

Working Load Limit: 500 lbs./226 kgs.
Weight: 0.27 lbs./0.12 kgs.

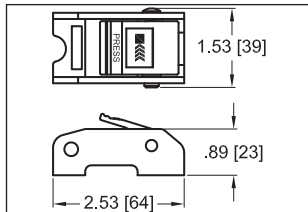

Code: 21

Webbing: 1000

1" CAM BUCKLE



FE8055-1

Working Load Limit: 835 lbs./380 kgs.
Weight: 0.44 lbs./0.20 kgs.

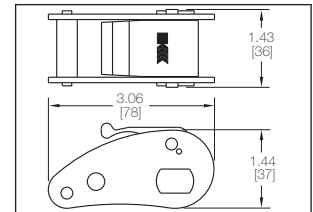

Code: 97

Webbing: 30100 or FE174

1" CAM BUCKLE

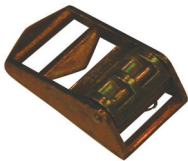

31210 - NAS1382-7

Working Load Limit: 170 lbs./80 kgs.
Weight: 0.13 lbs./0.06 kgs.

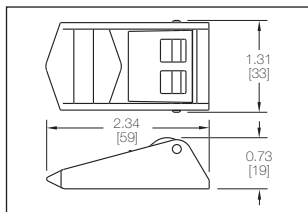

Code: 18

Webbing: FE129

2" CAM BUCKLE



43010

Working Load Limit: 835 lbs./380 kgs.
Weight: 0.69 lbs./0.31 kgs.

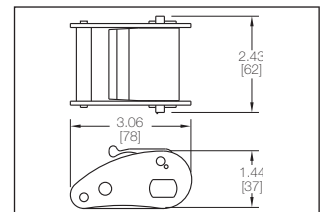

Code: 19

Webbing: 4900

2" CAM BUCKLE ONE-PIECE FRAME



910

Working Load Limit: 835 lbs./380 kgs.
Weight: 0.58 lbs./0.26 kgs.

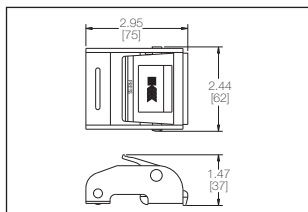

Code: 81

Webbing: 4900

2" SLIDE BAR BUCKLE

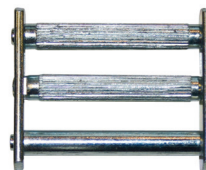

914

Working Load Limit: 167 lbs./76 kgs.
Weight: 0.20 lbs./0.09 kgs.

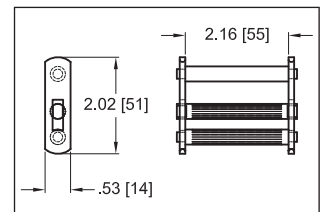

Code: 97

Webbing: 2010SBP

2" CAM BUCKLE



31100 – NAS1211F20

Working Load Limit: 835 lbs./379 kgs.
Weight: 0.33 lbs./0.15 kgs.

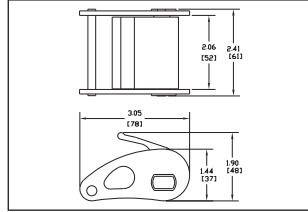

Code: 12

1" CAM BUCKLE



31104 – NAS1211F10

Working Load Limit: 600 lbs./272 kgs.
Weight: 0.19 lbs./0.09 kgs.

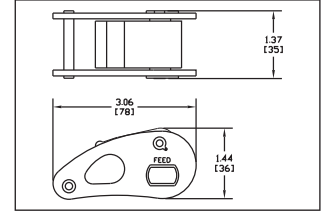

Code: 13

OVERCENTER BUCKLES

Kinedyne overcenter buckles enable the user to put additional tension on the strap through an effective overcenter toggle action with minimum wear to the webbing. All overcenter buckles, except the 905 and 960 feature a positive lock mechanism.

Kinedyne overcenter buckles are made from carbon steel with either a zinc plated, powder coated or stainless steel finish.

Operating Instructions:

To tension: Apply initial tension by pulling the handhold strap while the buckle handle is in the open position. As the handle is closed, additional strap tensioning occurs.

To release: Models 909, 970, 974 and FE8265-1 release by disengaging the spring-loaded locking latch. All other models release by simply pulling up on the handhold strap.

1" OVERCENTER BUCKLE



FE8265-1

Working Load Limit: 1,000 lbs./455 kgs.
Weight: 0.7 lbs./0.3 kgs.

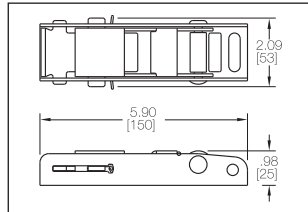

Code: 98
Webbing: FE174

1-3/4" OVERCENTER BUCKLE STAINLESS STEEL



970

Working Load Limit: 1,000 lbs./455 kgs.
Weight: 0.76 lbs./0.34 kgs.

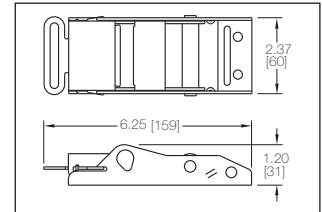

Code: 88
Webbing: 1802

1-3/4" OVERCENTER BUCKLE



903

Working Load Limit: 335 lbs./155 kgs.
Weight: 0.2 lbs./0.1 kgs.

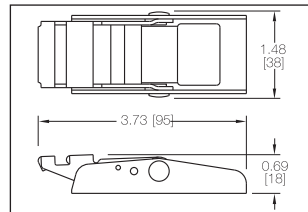

Code: 78
Webbing: 1000, 1010, FE129

2" OVERCENTER BUCKLE



909

Working Load Limit: 1,335 lbs./605 kgs.
Weight: 0.64 lbs./0.29 kgs.

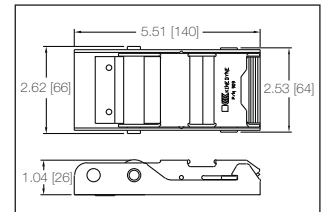

Code: 85
Webbing: 1802



1-3/4" OVERCENTER BUCKLE**974**

Working Load Limit: 1,670 lbs./760 kgs.
Weight: 1.1 lbs./0.5 kgs.

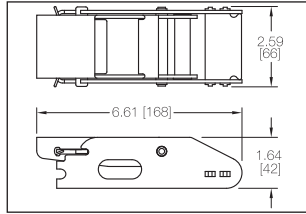

Code: 82
Webbing: 1802, 30118

1-3/4" OVERCENTER BUCKLE WITH HOOK**975**

Working Load Limit: 1,670 lbs./760 kgs.
Weight: 1.4 lbs./0.6 kgs.

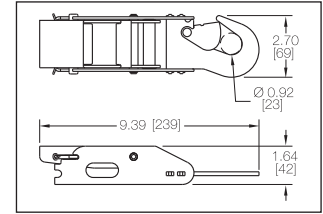

Code: 83
Webbing: 1802, 30118

2" OVERCENTER BUCKLE**905**

Working Load Limit: 500 lbs./230 kgs.
Weight: 0.56 lbs./0.25 kgs.

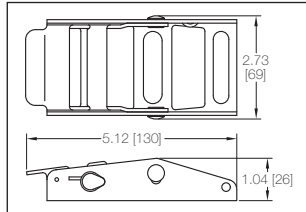

Code: 79
Webbing: 4900

2" OVERCENTER BUCKLE BLACK FINISH**960**

Working Load Limit: 600 lbs./275 kgs.
Weight: 0.62 lbs./0.28 kgs.

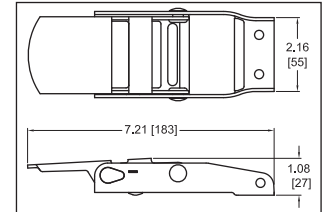

Code: 87
Webbing: 2010, 4900

FLAT HOOKS

Kinedyne flat hooks are made from heat treated carbon steel and are either zinc plated or black e-coated.

1" FLAT HOOK WITH KEEPER**1044**

Working Load Limit: 1,150 lbs./525 kgs.
Weight: 0.1 lbs./0.05 kgs.

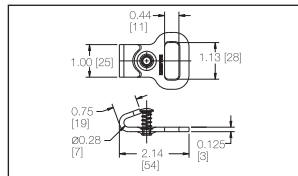

Code: 80

1" FLAT HOOK**34038-3** - NAS1382-4

Working Load Limit: 235 lbs./110 kgs.
Weight: 0.04 lbs./0.02 kgs.

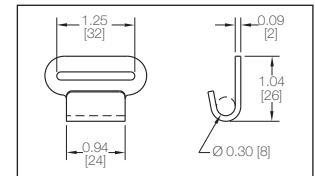

Code: 31

2" FLAT HOOK**34038-4**

Working Load Limit: 1,835 lbs./835 kgs.
Weight: 0.40 lbs./0.18 kgs.

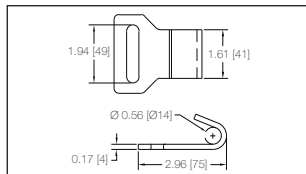

Code: 27

2" FLAT HOOK**1015**

Working Load Limit: 3,335 lbs./1515 kgs.
Weight: 0.68 lbs./0.31 kgs.

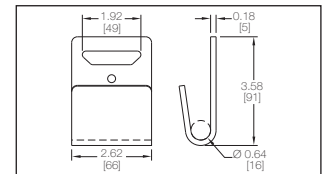

Code: 20

4" FLAT HOOK WITH ABRASION CLIP**1021**

Working Load Limit: 5,400 lbs./2450 kgs.
Weight: 1.09 lbs./0.49 kgs.

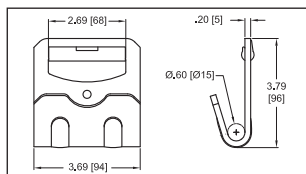

Code: 21

S HOOKS

Kinedyne S Hooks are either zinc plated or black e-coated or black vinyl coated.

1" S HOOK



1104 – Zinc Plated

Working Load Limit: 170 lbs./80 kgs.
Weight: 0.14 lbs./0.06 kgs.

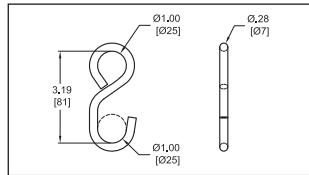

Code: 72

1" HD S HOOK



1102 – Zinc Plated

Working Load Limit: 500 lbs./230 kgs.
Weight: 0.29 lbs./0.13 kgs.

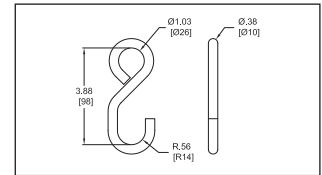

Code: 88

1" S HOOK



1103 – Vinyl Coated

Working Load Limit: 170 lbs./80 kgs.
Weight: 0.15 lbs./0.07 kgs.

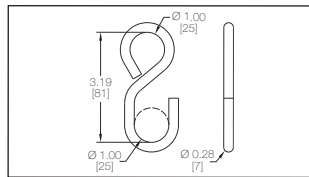

Code: 89

1" HD S HOOK



1101 – Vinyl Coated

Working Load Limit: 500 lbs./230 kgs.
Weight: 0.31 lbs./0.14 kgs.

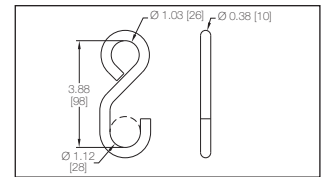

Code: 87

4" S HOOK



8670 – E-Coated

Working Load Limit: 1,000 lbs./455 kgs.
Weight: 0.39 lbs./0.18 kgs.

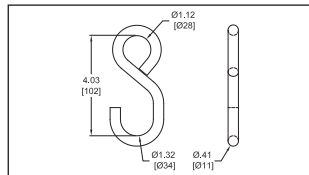

Code: 28

4" HD S HOOK



8669 – E-Coated

Working Load Limit: 1,800 lbs./818 kgs.
Weight: 0.61 lbs./0.28 kgs.

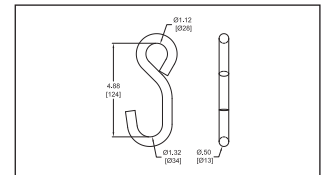

Code: 37

4" S HOOK



8670Z – Zinc Plated

Working Load Limit: 1,000 lbs./455 kgs.
Weight: 0.39 lbs./0.18 kgs.

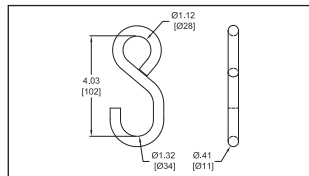

Code: 28

4" S HOOK



8670V – Vinyl Coated

Working Load Limit: 1,000 lbs./455 kgs.
Weight: 0.41 lbs./0.19 kgs.

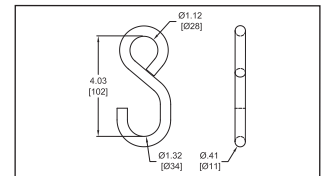

Code: 28

SNAP HOOKS

Kinedyne snap hooks are made from heat treated carbon steel with a zinc plated finish, except for 1212SS which is stainless steel.

1" SNAP HOOK



FE8028-1

Working Load Limit: 1,835 lbs./835 kgs.
Weight: 0.22 lbs./0.10 kgs.

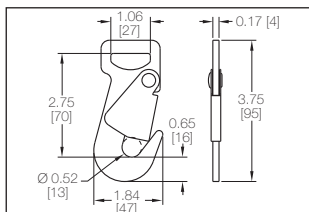

Code: 69

1-3/4" TWISTED SNAP HOOK



1207

Working Load Limit: 1,670 lbs./760 kgs.
Weight: 0.3 lbs./0.2 kgs.

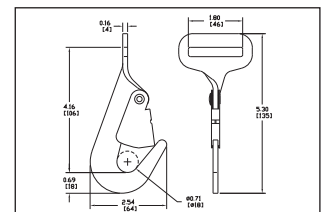

Code: 62

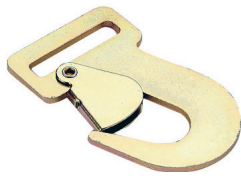

2" SNAP HOOK**FE7900-1**

Working Load Limit: 2,000 lbs./910 kgs.
Weight: 0.37 lbs./0.17 kgs

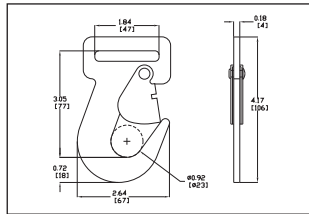
**Code: 70****2" SNAP HOOK****1209**

Working Load Limit: 3,335 lbs./1515 kgs.
Weight: 0.69 lbs./0.31 kgs.

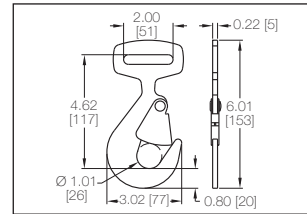
**Code: 63****2" SNAP HOOK****31410**

Working Load Limit: 3,335 lbs./1515 kgs.
Weight: 0.70 lbs./0.31 kgs.

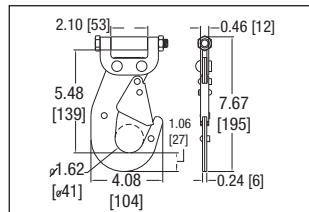
**Code: 65****1-3/4" FORGED SNAP HOOK****31417 – PIA-PS22042-1**

Working Load Limit: 1,670 lbs./760 kgs.
Weight: 0.36 lbs./0.16 kgs.

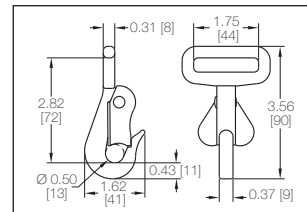
**Code: 66****2" FORGED SNAP HOOK****1211**

Working Load Limit: 3,335 lbs./1515 kgs.
Weight: 0.93 lbs./0.42 kgs.

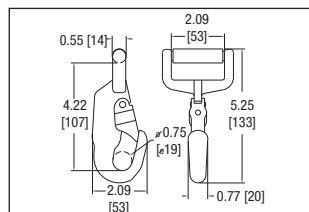
**Code: 85****2" TWISTED SNAP HOOK****1212**

Working Load Limit: 3,335 lbs./1515 kgs.
Weight: 0.70 lbs./0.32 kgs.

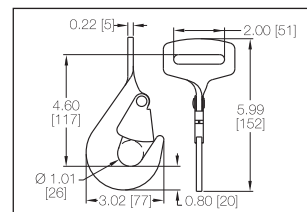
**Code: 64****2" TWISTED SNAP HOOK STAINLESS STEEL****1212SS**

Working Load Limit: 1,670 lbs./760 kgs.
Weight: 0.70 lbs./0.32 kgs.

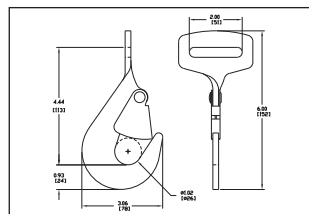
**Code: 71****EYE-HOLE SNAP HOOK****1202**

Working Load Limit: 3,335 lbs./1515 kgs.
Weight: 0.56 lbs./0.25 kgs.

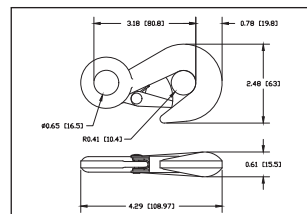
**Code: 61**

WIRE HOOKS

Kindeyne wire hooks and rings are made from heat treated carbon steel with a zinc plated finish.

1" U HOOK



C1003

Working Load Limit: 167 lbs./76 kgs.
Weight: 0.07 lbs./0.03 kgs.

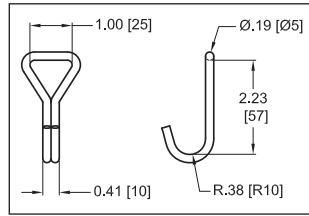

Code: 86

1" HD NARROW HOOK



1003

Working Load Limit: 835 lbs./380 kgs.
Weight: 0.12 lbs./0.05 kgs.

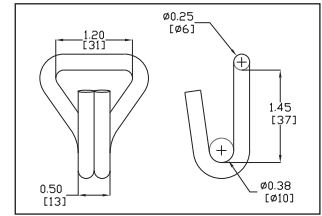

Code: 81

1" NARROW HOOK



1004

Working Load Limit: 170 lbs./80.0 kgs.
Weight: 0.1 lbs./0.02 kgs.

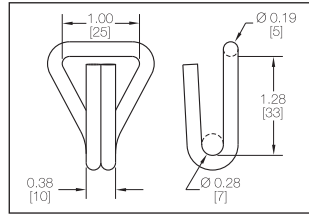

Code: 82

1" NARROW HOOK



34031-18 - NAS1382-2

Working Load Limit: 267 lbs./120 kgs.
Weight: 0.05 lbs./0.02 kgs.

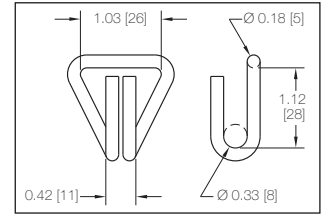

Code: 33

1" OPEN HOOK



34031-8 - NAS1211E10

Working Load Limit: 1,000 lbs./455 kgs.
Weight: 0.10 lbs./0.05 kgs.

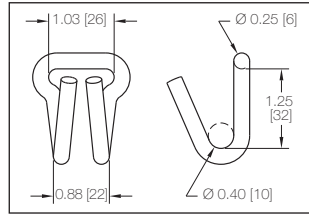

Code: 77

1" NARROW HOOK



34031-10 - NAS1211D10

Working Load Limit: 900 lbs./410 kgs.
Weight: 0.10 lbs./0.04 kgs.

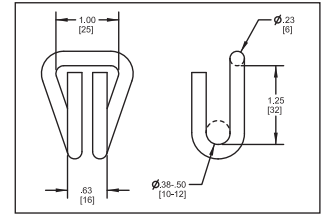

Code: 78

2" WIRE PROPANE TANK HOOK



C1020

Working Load Limit: 250 lbs./113 kgs.
Weight: 0.12 lbs./0.05 kgs.

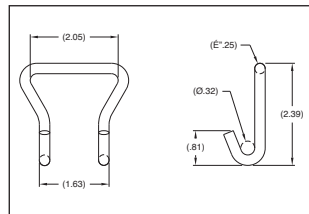

Code: 14

2" NARROW HOOK



1005

Working Load Limit: 500 lbs./230 kgs.
Weight: 0.18 lbs./0.08 kgs.

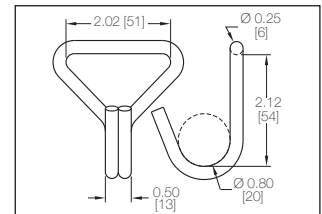

Code: 04

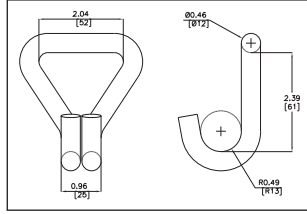

2" HD NARROW HOOK**1006****Code: 84**

Working Load Limit: 3,700 lbs./1700 kgs.
Weight: 0.62 lbs./0.28 kgs.

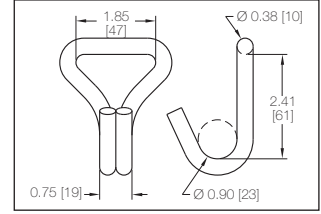
2" NARROW HOOK**1007****Code: 60**

Working Load Limit: 1,670 lbs./760 kgs.
Weight: 0.38 lbs./0.17 kgs.

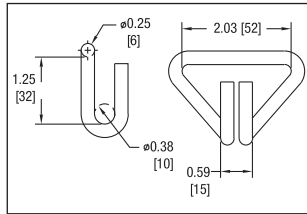
2" WIRE HOOK**34031-12** – NAS1211D20**Code: 79**

Working Load Limit: 835 lbs./380 kgs.
Weight: 0.12 lbs./0.06 kgs.

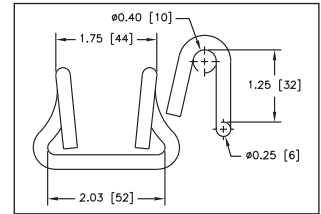
2" OPEN HOOK**34031-17** – NAS1211E20**Code: 32**

Working Load Limit: 835 lbs./380 kgs.
Weight: 0.11 lbs./0.05 kgs.

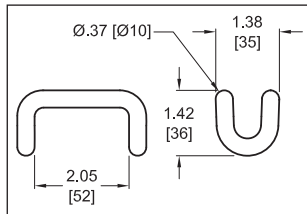
RAVE HOOK**9003****Code: 77**

Working Load Limit: 1,000 lbs./455 kgs.
Weight: 0.10 lbs./0.05 kgs.

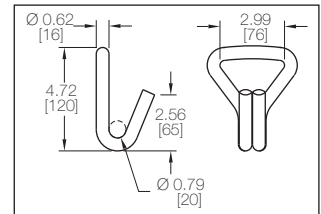
3" NARROW HOOK**1016****Code: 36**

Working Load Limit: 7,333 lbs./3330 kgs.
Weight: 1.40 lbs./0.64 kgs.

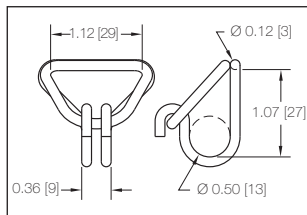
1" HOOK AND KEEPER**33206** – NAS1382-5**Code: 73**

Working Load Limit: 400 lbs./185 kgs.
Weight: 0.04 lbs./0.02 kgs.

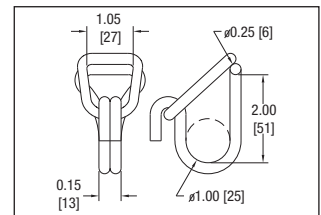
1" HOOK AND KEEPER**33207****Code: 74**

Working Load Limit: 3,000 lbs./1360 kgs.
Weight: 0.30 lbs./0.14kgs.

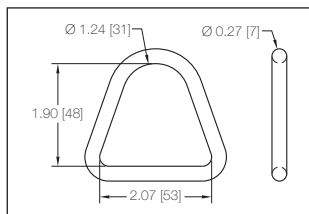

2" D-RING**1027**

Working Load Limit: 1,670 lbs./760 kgs.
Weight: 0.10 lbs./0.06 kgs.

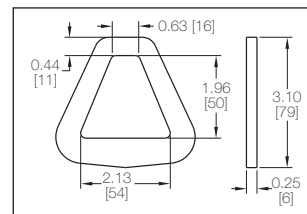
Code: 44**2" FLAT DELTA RING****1023**

Working Load Limit: 3,335 lbs./1515 kgs.
Weight: 0.32 lbs./0.15 kgs.

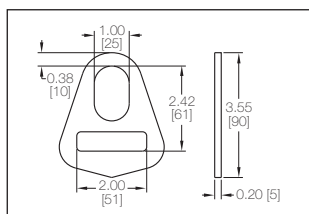
Code: 42**2" FLAT DELTA RING****FE7936-1**

Working Load Limit: 5,400 lbs./2450 kgs.
Weight: 0.28 lbs./0.13 kgs.

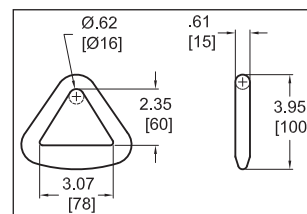
Code: 55**3" DELTA RING****1025**

Working Load Limit: 6,000 lbs./2720 kgs.
Weight: 0.80 lbs./0.36 kgs.

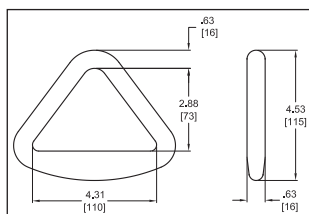
Code: 25**4" DELTA RING****1026**

Working Load Limit: 6,670 lbs./3025 kgs.
Weight: 1.25 lbs./0.57 kgs.

Code: 10

CHAIN ENDS

2" CHAIN ANCHOR



3705-2

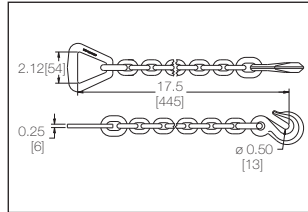

Working Load Limit: 3,335 lbs./1515 kgs.
Weight: 2.67 lbs./1.21 kgs.

Code: 39

3" - 4" CHAIN ANCHOR



3705-3

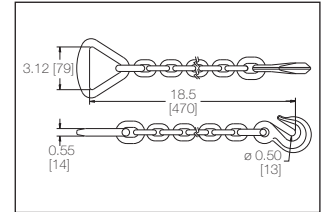

Working Load Limit: 5,400 lbs./2450 kgs.
Weight: 3.76 lbs./1.71 kgs.

Code: 40

3/8" GRAB HOOK ASSEMBLY



3704

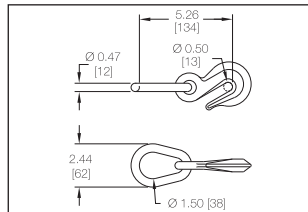

Working Load Limit: 5,400 lbs./2450 kgs.
Weight: 1.4 lbs./0.6 kgs.
Use With: 5/16" and 3/8" chain

Code: 50

LOGISTIC TRACK FITTINGS

Kinedyne logistic track fittings are made from carbon steel and zinc plated for corrosion resistance.

WARNING: Series E, A, F and L track fittings are designed for use with Kinedyne Logistic Track. Load ratings may be reduced when used with other tracks or if the track fitting is not positively engaged. Your cargo control system is only as strong as its weakest link. All ratings for series E and A fittings are based on using Kinedyne 11 gauge track.

SERIES E OR A SPRING LOADED FITTING



FE8306-1

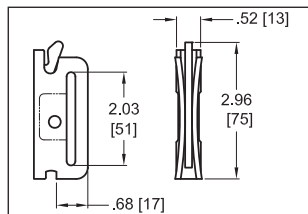

Working Load Limit: 1,500 lbs./680 kgs.
Weight: 0.22 lbs./0.10 kgs.

Code: 01

SERIES E OR A 3-PIECE FITTING



43020-1

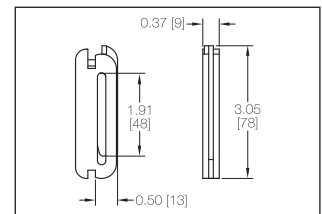

Working Load Limit: 1,000 lbs./455 kgs.
Weight: 0.2 lbs./0.1 kgs.

Code: 02
Also Available: 43020-2

SERIES E OR A FITTING WITH 2" D-RING



FE8301-1

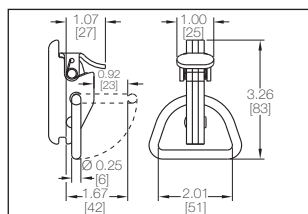

Working Load Limit: 2,000 lbs./910 kgs.
Weight: 0.46 lbs./0.21 kgs.
*Based on 45° pull away from keeper.

Code: 17

SERIES E OR A FITTING WITH 1" RING



FE8264-1

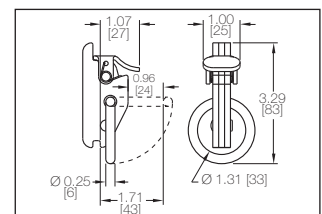

Working Load Limit: 2,000 lbs./910 kgs.
Weight: 0.31 lbs./0.14 kgs.
*Based on 45° pull away from keeper.

Code: 05



1" TRACK FITTING**C1823**

Working Load Limit: 670 lbs./305 kgs.
Weight: 0.09 lbs./0.04 kgs.

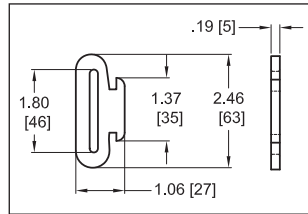

Code: 15
Track: 1806

SERIES F 2-PIECE BUTTERFLY FITTING**1831**

Working Load Limit: 500 lbs./230 kgs.
Weight: 0.1 lbs./0.05 kgs.

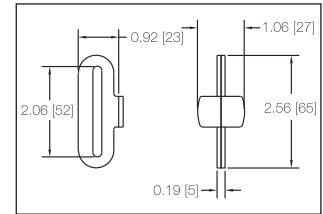

Code: 03

1" TRACK BUTTERFLY FITTING**C1831**

Working Load Limit: 670 lbs./304 kgs.
Weight: 0.13 lbs./0.06 kgs.

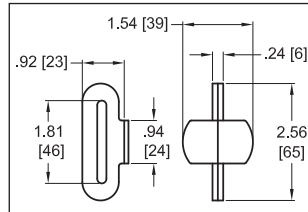

Code: 18
Track: 1805, 1806

SINGLE L FITTING WITH STUD NUT**FE200744**

0° Vertical Working Load Limit: 1,670 lbs./760 kgs.
Weight: 0.10 lbs./0.05 kgs.

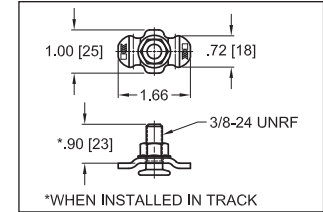
**SERIES L SINGLE STUD FITTING WITH RING****32401**

0° Vertical Working Load Limit: 1,333 lbs./605 kgs.
45° Pull Angle Working Load Limit: 1,000 lbs./455 kgs.
90° Horizontal Pull Angle Working Load Limit: 1,000 lbs./455 kgs.
Weight: 0.09 lbs./0.04 kgs.

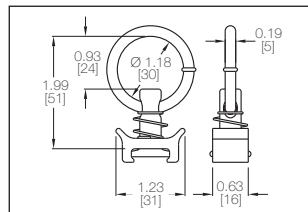

Code: 41

HEAVY DUTY SERIES L TRIPLE STUD FITTING WITH PEAR SHAPED RING**32507**

0° Vertical Working Load Limit: 2,000 lbs./910 kgs.
60° Pull Angle Working Load Limit: 2,000 lbs./910 kgs.
90° Horizontal Pull Angle Working Load Limit: 1,670 lbs./760 kgs.
Weight: 0.34 lbs./0.15 kgs.

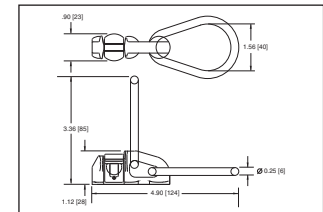

Code: 08

SERIES L TRIPLE STUD FITTING WITHOUT RING**32505**

0° Vertical Working Load Limit: 2,167 lbs./985 kgs.
60° Pull Angle Working Load Limit: 2,000 lbs./910 kgs.
90° Horizontal Pull Angle Working Load Limit: 1,670 lbs./760 kgs.
Weight: 0.23 lbs./0.10 kgs.

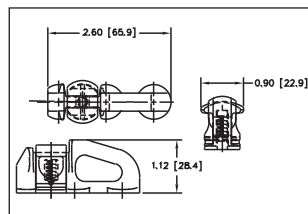

Code: 07

SERIES L ANCHOR PLATE**32620**

0° Vertical Working Load Limit: 1,000 lbs./454 kgs.
Weight: 0.08 lbs./0.04 kgs.

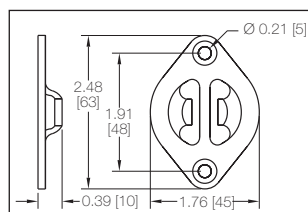

PAN FITTINGS

GALVANIZED PAN FITTING



7196

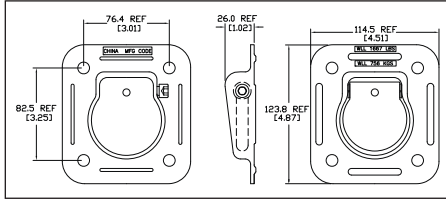

45° Ring Pull Angle Working Load Limit: 1,670 lbs./756 kgs.
Weight: 1.26 lbs./0.57 kgs.

PAN FITTING WITH RING ONLY



32210

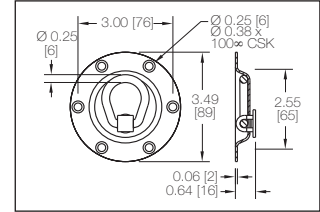

0° Ring Vertical Working Load Limit: 735 lbs./335 kgs.
45° Ring Pull Angle Working Load Limit: 735 lbs./335 kgs.
Weight: 0.28 lbs./0.13 kgs.

PAN FITTING WITH D-RING AND BLACK COLLAR



7190

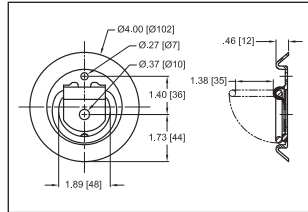

Working Load Limit: 200 lbs./95 kgs.





WARNING: Break strength ratings are provided for these items. Application specific factors of safety should be used to ensure end products achieve the required design specifications.

12 JAW FITTING WITH ROUND RING



32326

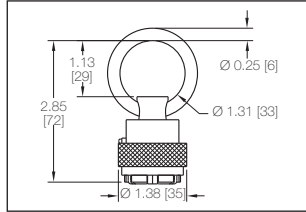

0° Vertical Breaking Strength: 5,475 lbs./2485 kgs.
90° Pull Angle Breaking Strength: 2,300 lbs./1045 kgs.
Weight: 0.29 lbs./0.13 kgs.

12 JAW FITTING WITH DELTA RING



32343

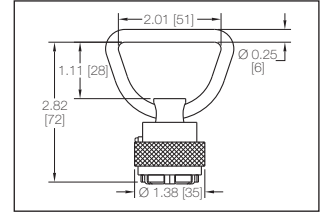

0° Vertical Breaking Strength: 5,475 lbs./2485 kgs.
90° Pull Angle Breaking Strength: 2,300 lbs./1045 kgs.
Weight: 0.31 lbs./0.14 kgs.

12 JAW CHAIR LEG STUD FITTING



32334

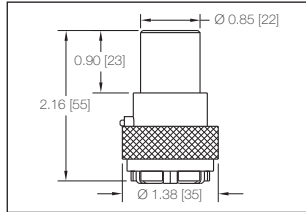

90° Pull Angle Breaking Strength: 2,300 lbs./1045 kgs.
Weight: 0.23 lbs./0.10 kgs.

12 JAW CHAIR LEG STUD FITTING WITH HOLE



32336 – MS22034-2

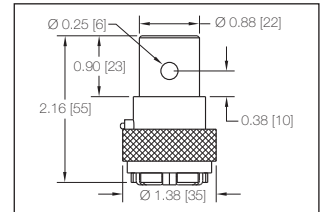

0° Vertical Breaking Strength: 5,475 lbs./2485 kgs.
90° Pull Angle Breaking Strength: 2,300 lbs./1045 kgs.
Weight: 0.23 lbs./0.10 kgs.

12 JAW CHAIR LEG STUD FITTING WITH HOLE



32367 – MS22034-4

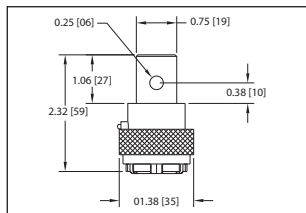

0° Vertical Breaking Strength: 5,475 lbs./2485 kgs.
90° Pull Angle Breaking Strength: 2,300 lbs./1045 kgs.
Weight: 0.24 lbs./0.11 kgs.

12 JAW FITTING WITH THREADED STUD



33115

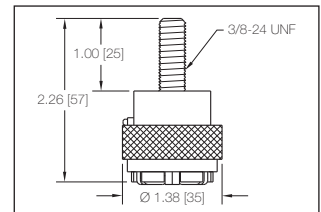

0° Vertical Breaking Strength: 5,475 lbs./2485 kgs.
90° Pull Angle Breaking Strength: 2,300 lbs./1045 kgs.
Weight: 0.22 lbs./0.10 kgs.

12 JAW CHAIR LEG STUD FITTING WITH HOLE



32340 – MS22034-1

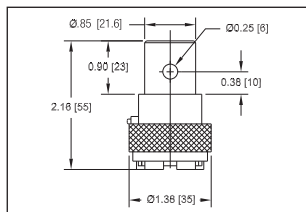

0° Vertical Breaking Strength: 5,475 lbs./2485 kgs.
90° Pull Angle Breaking Strength: 2,300 lbs./1045 kgs.
Weight: 0.23 lbs./0.10 kgs.

12 JAW FITTING WITH THREADED STUD



33116

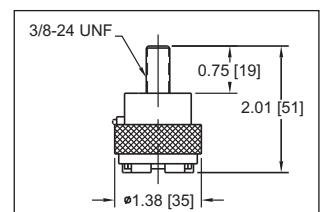

0° Vertical Breaking Strength: 5,475 lbs./2485 kgs.
90° Pull Angle Breaking Strength: 2,300 lbs./1045 kgs.
Weight: 0.21 lbs./0.09 kgs.



SEE WARNINGS ON PAGE 21 • VOIR LES AVERTISSEMENTS EN PAGE 22 • VÉASE LAS ADVERTENCIAS EN LA PÁGINA 23

1" STRAP END MOUNTING PLATE



34109-5

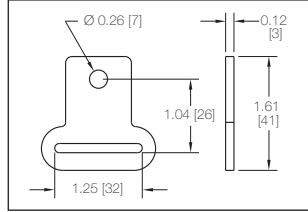

Working Load Limit: 335 lbs./155 kgs.
Weight: 0.05 lbs./0.03 kgs.

Code: 94

1" STRAP END MOUNTING PLATE



34109-6

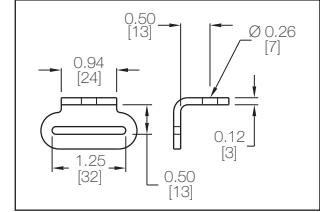

Working Load Limit: 250 lbs./115 kgs.
Weight: 0.06 lbs./0.03 kgs.

Code: 95

2" CIRCULAR RING



34035-6

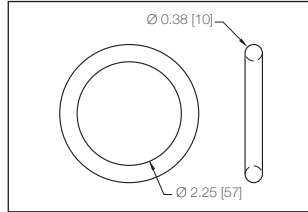

Working Load Limit: 3,335 lbs./1515 kgs.
Weight: 0.26 lbs./0.12 kgs.

Code: 93

CLUSTER HOOK RTJ



FE8171-1

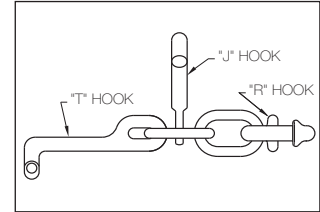

Working Load Limit: 3,900 lbs./1770 kgs.
Weight: 2.22 lbs./1.01 kgs.

Code: 19

R-Hook (GM & Chrysler),
T-Hook (Ford), J-Hook (Import)

PLATE TRAILER HOOK



FE8427-1

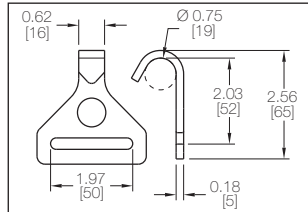

Working Load Limit: 735 lbs./335 kgs.
Weight: 0.18 lbs./0.08 kgs.

Code: 35

ROLL-OFF CONTAINER HOOK



9026

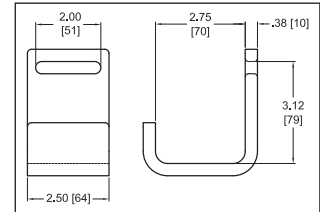

Working Load Limit: 5,400 lbs./2450 kgs.
Weight: 2.06 lbs./0.94 kgs.

Code: 06

2" WEBBING ADJUSTER



1105

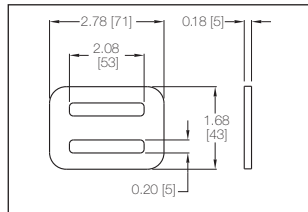

Working Load Limit contingent upon webbing used.
Weight: 0.21 lbs./0.09 kgs.

AUTO TIE-DOWN HOOK



3703

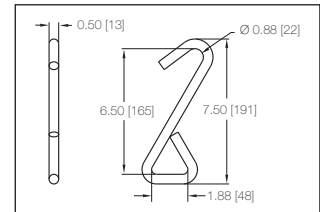

Working Load Limit: 1,667 lbs./760 kgs.
Weight: 0.79 lbs./0.36 kgs.

