

Matching your pressure washer with the right nozzles

Understanding the codes

EX : Nozzle JB-QMEG1504 and/or JB-1/4MEG1504



JB
(MSG code)

QMEG
(Quick coupler)

15
(Angle)

04
(Nozzle orifice)



JB
(MSG code))

1/4MEG
(Quick coupler)

15
(Angle)

04
(Nozzle orifice)

The color of the nozzle indicates the washing angle

Red = 0°

Yellow = 15°

Green = 25°

White = 40°

Black = Detergent

Nozzle chart

Choose your nozzle according to the pressure and flow of your pressure washer

Orifice	Pressure psi							
	500	1000	1500	2000	2500	3000	4000	5000
01	0.4	0.5	0.6	0.7	0.8	0.9	1.0	1.1
01.5	0.5	0.8	0.9	1.1	1.2	1.3	1.5	1.7
02	0.7	1.0	1.2	1.4	1.6	1.7	2.0	2.6
03	1.0	1.5	1.8	2.1	2.4	2.6	3.0	3.4
03.5	1.2	1.8	2.1	2.5	2.8	3.0	3.5	3.9
04	1.4	2.0	2.5	2.8	3.2	3.5	4.0	4.5
04.5	1.6	2.3	2.8	3.2	3.6	3.9	4.5	5.0
05	1.8	2.5	3.1	3.5	4.0	4.3	5.0	5.6
05.5	1.9	2.8	3.4	3.9	4.3	4.8	5.5	6.2
06	2.1	3.0	3.7	4.2	4.7	5.2	6.0	6.7
06.5	2.3	3.3	4.0	4.6	5.1	5.6	6.5	7.3
07	2.5	3.5	4.3	4.9	5.5	6.1	7.0	7.8
07.5	2.7	3.8	4.6	5.3	5.9	6.5	7.5	8.4
08	2.8	4.0	4.9	5.7	6.3	6.9	8.0	9.0
09	3.2	4.5	5.5	6.4	7.1	7.8	9.0	10.1
10	3.5	5.0	6.1	7.1	7.9	8.7	10.0	11.2
12	4.3	6.0	7.3	8.5	9.5	10.4	12.0	13.4
15	5.3	7.5	9.2	10.6	11.8	13.0	15.0	16.8
20	7.1	10.0	12.3	14.2	15.9	17.4	20.1	20.2
30	10.6	15.0	18.3	21.1	23.7	25.9	30.0	30.3

Nozzles

Accessories

Cleaning nozzles (1/4MEG)

1/4MEG threaded nozzles, 1/4" MNPT, stainless steel, max. pressure of 4000 psi (part # in light print).



Orifice 02 to 09 in 0°, 15°, 25°, 40°
Any orifice in 65° & orifices 10 and larger :
1/8MEG, 1/8MNPT

Accessories

Cleaning nozzles (QMEG)

QMEG color coded nozzle, on 1/4" quick disconnect plug, stainless steel, max. pressure of 4000 psi (part # in bold).



Orifice 02 to 09 in 0°, 15°, 25°, 40°

Orifice	0° Red	15° Yellow	25° Green	40° White	65°
02	JB-1/4MEG0002 JB-QMEG0002	JB-1/4MEG1502 JB-QMEG1502	JB-1/4MEG2502 JB-QMEG2502	JB-1/4MEG4002 JB-QMEG4002	JB-1/4MEG6502 N/D
03	JB-1/4MEG0003 JB-QMEG0003	JB-1/4MEG1503 JB-QMEG1503	JB-1/4MEG2503 JB-QMEG2503	JB-1/4MEG4003 JB-QMEG4003	JB-1/4MEG6503 N/D
03.5	JB-1/4MEG00035 JB-QMEG00035	JB-1/4MEG15035 JB-QMEG15035	JB-1/4MEG25035 JB-QMEG25035	JB-1/4MEG40035 JB-QMEG40035	N/D N/D
04	JB-1/4MEG0004 JB-QMEG0004	JB-1/4MEG1504 JB-QMEG1504	JB-1/4MEG2504 JB-QMEG2504	JB-1/4MEG4004 JB-QMEG4004	JB-1/4MEG6504 N/D
04.5	JB-1/4MEG00045 JB-QMEG00045	JB-1/4MEG15045 JB-QMEG15045	JB-1/4MEG25045 JB-QMEG25045	JB-1/4MEG40045 JB-QMEG40045	N/D N/D
05	JB-1/4MEG0005 JB-QMEG0005	JB-1/4MEG1505 JB-QMEG1505	JB-1/4MEG2505 JB-QMEG2505	JB-1/4MEG4005 JB-QMEG4005	JB-1/4MEG6505 N/D
05.5	JB-1/4MEG00055 JB-QMEG00055	JB-1/4MEG15055 JB-QMEG15055	JB-1/4MEG25055 JB-QMEG25055	JB-1/4MEG40055 JB-QMEG40055	JB-1/4MEG65055 N/D
06	JB-1/4MEG0006 JB-QMEG0006	JB-1/4MEG1506 JB-QMEG1506	JB-1/4MEG2506 JB-QMEG2506	JB-1/4MEG4006 JB-QMEG4006	JB-1/4MEG6506 N/D
06.5	JB-1/4MEG00065 JB-QMEG00065	JB-1/4MEG15065 JB-QMEG15065	JB-1/4MEG25065 JB-QMEG25065	JB-1/4MEG40065 JB-QMEG40065	N/D N/D
07	JB-1/4MEG0007 JB-QMEG0007	JB-1/4MEG1507 JB-QMEG1507	JB-1/4MEG2507 JB-QMEG2507	JB-1/4MEG4007 JB-QMEG4007	JB-1/4MEG6507 N/D
07.5	JB-1/4MEG00075 JB-QMEG00075	JB-1/4MEG15075 JB-QMEG15075	JB-1/4MEG25075 JB-QMEG25075	JB-1/4MEG40075 JB-QMEG40075	N/D N/D
08	JB-1/4MEG0008 JB-QMEG0008	JB-1/4MEG1508 JB-QMEG1508	JB-1/4MEG2508 JB-QMEG2508	JB-1/4MEG4008 JB-QMEG4008	JB-1/4MEG6508 N/D
09	JB-1/4MEG0009 JB-QMEG0009	JB-1/4MEG1509 JB-QMEG1509	JB-1/4MEG2509 JB-QMEG2509	JB-1/4MEG4009 JB-QMEG4009	JB-1/4MEG6509 N/D

Accessories

Nozzles kit

Nozzles kit including 3 QMEG nozzles (15°, 25° & 40°) and 1 QMEG soap nozzle.



- MS-QMEGKIT035..... Orifice 03.5
- MS-QMEGKIT040..... Orifice 04.0
- MS-QMEGKIT045..... Orifice 04.5
- MS-QMEGKIT050..... Orifice 05.0
- MS-QMEGKIT055..... Orifice 05.5
- MS-QMEGKIT065..... Orifice 06.5
- MS-QMEGKIT080..... Orifice 08.0

Accessories

Nozzle mounting bracket

Kit includes bracket and nozzle grommets

- MS-QCKIT035..... Orifice 03.5
- MS-QCKIT040..... Orifice 04.0
- MS-QCKIT045..... Orifice 04.5
- MS-QCKIT050..... Orifice 05.0
- MS-QCKIT055..... Orifice 05.5

Accessories

Nozzles for detergent

- JB-1/4U6540..... 1/4" MNPT, 65°, orifice 40, brass
- JB-QMEG6540BR 1/4" male, 65°, orifice 40, brass + plastic

All operators should read the owner's manual outlining warranty safety and maintenance recommendations before attempting to operate any machine. Please read and pay attention to all safety recommendations contained in the manual and those labeled on the machine.

We Simplify Your Work!

Nozzles

Accessories

Rotating nozzle kit « PA », under spring tension

- robust brass body with plastic cover
- nozzle and ceramic seat with high impact resistance
- can be used in all positions
- 20° nozzle angle
- maximum temperature of 100°C – 212°F
- 1/4" FNPT inlet
- weight of 410 g

Pressure : 1150 psi minimum - 3650 psi maximum

N°	Orifice	Color coding
AU-TNS3630.....	3.0.....	White
AU-TNS3635.....	3.5.....	Brown
AU-TNS3640.....	4.0.....	Yellow
AU-TNS3645.....	4.5.....	Blue
AU-TNS3650.....	5.0.....	Purple
AU-TNS3655.....	5.5.....	Red



Pressure : 2600 psi minimum - 5100 psi maximum

N°	Orifice	Color coding
AU-TNS5135.....	3.5.....	Brown
AU-TNS5140.....	4.0.....	Yellow
AU-TNS5145.....	4.5.....	Blue
AU-TNS5150.....	5.0.....	Purple
AU-TNS5155.....	5.5.....	Red
AU-TNS5165.....	6.5.....	Light blue
AU-TNS5180.....	8.0.....	Silver

Accessories

Giant Heavy duty rotating nozzles

- robust brass body with plastic cover
- nozzle and ceramic seat
- starting recommended by pointing to the ground
- 20° nozzle angle
- maximum temperature of 100°C – 212°F
- 1/4" FNPT inlet
- Weight of 740 g



Pressure : 5100 psi maximum

N°	Orifice
AU-GI220635N.....	3.5
AU-GI22062.....	4.0
AU-GI22060N.....	4.5
AU-GI22061N.....	5.5
AU-GI22063N.....	7.0
AU-GI22068A.....	8.0
AU-GI22069N.....	9.0
AU-GI220610N.....	10.0
AU-GI22064N.....	12.0

Accessories

Adjustable nozzles

- 3000 psi maximum / 300°F maximum
- pressure variable angle 0° to 15°
- detergent variable angle 0° to 80°
- HI-LOW type
- 1/4" FNPT inlet



N°	Orifice
AP-DUOREGW H35.....	3.5
AP-DUOREGBL4.....	4.0
AP-DUOREGBR45.....	4.5
AP-DUOREGGR5.....	5.0
AP-DUOREGLB55.....	5.5

Accessories

Grommet

used to hold QMEG nozzles in place on frame



JA-77package of 5

Accessories

Rotating nozzle filters

- 100 mesh filter
- 8 gpm
- 5000 psi maximum
- 200°F maximum
- 1/4" MNPT outlet



No	Material	Inlet
GP-100560.....	Brass & 416 stainless steel.....	1/4" Q-C
GP-100579.....	Brass.....	1/4" FNPT

Accessories

Anti-splash protector

polyethylene anti-splash protector



AU-PROTJETC

Accessories

Rotative flat surface cleaner

- 12" model
- Attached to a wand, a telescopic boom or directly to a gun
- 4000 psi maximum
- 8 gpm maximum
- 180°F maximum
- 2 #2502 tips
- 1/4" quick disconnect plug inlet



AU-SC12PM

Accessories

Linear flat surface cleaner

- Aluminum boom mounted on wheels
- 1/4" quick disconnect plug
- AU-WB123G 12" width including 3 tips, Max. flow rate 3000 psi, 3.5 gpm
- AU-WB164G 16" width including 4 tips, Max. flow rate 3000 psi, 4.3 gpm



AU-WB123G3 nozzles
 AU-WB164G4 nozzles

Accessories

Rotative flat surface cleaner

- 16" model
- Nylon brush
- Polyethylene drum
- 4000 psi maximum
- 8 gpm maximum
- 180°F maximum
- 2 #25025 tips
- 3/8" quick disconnect plug inlet



AU-SC16NB

Accessories

Rotative flat surface cleaner

- 20" model on 4 wheels
- Stainless steel drum
- 4000 psi maximum
- 8 gpm maximum
- 180°F maximum
- 2 #2502 tips
- 3/8" quick disconnect plug inlet



AU-SC21SS

All operators should read the owner's manual outlining warranty safety and maintenance recommendations before attempting to operate any machine. Please read and pay attention to all safety recommendations contained in the manual and those labeled on the machine.

We Simplify Your Work!

Telescopic booms

Accessories

3-section telescopic booms

- 1st section in fiber glass, 2nd and 3rd sections in aluminum
- 4000 psi
- 6 gpm maximum
- 200°F maximum
- 3/8" quick disconnect plug inlet
- 1/4" quick disconnect coupler at outlet



MS-BOOM12F6'6" to 12' boom , 6 lb
MS-BOOM18F6'6" to 18' boom, 7.5 lb

MS-BOOM24F8'6" to 24' boom, 8.5 lb
MS-BOOM24F4HD ..6'6" to 24' 4-sections boom, 16 lb

Accessories

Gutter cleaner



MS-BOOMGC

Accessories

Harness/belt for telescopic boom



MS-BOOMBK

Accessories

Hydrostatic test kit

- 3000 psi maximum
- 1 ball-valve to "trap" the pressure
- 1 ball-valve to depressurize and drain
- Pressure gauge
- 10' x 3/8" hose
- 3/8" quick disconnect plug and a 3/8" twist connect plug at inlet
- Installation at pressure washer hose outlet

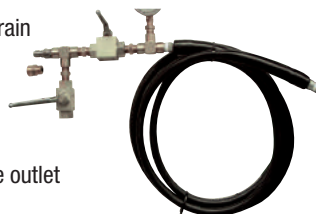

MS-PTKIT

Accessories

Mud pump

- 4000 psi maximum
- Flow rate : multiply 1 to 10, 30 to 50 gpm
- 10' x 1/4" x 3000 psi hose with 1/4" quick disconnect plug and 1/4" twist connect
- PVC 15' x 1-1/2" return hose
- Injection nozzle # 6.0 (interchangeable)
- Connection to the quick coupler at the gun lance outlet



MS-PB1

Accessories

Foamer kit

Foamer kit with 1 liter integrated tank. Includes a twist coupler for 2-section wand. For 1-section wand, 3 quick-couplers are included, one for the foamer, one for the wand and one for the gun outlet.



PN00009VSFor 1-section wand
 PN00008VSFor 2-section wand

Accessories

Back pack foamer

- 15 litre back pack tank
- 1000 to 3000 psi
- covers 3000 sq/ft in 15 minutes
- perfect proportion
- may be used with hot water, maximum 180°F



MS-FKI13L

Accessories

Foamer kit

Foamer kit with 2- liter integrated tank. Includes 3 quick-couplers, one for the foamer, one for the wand and one for the gun outlet.



PN00004VS

Accessories

High capacity wet sandblasting kit

- 4000 psi maximum
- 3 to 10 gpm maximum
- 15' of 3/4" sand hose
- Quick disconnect plug included
- 1/4MEG 0° spray tip included, specify washer capacity



Note : Complete with a 0° 1/4 MEG nozzle compatible with your pressure washer capacity.

MS-HDSB310

Accessories

Wet sandblast kit

- 3600 psi maximum
- 2 to 5 gpm maximum
- 15' of 1/2" sand hose
- Quick disconnect plug included



MS-SB150B..... equivalent to 4.0 and 4.5 nozzles
 MS-SB160B..... éequivalent to 5.0 and 5.5 nozzles

Accessories

Sand tank

- Mobile polyethylene sand tank
- Capacity of 15 US gal.
- Compact cart on 10" inflated wheels
- Ball-valve control for sand and air
- 1/2" and 3/4" outlets



MS-SB15G

All operators should read the owner's manual outlining warranty safety and maintenance recommendations before attempting to operate any machine. Please read and pay attention to all safety recommendations contained in the manual and those labeled on the machine.

We Simplify Your Work!

Car Wash

Accessories

Mat clamp



MA-MATCA10

Accessories

Car wash brush

- 10" x 2-1/2"



MA-FBR172.....soft nylon bristle

AU-CWBRUSHHOG.....hog bristle

Accessories

Spare swivel boom

- 3000 psi maximum
- 160°F maximum
- 5'6" length
- Without hose and gun



MS-CWBOOM60"

MS-CWBOOM890"

Accessories

Coin operated industrial vacuum

- Stainless steel frame
- Dual motor of 1.6 HP x 120 V, 20 A
- 15' hose with aluminum nozzle
- Electronic mechanism accepting 25¢, 1\$, 2\$ or tokens



MA-VBOS2

Accessories

Air driven chemical pump kit

- Chemical resistant pump
- air regulator and pressure gauge
- air filter
- 6' suction hose
- 35' hose, gun and adjustable nozzle
- pump kit can feed up to 3 guns
- Option : Additional hose kit including 35' hose, gun and storage bracket.

Available upon request.



No

Max. Pressure
Max. Flow Rate
Pump's Manufacturer
Pump's Diaphragms
Pump's Valves
Max. Air Consumption, ft³/min
Pump's Rating 1

60 psi

3.5 gpm

FloJet

Viton

Viton

1.5

000-3000 hours

MS-APPLIC02

100 psi

3.4 gpm

Price

Teflon

Teflon

6

9 000 hours and +

Accessories

Detergent

- Concentrated soap for pressure cleaner
- 1 serving of soap for 30 portions of water.



MS-NET 4 liter

MS-NET6 Box of 6 x 4 liter

Accessories

Biodegradable degreaser

- Degrease concentrated for pressure cleaner
- 1 serving of soap for 3 portions of water.



MS-SOLV 4 litre

MS-SOLV6 Box of 6 x 4 liter

Accessories

Auto-propelling drain cleaning nozzles

	Inlet	Rotative	Orifice x psi	Front hole	Back holes	Price
AU-122375000	1/8" FPT	no	4.5 x 4200	0	3	\$30.63
AU-122370170	1/8" FPT	no	5.5 x 4200	1	3	\$30.63
AU-121370170	1/4" FPT	no	4.5 x 4200	1	3	\$30.63
AU-121375175	1/4" FPT	no	5.5 x 4200	1	3	\$30.63
AU-121480180	1/4" FPT	no	7.5 x 4200	1	4	\$30.63
AU-123065188	3/8" FPT	no	4.0 x 4200	1	3	\$59.59
AU-123065187	3/8" FPT	no	5.5 x 4200	1	3	\$59.59
AU-123065189	3/8" FPT	no	8.5 x 4200	1	4	\$59.59
AU-200049650	1/8" FPT	yes	5.5 x 3000	0	3	\$59.59
AU-200049600	1/4" FPT	yes	5.5 x 3000	0	3	\$59.59
AU-200049610	1/4" FPT	yes	8.0 x 3000	0	3	\$59.59



Accessories

1/4" drain cleaning hose

- 3000 psi maximum
- 212°F maximum
- black hose
- 3/8" MNPT x 1/8" MNPT adaptators
- 1-1/4" bend radius



FH-H1450R7.....	50 feet
FH-H14100R7.....	100 feet
FH-H14150R7.....	150 feet
FH-H14200R7.....	200 feet
FH-H14250R7.....	250 feet

Accessories

Drain hose and manual reel



Drain hose kit

- PN00149VS 100' hose, gun, quick disconnect plug
- PN00156VS 200' hose, gun, quick disconnect plug

Reel and support kit

- PN00150VS reel 100 ft capacity, 3000 psi, cold water, bracket and carrying handle
- PN00151VS reel 200 ft capacity, 4000 psi, cold or hot water, bracket and carrying handle

Accessories

Foot valve

- 3000 psi maximum
- 8 gpm
- 3/8" FNPT inlet
- 1/4" FNPT outlet

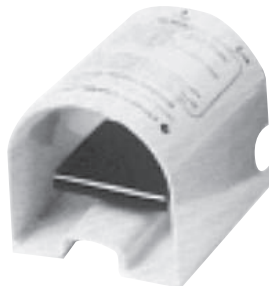

AU-999000012.....	Accessories
AU-200810491	Repair kit

Accessories

Foot valve

- 5000 psi maximum
- 12 gpm
- 3/8" FNPT inlet
- 1/4" FNPT outlet



AU-999002305	
AU-202300490	Repair kit

All operators should read the owner's manual outlining warranty safety and maintenance recommendations before attempting to operate any machine. Please read and pay attention to all safety recommendations contained in the manual and those labeled on the machine.

We Simplify Your Work!