

ELECTRO-MECHANICAL, 2 BLADE TERMINAL

ELECTRO-MECHANICAL

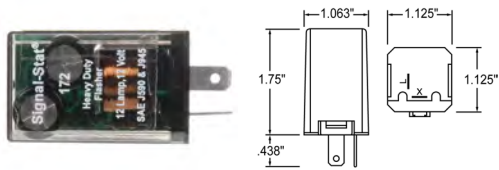

PART# 172, 182, 282

- Certification for 16 bulb capacity for hazard warning
- Flashes up to eight 32 CP bulbs per side, plus pilot bulb
- 35 amp capacity at 12VDC
- Low profile, only 1-1/4" height above terminals



PART# 262

- Flashes at a rate of 60 to 120 FPM, with first flash less than 1.5 seconds after startup
- Bi-polar flasher functions continuously at 13V for 36 hours with 10-32 CP lamps, 20 AMP max
- Uses standard 1/4" male blade terminals
- Features double coil relay with electronic components
- Replaces Truck-Lite 97202/03/04 series

Part Number	Strobe Frequency Min_FPM	Strobe Frequency Max_FPM	Plug Side Two	Volts	Standards Met
172	70	120	Lamp Connection	12	J590, J945
182	70	120	Lamp Connection	12	J590, J945, J1054
262	60	120	Lamp Connection	12	J590, J945
282	70	120	Lamp Connection	12	J590, J945, J1054

ELECTRO-MECHANICAL, 3 BLADE TERMINAL

ELECTRO-MECHANICAL

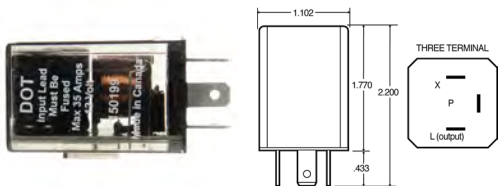

- Flashes at a rate of 70 to 120 FPM, with first flash less than 1.3 seconds after startup
- Functions at 13v for 36 continuous hours with 16-32 cp lamps at 35 amp max (#182 and 183), 20-32 cp lamps at 45 amp max (#282 and 283), 10-32 cp lamps alternating at 25 amp max per side (#286)
- Five available versions include 16-lamp with 2- or 3- terminal, 20-lamp with 2- or 3- terminal and alternating 10-lamp with 3- terminal
- Features ISO relay with electronic control circuits
- Replaces Truck-Lite 97205 & 97209



Part Number	Strobe Frequency Min_FPM	Strobe Frequency Max_FPM	Volts	Standards Met
173	70	120	12	J590, J945, J1054
183	70	120	12	J590, J945, J1054
283	70	120	12	J590, J945, J1054
286	70	120	12	J590, J945, J1054

ELECTRO-MECHANICAL, 3 BLADE TERMINAL



- 2-4 lamp load capability with outage indication
- 8 for hazard warning
- Third prong used for ground function

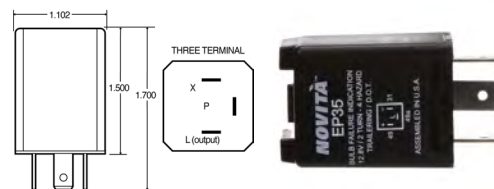

Part Number	Strobe Frequency Min_FPM	Strobe Frequency Max_FPM	Volts	Standards Met
264	70	100	12	J590 J945
266	70	100	12	J590 J945

ELECTRO-MECHANICAL

ELECTRO-MECHANICAL, 3 BLADE TERMINAL



- 2-4 lamp load capability with outage indication
- 8 for hazard warning
- Third prong used for ground function



Part Number	Strobe Frequency Min_FPM	Strobe Frequency Max_FPM	Volts	Standards Met
263	60	120	12	J590 J945
2634	60	120	24	J590 J945

ELECTRO-MECHANICAL

ELECTRO-MECHANICAL, 2 BLADE TERMINAL, 2 SCREW



PART# 242

- Certification for 16 bulb capacity for hazard warning
- Flashes up to eight 32 CP bulbs per side, plus pilot bulb
- 35 amp capacity at 12VDC
- Low profile, only 1-1/4" height above terminals

PART# 243

- Flashes up to five 32 CP bulbs per side, plus pilot bulb
- Flashes ten 32 CP bulbs for hazard warning
- 25 amp capacity @ 12VDC
- Low profile, only 1-1/4" height above terminals

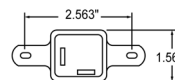
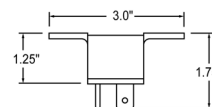

Part Number	Strobe Frequency Min_FPM	Strobe Frequency Max_FPM	Volts	Standards Met
242	60	120	12	J590, J945t
243	60	120	12	J590, J945t

ELECTRO-MECHANICAL

ELECTRO-MECHANICAL, 2 SCREW, HARDWIRED

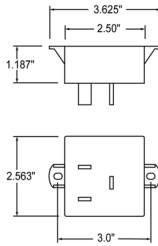

- Mack 47M019301P2 (SS# 250)
- Conforms to DOT and SAE specifications
- Test proven to exceed 1.5 million cycles of continuous operation at maximum capacity without failure
- Certified for ten bulb load hazard warning, five bulb load turn signal, plus pilot
- Polycarbonate housing and brass terminals for superior corrosion resistance and better conductivity
- For school buses or emergency vehicles
- Flashes two 75 watt sealed beams per circuit



Part Number	Strobe Frequency Min_FPM	Strobe Frequency Max_FPM	Plug Side Two	Volts	Standards Met
250	60	90	2 Spade Terminal, Ring Terminal	12	J590,J945,J1054
256	60	90	3 Spade Terminal Ring, Terminal	12	J590,J945,J1054
2584	60	120	Spade Terminal Ring, Terminal	24	J590,J945,J1054

ELECTRO-MECHANICAL, HARDWIRED

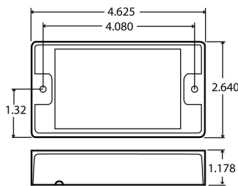

- Hardwired allowing alternating flashing of up to 20 LED lamps (10 lamps per side)
- Features color coded wires, epoxy-sealed circuitry and installation instructions
- Operates on 12V or 24V systems
- Maximum 5 amp load
- Flashes 3 times per 1/2 second



Part Number	Strobe Frequency Max_FPM	Plug Side Two	Volts
97235	360	Stripped End	12 24
97251	480	Fit 'N Forget S.S./ Straight Female PL-2	12 24

ELECTRO-MECHANICAL, 2 SCREW, HARDWIRED

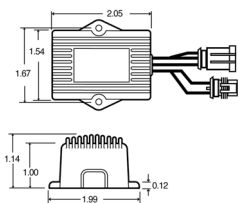

- Designed for use in automotive and heavy duty applications
- Creates a strobe flash on an LED lamp
- Hardwired design eliminates pin corrosion
- Features coded wires and epoxy sealed circuitry for durability and long term use
- Designed to operate in temperature range -40°C to 85°C
- Full operation voltage range 12V to 24V
- Maximum current 7 amps
- Flashes 3 times per 1/2 second
- Uses 2 modules as alternating LED strobe without cutting or splicing



truck-lite.com | (800) 888-7095

Part Number	Strobe Frequency Max_FPM	Plug Side Two	Volts
97253	360	Fit 'N Forget S.S./ 3 Position Connector 282105	12 24

ELECTRO-MECHANICAL

ELECTRO-MECHANICAL

ELECTRO-MECHANICAL

SOLID-STATE, HARDWIRED



- This solid-state flasher operates from 1 milliamp up to 6 amps - allowing the use of two incandescent signal lamps with LED S/T/T lamps
- Solid-state timing circuitry provides reliability
- Flashes at a rate of 90 FPM
- Size: 1-1/8" W x 1-5/8" H

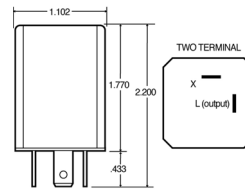

Part Number	Strobe Frequency Max_FPM	Plug Side Two	Volts	Standards Met
285	90	Spade Terminal Fork Terminal	12	J590, J945

SOLID-STATE

SOLID-STATE, 2 SCREW, HARDWIRED



- For interior lighting in trailers, package car and body vans
- Hardwired design and solid state operation
- Features ABS housing, coded wires, epoxy-sealed circuitry and installation instructions
- Designed to operate in temperature range 40°C to 85°
- Full operation voltage range 12V to 24V
- Solid-state operation
- Timing module can be configured for 20, 30 or 60 minute intervals, depending upon wiring
- Maximum current 7 amps
- Includes 3 minute time remaining feature

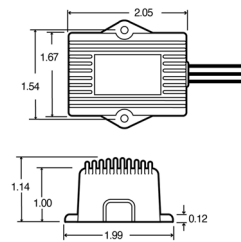

Part Number	Plug Side Two	Volts
97254	Stripped End	12 24

SOLID-STATE

HEAVY-DUTY SOLID-STATE, 2 SCREW, HARDWIRED



- Rated for 42 amp load
- For use on double and triple trailer combination, sanitation vehicles, delivery and courier vehicles, heavy haulers and emergency vehicles
- Operates LED lamps as well as incandescent lamps
- Flasher unit includes 11" of wiring for remote mounting

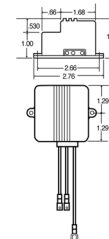

Part Number	Strobe Frequency Min_FPM	Strobe Frequency Max_FPM	Plug Side Two	Volts	Standards Met
270	80	100	2 Spade Terminal Fork Terminal	12	J590, J945, J1054
270Y1014	80	100	Spade Terminal Fork Terminal	24	J590, J945, J1054
275	80	100	3 Spade Terminal Fork Terminal	12	J590, J945, J105
276	81	99	3 Spade Terminal Fork Terminal	12	J590, J945, J1054

SOLID-STATE

HEAVY-DUTY SOLID-STATE, 2 SCREW, HARDWIRED

SOLID-STATE

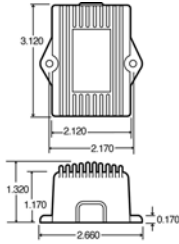

- ULTRA FLASH II
- Solid-state electronics are sealed in polyurethane for moisture and corrosion protection
- Surface mounts with two 1/2"-6 pan head screws at 2.12" centers or with two 4" cable ties (both included)
- Protects against short circuit overloads with a self-resetting feature
- Works with LED or incandescent lamps on 12V or 24V electrical systems
- 97231, 97232 and 97233 rated for loads below 25 amps or 12-32 cp bulbs
- 97201 rated for loads below 17 amps per channel or 8-32/3 cp bulbs
- Optional remote wiring requires 12" jumper wire, 94954
- 97231, 97232 and 97333 feature folding bi-polar plug with 11" leads for reverse polarity operation
- 97201 features three 1/4" tabs and one 1/4" ring with heat shrink tubing and 12" leads
- 97201 used for wig/wag system
- For interior/cab use only
- Do not expose to moisture or liquid



Part Number	Strobe Frequency Max_FPM	Plug Side Two	Volts	Standards Met
97201	90	Spade Terminal Ring Terminal	12 24	J590, J1054
97231	90	Bi-Polar Plug Ring Terminal	12 24	J590, J1054
97232	90	Bi-Polar Plug Ring Terminal	12 24	J590, J1054
97233	90	Bi-Polar Plug Ring Terminal	12 24	J590, J1054

HEAVY-DUTY SOLID-STATE, 3 SCREW, HARDWIRED

SOLID-STATE

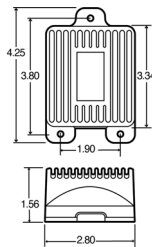

- ULTRA FLASH II High Current
- Solid-state electronics are totally encapsulated in polyurethane for moisture and corrosion protection
- Designed to protect against short circuit overloads with a self-resetting feature
- 97270 and 97271 rated for loads below 40 amps at 12.8V (20,32 cp) or below 20 amps at 25.6V
- 97272 rated for loads below 25 amps at 12.8V per channel or below 12.5 amps at 25.6V per channel
- Designed to work with 12V or 24V electrical systems and operated from 9V to 32V
- 97270 and 97271 feature 12" leads with two 1/4" spade terminals and one 1/4" ring with heat shrink tubing
- 97272 features 12" leads with three 1/4" spade terminals and one 1/4" ring with heat sink tubing
- Used for both LED or incandescent lamps
- Do not expose to moisture or liquid



Part Number	Audible	Strobe Frequency Max_FPM	Plug Side Two	Voltage	Standards Met
97270	Non-Audible	90	Spade Terminal/ Ring Terminal	12 24	J590, J945, J1054
97271	Audible	90	Spade Terminal/ Ring Terminal	12 24	J590, J945, J1054
97272	3-Spade Non-Audible	90	Spade Terminal/ Ring Terminal	12 24	J590, J945, J1054

HEAVY-DUTY SOLID-STATE, 5 BLADE TERMINAL

SOLID-STATE



- Maintains normal flash rate when used to flash LED lamps
- Simple installation using existing plug footprint
- Heavy-duty solid state circuitry
- Long lasting service life means lower maintenance costs
- Designed for use with low current LED lamps
- Non audible
- Compatible with trailer tow packages
- 5 pin configuration for turn and hazard flashing
- 5 amp maximum per output
- Conforms to DOT FMVSS 108, SAE J590 and J945

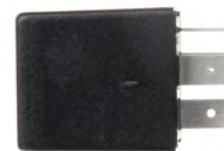
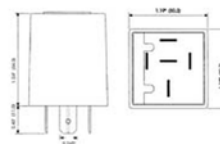

Part Number	Voltage_VLT	Standards Met
97283	12	J590, J945

THERMAL, 2 BLADE TERMINALS

THERMAL



- Heavy duty, longer life, variable load
- Flashes up to three 32 cp bulbs per side, plus pilot bulb (550 only)
- Flashes up to six 32 cp bulbs for hazard warning
- Aluminum housing

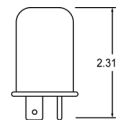

Part Number	Strobe Frequency Min_FPM	Strobe Frequency Max_FPM	Volts	Standards Met
536	60	120	12	J590b J945
550	60	120	12	J590b J945
552	60	120	12	J2068

THERMAL, HARDWIRED

THERMAL



- 6 amp capacity @ 12 VDC
- Includes spade terminals for ease of installation
- Brass housing for corrosion resistance
- Mounts via single screw
- 4" lead wires

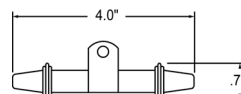

Part Number	Strobe Frequency Min_FPM	Strobe Frequency Max_FPM	Plug Side Two	Volts	Standards Met
245	60	120	Spade Terminal	12	J590, J945

UNIVERSAL

UNIVERSAL FLASHER CONNECTOR, 3 FEMALE BLADE TERMINALS



- Exclusive design accommodates 2 or 3 prong flashers
- Includes 15 amp blade type fuse
- Ring terminal on lead wire
- For use with 12V or 24V applications



Part Number	Plug Side Two	Volts
9187	Stripped End Ring Terminal	12 24

FLASHER CONNECTOR

FLASHER CONNECTOR, 3 FEMALE BLADE TERMINALS



- Includes 15 amp blade type fuse
- Ring terminal on lead wire
- 7" color coded wire leads
- Insulated 16 gauge wire leads
- For use with 12V or 24V applications



Part Number	Plug Side Two	Volts
9186	Stripped End/ Ring Terminal	12 24

DRL SYSTEM, HARDWIRED



- Features state-of-the-art electronics sealed in epoxy for protection
- Module installs easily using a three-wire design
- Relay-controlled output activates low beam headlamps at full intensity whenever the ignition is turned on
- Meets or exceeds CSA guidelines
- Do not expose to moisture, excessive engine compartment temperature or circuit overload
- Work with most Ford, GM and Dodge vehicles
- For use with positive switching headlamps only
- Not for use with positive ground vehicles

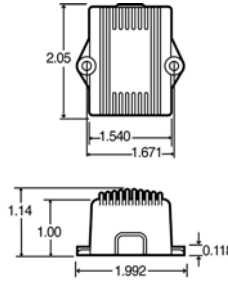

Part Number	Amps	Volts	Housing Material
97300	15	12	PC

DRL SYSTEM

DRL SYSTEM, HARDWIRED, BLUNT CUT



- Operates low beam headlamps at reduced intensity (75%) for prolonged lamp life
- Unit features 15-second “time-in” delay and tail/marker lamp activation
- Park brake disable feature locks out system when parking brake is engaged
- Electronics are sealed in epoxy for protection and are short-circuit protected
- Exceeds GM and Ford’s electrical, environmental, RFI and EMI specifications
- Meets or exceeds SAE, NHTSA and CSA guidelines

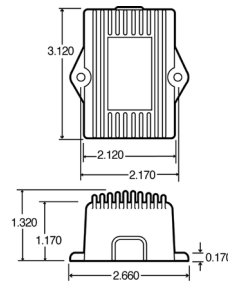

Part Number	Volts	Housing Material
97302	12	Steel

DRL SYSTEM