

PROMOTIONAL

BUSHINGS & HUBS

SHEAVES

SYNCHRONOUS DRIVES

COUPLINGS

BELTS

CROSS REFERENCES

MAL (A & 3L-4L V-BELTS)

This entire product series uses the "L" Bushing

1 GROOVE

Part No	Cross. Ref.	List Price \$	D.D		O.D.	Type	Dimensions*				Wt (lbs)
			(3L) Belts	A(4L) Belts			E	F	L	M	
MAL30	AK30H	19.06	2.46	2.8	3.05	1B	3/8	3/4	1-11/32	31/32	1.15
MAL32	AK32H	19.36	2.66	3.0	3.25	1B	3/8	3/4	1-11/32	31/32	1.30
MAL34	AK34H	19.64	2.86	3.2	3.45	1B	3/32	3/4	1-11/32	11/16	1.20
MAL37	AK39H	20.78	3.16	3.5	3.75	1B	3/32	3/4	1-11/32	11/16	1.50
MAL39	AK41H	21.06	3.36	3.7	3.95	1B	3/32	3/4	1-11/32	11/16	1.75
MAL42	AK44H	21.34	3.66	4.0	4.25	1B	3/32	3/4	1-11/32	11/16	2.05
MAL44	AK46H	21.62	3.86	4.2	4.45	1B	3/32	3/4	1-11/32	11/16	2.25
MAL47	AK49H	21.92	4.16	4.5	4.75	3W	3/32	3/4	1-11/32	11/16	2.10
MAL49	AK51H	22.20	4.36	4.7	4.95	3W	3/32	3/4	1-11/32	11/16	2.35
MAL52	AK54H	22.48	4.66	5.0	5.25	3W	3/32	3/4	1-11/32	11/16	2.65
MAL54	AK56H	22.80	4.86	5.2	5.45	3W	3/32	3/4	1-11/32	11/16	2.75
MAL57	AK59H	23.24	5.16	5.5	5.75	5A	3/32	3/4	1-11/32	11/16	2.60
MAL59	AK61H	23.72	5.36	5.7	5.95	5A	3/32	3/4	1-11/32	11/16	2.50
MAL62	AK64H	24.32	5.66	6.0	6.25	5A	3/32	3/4	1-11/32	11/16	2.60
MAL64	AK66H	25.08	5.86	6.2	6.45	5A	3/32	3/4	1-11/32	11/16	2.70
MAL67	AK69H	27.48	6.16	6.5	6.75	5A	3/32	3/4	1-11/32	11/16	2.85
MAL69	AK71H	28.96	6.36	6.7	6.95	5A	3/32	3/4	1-11/32	11/16	2.90
MAL72	AK74H	30.36	6.66	7.0	7.25	5A	3/32	3/4	1-11/32	11/16	3.10
MAL77	AK79H	33.08	7.16	7.5	7.75	5A	3/32	3/4	1-11/32	11/16	3.35
MAL82	AK84H	35.20	7.66	8.0	8.25	5A	1/8	3/4	1-11/32	23/32	3.85
MAL87	AK89H	37.92	8.16	8.5	8.75	5A	3/32	3/4	1-11/32	11/16	4.10
MAL92	AK94H	40.96	8.66	9.0	9.25	5A	3/32	3/4	1-11/32	11/16	4.40
MAL97	AK99H	43.52	9.16	9.5	9.75	5A	3/32	3/4	1-11/32	11/16	4.60
MAL102	AK104H	44.12	9.66	10.0	10.25	5A	3/32	3/4	1-11/32	11/16	4.90
MAL107	AK109H	46.36	10.16	10.5	10.75	5A	3/32	3/4	1-11/32	11/16	5.20
MAL112	AK114H	47.84	10.66	11.0	11.25	5A	3/32	3/4	1-11/32	11/32	5.55
MAL122	AK124H	52.28	11.66	12.0	12.25	5A	3/32	3/4	1-11/32	11/16	5.90
MAL132	AK134H	60.28	12.66	13.0	13.25	5A	3/32	3/4	1-11/32	11/16	6.55
MAL142	AK144H	67.72	13.66	14.0	14.25	5A	3/32	3/4	1-11/32	11/16	7.30
MAL152	AK154H	74.52	14.66	15.0	15.25	5A	3/32	3/4	1-11/32	11/16	9.80
MAL182	AK184H	88.00	17.66	18.0	18.25	5A	3/32	3/4	1-11/32	11/16	9.95

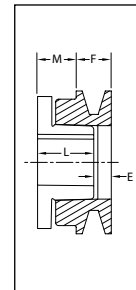

TYPE 1

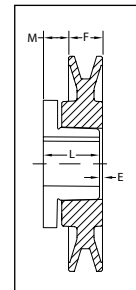

TYPE 3

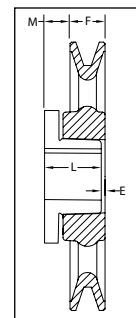

TYPE 5

P.D. for "A" (4L) Belts = O.D. P.D. for "3L" Belts = D.D.+0.25 = O.D.-0.34

* Dimensions to closest fraction

Legend: "E" and "M" dimensions may vary according to shaft tolerance.

With "L" bushing only reverse mounting is possible, see page 14 for installation instructions.

2MAL (A V-BELTS)

This entire product series uses the "L" Bushing

2 GROOVES

Part No	Cross. Ref.	List Price \$	D.D. "A" Belts	O.D.	Type	Dimensions*				Wt (lbs)
						E	F	L	M	
2MAL30	2AK30H	33.36	2.8	3.05	2B	1	1-3/8	1-11/32	31/32	1.70
2MAL32	2AK32H	37.48	3.0	3.25	2B	1	1-3/8	1-11/32	31/32	1.90
2MAL34	2AK34H	37.76	3.2	3.45	2B	23/32	1-3/8	1-11/32	11/16	1.90
2MAL37	2AK39H	38.56	3.5	3.75	2B	23/32	1-3/8	1-11/32	11/16	2.15
2MAL39	2AK41H	42.68	3.7	3.95	4B	3/32	1-3/8	1-11/32	1/16	2.30
2MAL42	2AK44H	44.16	4.0	4.25	4B	3/32	1-3/8	1-11/32	1/16	2.75
2MAL44	2AK46H	46.24	4.2	4.45	4W	3/32	1-3/8	1-11/32	1/16	2.85
2MAL47	2AK49H	47.12	4.5	4.75	4W	3/32	1-3/8	1-11/32	1/16	3.50
2MAL49	2AK51H	48.44	4.7	4.95	4W	3/32	1-3/8	1-11/32	1/16	3.70
2MAL52	2AK54H	50.52	5.0	5.25	4W	3/32	1-3/8	1-11/32	1/16	4.05
2MAL54	2AK56H	51.24	5.2	5.45	4W	3/32	1-3/8	1-11/32	1/16	4.20
2MAL57	2AK59H	51.68	5.5	5.75	6A	3/32	1-3/8	1-11/32	1/16	3.90
2MAL59	2AK61H	52.88	5.7	5.95	6A	3/32	1-3/8	1-11/32	1/16	4.05
2MAL62	2AK64H	55.76	6.0	6.25	6A	3/32	1-3/8	1-11/32	1/16	4.50
2MAL72	2AK74H	62.36	7.0	7.25	6A	3/32	1-3/8	1-11/32	1/16	5.70
2MAL82	2AK84H	69.20	8.0	8.25	6A	3/32	1-3/8	1-11/32	1/16	6.50
2MAL92	2AK94H	74.36	9.0	9.25	6A	3/32	1-3/8	1-11/32	1/16	7.80
2MAL102	2AK104H	77.92	10.0	10.25	6A	3/32	1-3/8	1-11/32	1/16	8.80
2MAL112	2AK114H	86.68	11.0	11.25	6A	3/32	1-3/8	1-11/32	1/16	9.50
2MAL122	2AK124H	91.40	12.0	12.25	6A	3/32	1-3/8	1-11/32	1/16	10.60
2MAL132	2AK134H	96.76	13.0	13.25	6A	3/32	1-3/8	1-11/32	1/16	11.90
2MAL142	2AK144H	102.36	14.0	14.25	6A	3/32	1-3/8	1-11/32	1/16	12.45
2MAL152	2AK154H	114.68	15.0	15.25	6A	3/32	1-3/8	1-11/32	1/16	14.00
2MAL182	2AK184H	151.12	18.0	18.25	6A	3/32	1-3/8	1-11/32	1/16	17.95

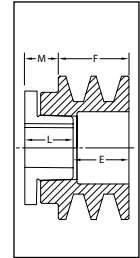

TYPE 2

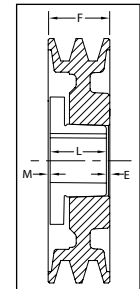

TYPE 4

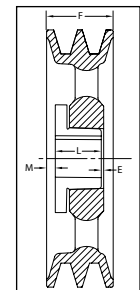

TYPE 6

P.D. for "A" Belts = O.D.

* Dimensions to closest fraction

Legend: "E" and "M" dimensions may vary according to shaft tolerance.

With "L" bushing only reverse mounting is possible, see page 14 for installation instructions.

MA (A & 3L-4L V-BELTS)

1 GROOVE

Part No	Cross. Ref.	List Price \$	D.D. (3L) Belts	D.D. A (4L) Belts	O.D.	T	L	Standard Bores	Max. Bore	App. Wt.
MA15*	-	8.00	-	1.30	1.55	1B	1-1/4	1/2 · 5/8	5/8	0.4
MA18*	AK17	8.32	-	1.50	1.75	1B	1-3/8	1/2 · 5/8 · 3/4	3/4	0.4
MA20	AK20	8.32	1.41	1.75	2.00	1B	1-3/8	1/2 · 5/8 · 3/4 · 7/8	7/8	0.7
MA21	AK21	8.68	1.51	1.85	2.10	1B	1-3/8	1/2 · 5/8 · 3/4 · 7/8	7/8	0.7
MA22	AK22	8.68	1.61	1.95	2.20	1B	1-3/8	1/2 · 5/8 · 3/4 · 7/8	7/8	0.8
MA23	AK23	9.24	1.71	2.05	2.30	1B	1-3/8	1/2 · 5/8 · 3/4 · 7/8 · 1	1	0.8
MA24	-	9.42	1.76	2.10	2.35	1B	1-3/8	1/2 · 5/8 · 3/4 · 7/8	7/8	0.8
MA25	AK25	9.60	1.91	2.25	2.50	2B	1-1/4	1/2 · 5/8 · 3/4 · 7/8 · 1 · 1-1/8	1-1/8	0.9
MA26	AK26	9.76	2.01	2.35	2.60	2B	1-1/4	1/2 · 5/8 · 3/4 · 7/8 · 1	1-1/8	0.9
MA27	AK27	10.04	2.11	2.45	2.70	2B	1-1/4	1/2 · 5/8 · 3/4 · 7/8 · 1	1-1/8	0.9
MA28	AK28	11.00	2.21	2.55	2.80	2B	1-1/4	1/2 · 5/8 · 3/4 · 7/8 · 1 · 1-1/8	1-1/8	0.9
MA30	AK30	11.88	2.46	2.80	3.05	2B	1-1/4	1/2 · 5/8 · 3/4 · 7/8 · 1 · 1-1/8	1-1/8	1.2
MA33	AK32	12.24	2.66	3.00	3.25	2B	1-1/4	1/2 · 5/8 · 3/4 · 7/8 · 1 · 1-1/8	1-1/8	1.5
MA35	AK34	13.32	2.86	3.20	3.45	2B	1-1/4	1/2 · 5/8 · 3/4 · 7/8 · 1 · 1-1/8 · 28MM	1-1/8	1.4
MA38	AK39	16.60	3.16	3.50	3.75	2W	1-1/8	1/2 · 5/8 · 3/4 · 7/8 · 15/16 · 1 · 1-1/8	1-1/8	1.5
MA40	AK41	19.16	3.36	3.70	3.95	2W	1-1/8	1/2 · 5/8 · 3/4 · 7/8 · 15/16 · 1 · 1-1/8	1-3/16	2.0
MA43	AK44	19.72	3.66	4.00	4.25	2W	1-1/8	1/2 · 5/8 · 3/4 · 7/8 · 15/16 · 1 · 1-1/8	1-3/16	2.0
MA45	AK46	20.56	3.86	4.20	4.45	2W	1-1/8	1/2 · 5/8 · 3/4 · 7/8 · 15/16 · 1 · 1-1/8	1-3/16	2.0
MA48	AK49	20.76	4.16	4.50	4.75	1A	1-3/8	1/2 · 5/8 · 3/4 · 7/8 · 15/16 · 1 · 1-1/8	1-3/16	2.0
MA50	AK51	21.92	4.36	4.70	4.95	1A	1-3/8	1/2 · 5/8 · 3/4 · 7/8 · 1 · 1-1/8 · 1-3/16	1-3/16	2.0
MA53	AK54	22.32	4.66	5.00	5.25	1A	1-3/8	1/2 · 5/8 · 3/4 · 7/8 · 15/16 · 1 · 1-1/8 · 1-3/16	1-3/16	2.5
MA55	AK56	23.96	4.86	5.20	5.45	1A	1-3/8	1/2 · 5/8 · 3/4 · 7/8 · 15/16 · 1 · 1-1/8 · 1-3/16	1-3/16	2.5
MA58	AK59	25.36	5.16	5.50	5.75	1A	1-3/8	1/2 · 5/8 · 3/4 · 7/8 · 15/16 · 1 · 1-1/8 · 1-3/16	1-3/16	2.5
MA60	AK61	25.56	5.36	5.70	5.95	1A	1-3/8	1/2 · 5/8 · 3/4 · 7/8 · 15/16 · 1 · 1-1/8 · 1-3/16	1-3/16	3.0
MA63	AK64	26.24	5.66	6.00	6.25	1A	1-3/8	1/2 · 5/8 · 3/4 · 7/8 · 15/16 · 1 · 1-1/8 · 1-3/16	1-1/4	3.0
MA65	AK66	27.28	5.86	6.20	6.45	1A	1-3/8	1/2 · 5/8 · 3/4 · 7/8 · 1 · 1-1/8	1-1/4	3.0
MA68	AK69	29.68	6.16	6.50	6.75	1A	1-3/8	1/2 · 5/8 · 3/4 · 7/8 · 1 · 1-1/8 · 1-3/16	1-1/4	3.0
MA70	AK71	30.92	6.36	6.70	6.95	1A	1-3/8	1/2 · 5/8 · 3/4 · 7/8 · 1 · 1-1/8 · 1-3/16 · 1-7/16	1-7/16	3.5
MA73	AK74	31.04	6.66	7.00	7.25	1A	1-3/8	1/2 · 5/8 · 3/4 · 7/8 · 15/16 · 1 · 1-1/8 · 1-3/16 · 1-1/4 · 1-7/16	1-7/16	3.5
MA78	AK79	35.48	7.16	7.50	7.75	1A	1-3/8	5/8 · 3/4 · 7/8 · 1 · 1-1/8 · 1-7/16	1-7/16	3.5
MA80	-	35.48	7.41	7.75	8.00	1A	1-3/8	1/2 · 5/8 · 3/4 · 7/8 · 1 · 1-1/8 · 1-3/16 · 1-1/4 · 1-7/16	1-7/16	3.5
MA83	AK84	37.96	7.66	8.00	8.25	1A	1-3/8	1/2 · 5/8 · 3/4 · 7/8 · 15/16 · 1 · 1-1/8 · 1-3/16 · 1-7/16	1-7/16	4.4
MA88	AK89	41.32	8.16	8.50	8.75	1A	1-3/8	5/8 · 3/4 · 7/8 · 1 · 1-1/8 · 1-7/16	1-7/16	4.5
MA90	-	41.32	8.41	8.75	9.00	1A	1-3/8	1/2 · 5/8 · 3/4 · 7/8 · 1 · 1-1/8 · 1-3/16 · 1-7/16	1-7/16	4.5
MA93	AK94	42.20	8.66	9.00	9.25	1A	1-3/8	1/2 · 5/8 · 3/4 · 7/8 · 15/16 · 1 · 1-1/8 · 1-3/16 · 1-1/4 · 1-7/16	1-7/16	5.4
MA98	AK99	44.20	9.16	9.50	9.75	1A	1-3/8	5/8 · 3/4 · 7/8 · 1 · 1-1/8 · 1-7/16	1-7/16	5.5
MA100	-	44.20	9.41	9.75	10.00	1A	1-3/8	1/2 · 5/8 · 3/4 · 7/8 · 1 · 1-1/8 · 1-3/16 · 1-7/16	1-7/16	5.5
MA103	AK104	45.04	9.66	10.00	10.25	1A	1-3/8	5/8 · 3/4 · 7/8 · 1 · 1-1/8 · 1-3/16 · 1-1/4 · 1-3/8 · 1-7/16	1-7/16	6.0
MA108	AK109	48.28	10.16	10.50	10.75	1A	1-3/8	3/4 · 7/8 · 1 · 1-1/8 · 1-3/8 · 1-7/16	1-7/16	6.0
MA110	-	48.28	10.41	10.75	11.00	1A	1-3/8	1/2 · 5/8 · 3/4 · 7/8 · 1 · 1-1/8 · 1-7/16	1-5/8	6.5
MA113	AK114	50.72	10.66	11.00	11.25	1A	1-3/8	1/2 · 5/8 · 3/4 · 7/8 · 1 · 1-1/8 · 1-3/16 · 1-7/16	1-7/16	6.5
MA120	-	56.60	11.41	11.75	12.00	1A	1-3/8	1/2 · 5/8 · 3/4 · 7/8 · 1 · 1-1/8 · 1-3/16 · 1-7/16	1-7/16	7.5
MA123	AK124	56.60	11.66	12.00	12.25	1A	1-3/8	5/8 · 3/4 · 7/8 · 1 · 1-1/8 · 1-3/16 · 1-1/4 · 1-7/16	1-7/16	7.0
MA133	AK134	67.96	12.66	13.00	13.25	1A	1-3/8	5/8 · 3/4 · 7/8 · 1 · 1-1/8 · 1-3/16 · 1-3/8 · 1-7/16	1-3/4	8.5
MA143	AK144	75.40	13.66	14.00	14.25	1A	1-3/8	5/8 · 3/4 · 7/8 · 1 · 1-1/8 · 1-3/16 · 1-7/16	1-3/4	9.0
MA153	AK154	85.00	14.66	15.00	15.25	1A	1-3/8	5/8 · 3/4 · 7/8 · 1 · 1-1/8 · 1-3/16 · 1-3/8 · 1-7/16	1-3/4	9.0
MA183	AK184	107.56	17.66	18.00	18.25	1A	1-3/8	5/8 · 3/4 · 7/8 · 1 · 1-1/8 · 1-3/16 · 1-7/16	1-7/8	14.0

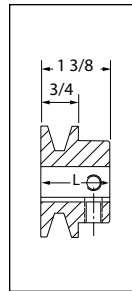

TYPE 1

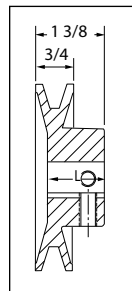

TYPE 2

P.D. for "A" (4L) Belts = O.D

P.D. for "3L" Belts = D.D.+0.25 = O.D.-0.34

*DO NOT use 3L belts with MA15 and MA18 sheaves

PROMOTIONAL

BUSHINGS & HUBS

SHEAVES

SYNCHRONOUS DRIVES

COUPLINGS

BELTS

CROSS REFERENCES

2MA (A V-BELTS)

2 GROOVES

Part No	Cross. Ref.	List Price \$	D.D. A Belts	O.D.	T	L	Standard Bores	Max. Bore	App. Wt.
2MA20	2AK20	20.64	1.75	2.00	3B	2-1/16	1/2 · 5/8 · 3/4	3/4	1.0
2MA22	2AK21	20.64	1.90	2.15	3B	2-1/16	1/2 · 5/8 · 3/4	7/8	1.0
2MA23	2AK22	22.72	2.00	2.25	3B	2-1/16	1/2 · 5/8 · 3/4 · 7/8 · 1	1	1.0
2MA24	2AK23	22.72	2.10	2.35	4B	1-7/8	1/2 · 5/8 · 3/4 · 7/8 · 1	1-1/8	1.0
2MA25	2AK25	22.88	2.30	2.55	4B	1-11/16	1/2 · 5/8 · 3/4 · 7/8 · 1 · 1-1/8	1-1/8	1.5
2MA27	2AK26	25.12	2.40	2.65	4B	1-7/8	1/2 · 5/8 · 3/4 · 7/8 · 1 · 1-1/8	1-1/8	1.5
2MA28	2AK27	27.68	2.50	2.75	4B	1-11/16	1/2 · 5/8 · 3/4 · 7/8 · 1 · 1-1/8	1-1/8	1.5
2MA29	2AK28	27.68	2.60	2.85	4B	1-11/16	1/2 · 5/8 · 3/4 · 7/8 · 1 · 1-1/8	1-1/8	1.5
2MA30	2AK30	30.72	2.80	3.05	4B	1-11/16	1/2 · 5/8 · 3/4 · 7/8 · 1 · 1-1/8	1-1/8	2.0
2MA33	2AK32	34.56	3.00	3.25	4B	1-5/8	1/2 · 5/8 · 3/4 · 7/8 · 1 · 1-1/8	1-1/8	2.0
2MA35	2AK34	35.68	3.20	3.45	4B	1-5/8	1/2 · 5/8 · 3/4 · 7/8 · 1 · 1-1/8	1-1/8	2.5
2MA38	2AK39	36.32	3.50	3.75	4B	1-5/8	1/2 · 5/8 · 3/4 · 7/8 · 1 · 1-1/8	1-3/16	3.0
2MA40	2AK41	40.36	3.70	3.95	4W	1-9/16	1/2 · 5/8 · 3/4 · 7/8 · 1 · 1-1/8	1-3/16	3.0
2MA43	2AK44	41.60	4.00	4.25	4W	1-9/16	1/2 · 5/8 · 3/4 · 7/8 · 1 · 1-1/8	1-3/16	3.0
2MA45	2AK46	43.32	4.20	4.45	4W	1-11/16	1/2 · 5/8 · 3/4 · 7/8 · 1 · 1-1/8	1-3/16	4.0
2MA48	2AK49	44.40	4.50	4.75	4W	1-9/16	1/2 · 5/8 · 3/4 · 7/8 · 1 · 1-1/8 · 1-3/8	1-3/8	3.5
2MA50	2AK51	45.44	4.70	4.95	4W	1-9/16	1/2 · 5/8 · 3/4 · 7/8 · 1 · 1-1/8 · 1-3/8	1-3/16	4.0
2MA53	2AK54	45.92	5.00	5.25	4W	1-9/16	5/8 · 3/4 · 7/8 · 1 · 1-1/8 · 1-3/8	1-3/8	4.0
2MA55	2AK56	46.72	5.20	5.45	4W	1-9/16	5/8 · 3/4 · 7/8 · 1 · 1-1/8 · 1-3/8	1-3/8	5.0
2MA58	2AK59	50.52	5.50	5.75	4W	1-9/16	1/2 · 5/8 · 3/4 · 7/8 · 1 · 1-1/8 · 1-3/16 · 1-3/8	1-3/8	5.0
2MA60	2AK61	52.08	5.70	5.95	4W	1-11/16	1/2 · 5/8 · 3/4 · 7/8 · 1 · 1-1/8 · 1-3/8	1-3/8	6.0
2MA63	2AK64	54.48	6.00	6.25	4A	1-9/16	5/8 · 3/4 · 7/8 · 1 · 1-1/8 · 1-3/16 · 1-3/8 · 1-7/16	1-11/16	5.5
2MA70	·	60.96	6.75	7.00	4A	1-9/16	1/2 · 5/8 · 3/4 · 7/8 · 1 · 1-1/8 · 1-7/16	1-11/16	6.0
2MA73	2AK74	61.96	7.00	7.25	4A	1-9/16	3/4 · 7/8 · 1 · 1-1/8 · 1-3/16 · 1-3/8 · 1-7/16	1-11/16	6.0
2MA80	·	66.88	7.75	8.00	4A	1-9/16	1/2 · 5/8 · 3/4 · 7/8 · 1 · 1-1/8 · 1-7/16	1-11/16	7.0
2MA83	2AK84	67.88	8.00	8.25	4A	1-9/16	3/4 · 7/8 · 15/16 · 1 · 1-1/8 · 1-3/16 · 1-3/8 · 1-7/16	1-7/16	8.0
2MA90	·	72.80	8.75	9.00	4A	1-9/16	5/8 · 3/4 · 7/8 · 1 · 1-1/8 · 1-7/16	1-7/16	8.5
2MA93	2AK94	73.80	9.00	9.25	4A	1-9/16	3/4 · 7/8 · 1 · 1-1/8 · 1-3/16 · 1-3/8 · 1-7/16	1-11/16	9.0
2MA100	·	78.72	9.75	10.00	4A	1-9/16	5/8 · 3/4 · 7/8 · 1 · 1-1/8 · 1-7/16	1-11/16	9.0
2MA103	2AK104	79.32	10.00	10.25	4A	1-9/16	3/4 · 7/8 · 15/16 · 1 · 1-1/8 · 1-3/16 · 1-7/16	1-11/16	10.0
2MA110	·	85.08	10.75	11.00	4A	1-9/16	3/4 · 7/8 · 1 · 1-1/8 · 1-7/16	1-11/16	10.0
2MA113	2AK114	86.08	11.00	11.25	4A	1-9/16	3/4 · 7/8 · 1 · 1-1/8 · 1-3/16 · 1-3/8 · 1-7/16	1-11/16	11.0
2MA120	·	94.28	11.75	12.00	4A	1-9/16	5/8 · 3/4 · 7/8 · 1 · 1-1/8 · 1-7/16	1-11/16	11.0
2MA123	2AK124	94.28	12.00	12.25	4A	1-19/32	3/4 · 7/8 · 1 · 1-1/8 · 1-3/16 · 1-7/16	1-11/16	12.0
2MA133	2AK134	111.04	13.00	13.25	4A	1-19/32	5/8 · 7/8 · 1 · 1-1/8 · 1-3/16 · 1-7/16	1-11/16	14.0
2MA143	2AK144	117.24	14.00	14.25	4A	1-9/16	5/8 · 3/4 · 7/8 · 1 · 1-1/8 · 1-3/16 · 1-7/16	1-11/16	15.0
2MA153	2AK154	135.28	15.00	15.25	4A	1-9/16	5/8 · 3/4 · 7/8 · 1 · 1-1/8 · 1-3/16 · 1-7/16	1-15/16	17.0
2MA183	2AK184	170.48	18.00	18.25	4A	1-17/32	5/8 · 7/8 · 1 · 1-1/8 · 1-3/16 · 1-7/16	1-7/16	19.0

P.D. for "A" Belts = O.D.

Keyseat Informations

Bore Range	Keyseat
1/2"	None
5/8" · 7/8"	3/16" X 3/32"
15/16" · 1-1/4"	1/4" X 1/8"
1-5/16" · 1-3/8"	5/16" X 5/32"
1-7/16" · 1-3/4"	3/8" X 3/16"

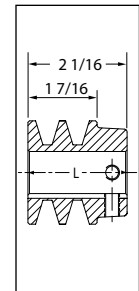

TYPE 3

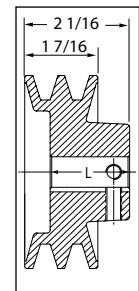

TYPE 4

PROMOTIONAL

BUSHINGS & HUBS

SHEAVES

SYNCHRONOUS DRIVES

COUPLINGS

BELTS

CROSS REFERENCES