

# TB SHEAVES



## FEATURES:

- Used with conventional A and B belts
- Available in 1 to 3 grooves
- P1 Bushing used with the majority of the TB Sheaves
- General industrial applications

## NOTE:

- The type of sheave construction is indicated in the column entitled Type The number refers to the drawing and the letter as follows:  
A = arms; B = block; W = web.

## HOW TO ORDER

EXAMPLE: **2TB154**

**2TB**

**154**

**2:** NUMBER OF GROOVES  
**TB:** TYPE OF SHEAVES  
**154:** DATUM DIAMETER FOR B BELTS (15.4")

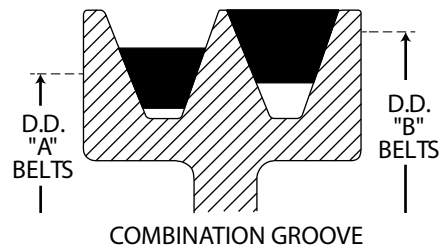

# TB SHEAVES

PROMOTIONAL

BUSHINGS & HUBS

SHEAVES

SYNCHRONOUS DRIVES

COUPLINGS

BELTS

CROSS REFERENCES

## 1 Groove

Part #	Cross. Ref.	List Price \$	Diameters			F = 1 inch					Weight
			Outside	Datum A Belts	Datum B Belts	H	Type	B	L	E	
1TB34	1TB34	24.47	3.75	3	3.4	1-1/16	2	P1	1-15/16	1/8	2
1TB36	1TB36	25.30	3.95	3.6	3.2	1-1/16	2	P1	1-15/16	1/8	2.3
1TB38	1TB38	26.07	4.15	3.4	3.8	1-1/16	2	P1	1-15/16	1/8	2.6
1TB40	1TB40	26.90	4.35	3.6	4	5/8	10B	P1	1-15/16	5/16	2.1
1TB42	1TB42	27.70	4.55	3.8	4.2	5/8	10B	P1	1-15/16	5/16	2.4
1TB44	1TB44	28.53	4.75	4	4.4	5/8	10B	P1	1-15/16	5/16	2.8
1TB46	1TB46	31.60	4.95	4.2	4.6	5/8	10B	P1	1-15/16	5/16	3.1
1TB48	1TB48	32.40	5.15	4.4	4.8	5/8	10B	P1	1-15/16	5/16	3.5
1TB50	1TB50	33.20	5.35	4.6	5	5/8	10B	P1	1-15/16	5/16	3.9
1TB52	1TB52	34.20	5.55	4.8	5.2	5/8	10B	P1	1-15/16	5/16	4.1
1TB54	1TB54	34.83	5.75	5	5.4	5/8	10B	P1	1-15/16	5/16	4.6
1TB56	1TB56	35.67	5.95	5.2	5.6	5/8	10B	P1	1-15/16	5/16	5.1
1TB58	1TB58	36.43	6.15	5.4	5.8	5/8	10B	P1	1-15/16	5/16	5.6
1TB60	1TB60	38.07	6.35	5.6	6	5/8	10W	P1	1-15/16	5/16	6
1TB62	1TB62	39.70	6.55	5.8	6.2	5/8	10W	P1	1-15/16	5/16	5.5
1TB64	1TB64	41.30	6.75	6	6.4	5/8	10W	P1	1-15/16	5/16	5.8
1TB66	1TB66	44.53	6.95	6.2	6.6	5/8	10W	P1	1-15/16	5/16	5.9
1TB68	1TB68	46.17	7.15	6.4	6.8	5/8	10W	P1	1-15/16	5/16	6.1
1TB70	1TB70	47.80	7.35	6.6	7	25/32	16A	P1	1-15/16	5/32	6.4
1TB74	1TB74	51.03	7.75	7	7.4	25/32	16A	P1	1-15/16	5/32	7.3
1TB80	1TB80	52.63	8.35	7.6	8	25/32	16A	P1	1-15/16	5/32	7.8
1TB86	1TB86	55.90	8.95	8.2	8.6	25/32	16A	P1	1-15/16	5/32	8.6
1TB90	1TB90	56.70	9.35	8.6	9	25/32	16A	P1	1-15/16	5/32	8.9
1TB94	1TB94	57.50	9.75	9	9.4	25/32	16A	P1	1-15/16	5/32	9.1
1TB110	1TB110	67.23	11.35	10.6	11	25/32	16A	P1	1-15/16	5/32	11.1
1TB124	1TB124	68.33	12.75	12	12.4	1-1/8	16A	Q1	2-1/2	3/8	17.8
1TB136	1TB136	73.20	13.95	13.2	13.6	1-1/8	16A	Q1	2-1/2	3/8	18.2
1TB154	1TB154	98.33	15.75	15	15.4	1-1/8	16A	Q1	2-1/2	3/8	20.3
1TB160	1TB160	114.53	16.35	15.6	16	1-1/8	16A	Q1	2-1/2	3/8	22
1TB184*	1TB184	130.73	18.75	18	18.4	1-1/8	16A	Q1	2-1/2	3/8	27.5
1TB200*	1TB200	190.67	20.35	19.5	20	1-1/8	16A	Q1	2-1/2	3/8	27.2
1TB250*	1TB250	243.97	25.35	24.5	25	1-1/8	16A	Q1	2-1/2	3/8	42.4
1TB300*	1TB300	365.93	30.35	29.5	30	1-1/8	16A	Q1	2-1/2	3/8	56
1TB380*	1TB380	531.87	38.35	37.5	38	1-1/8	16A	Q1	2-1/2	3/8	78

## 2 Grooves

Part #	Cross. Ref.	List Price \$	Diameters			F = 1-3/4 inches					Weight
			Outside	Datum A Belts	Datum B Belts	H	Type	B	L	E	
2TB34	2TB34	34.17	3.75	3	3.4	1-1/16	2	P1	1-15/16	7/8	2.9
2TB36	2TB36	35.80	3.95	3.2	3.6	1-1/16	2	P1	1-15/16	7/8	3.8
2TB38	2TB38	37.43	4.15	3.4	3.8	5/8	5	P1	1-15/16	7/16	3
2TB40	2TB40	39.03	4.35	3.6	4	5/8	5	P1	1-15/16	7/16	3.8
2TB42	2TB42	40.67	4.55	3.8	4.2	5/8	5	P1	1-15/16	7/16	3.9
2TB44	2TB44	42.23	4.75	4	4.4	3/16	13B	P1	1-15/16	0	3.9
2TB46	2TB46	46.17	4.95	4.2	4.6	3/16	13B	P1	1-15/16	0	4.5
2TB48	2TB48	47.80	5.15	4.4	4.8	3/16	13B	P1	1-15/16	0	5.3
2TB50	2TB50	49.40	5.35	4.6	5	3/16	13B	P1	1-15/16	0	5.6
2TB52	2TB52	51.03	5.55	4.8	5.2	3/16	13B	P1	1-15/16	0	6.1
2TB54	2TB54	52.63	5.75	5	5.4	3/16	13B	P1	1-15/16	0	6.5
2TB56	2TB56	54.27	5.95	5.2	5.6	3/16	13B	P1	1-15/16	0	7.4
2TB58	2TB58	55.90	6.15	5.4	5.8	3/16	13B	P1	1-15/16	0	8
2TB60	2TB60	57.50	6.35	5.6	6	3/16	13B	P1	1-15/16	0	8.9
2TB62	2TB62	59.13	6.55	5.8	6.2	3/16	13W	P1	1-15/16	0	7.6
2TB64	2TB64	60.73	6.75	6	6.4	3/16	13W	P1	1-15/16	0	7.8
2TB66	2TB66	61.57	6.95	6.2	6.6	3/16	13W	P1	1-15/16	0	8.3

\*Please contact Baldor-Maska for lead time

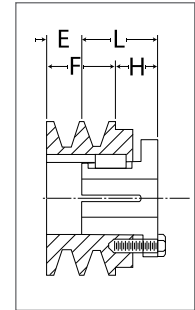

TYPE 2

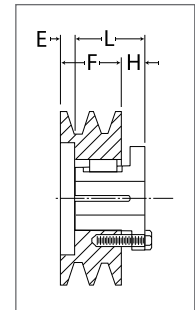

TYPE 5

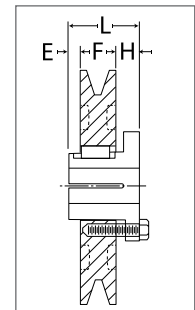

TYPE 10

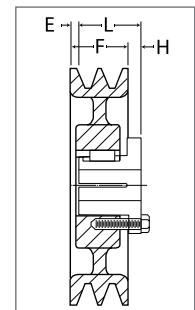

TYPE 13

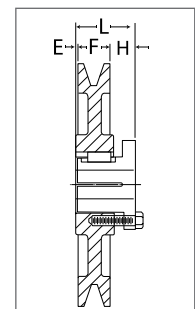

TYPE 16

# TB SHEAVES

2 Grooves

Part #	Cross. Ref.	List Price \$	Diameters			F = 1-3/4 inches					Weight
			Outside	Datum A Belts	Datum B Belts	H	Type	B	L	E	
2TB68	2TB68	62.37	7.15	6.4	6.8	3/16	13W	P1	1-15/16	0	8.8
2TB70	2TB70	62.67	7.35	6.6	7	3/4	13W	Q1	2-1/2	0	11.1
2TB74	2TB74	63.50	7.75	7	7.4	3/4	13W	Q1	2-1/2	0	11.5
2TB80	2TB80	64.30	8.35	7.6	8	3/4	13W	Q1	2-1/2	0	12.8
2TB86	2TB86	65.93	8.95	8.2	8.6	3/4	13W	Q1	2-1/2	0	16
2TB90	2TB90	66.73	9.35	8.6	9	3/4	13A	Q1	2-1/2	0	15.1
2TB94	2TB94	67.53	9.75	9	9.4	3/4	13A	Q1	2-1/2	0	15.5
2TB110	2TB110	78.87	11.35	10.6	11	3/4	13A	Q1	2-1/2	0	18.9
2TB124	2TB124	85.37	12.75	12	12.4	3/4	13A	Q1	2-1/2	0	21.1
2TB136	2TB136	101.57	13.95	13.2	13.6	3/4	13A	Q1	2-1/2	0	23
2TB154	2TB154	140.43	15.75	15	15.4	3/4	13A	Q1	2-1/2	0	24.8
2TB160	2TB160	148.53	16.35	15.6	16	3/4	13A	Q1	2-1/2	0	27
2TB184*	2TB184	185.80	18.75	18	18.4	3/4	13A	Q1	2-1/2	0	32.8
2TB200*	2TB200	220.60	20.35	19.5	20	3/4	13A	Q1	2-1/2	0	42.3
2TB250*	2TB250	330.77	25.35	24.5	25	3/4	13A	Q1	2-1/2	0	50.3
2TB300*	2TB300	366.40	30.35	29.5	30	3/4	13A	Q1	2-1/2	0	68.8
2TB380*	2TB380	690.40	38.35	37.5	38	3/4	13A	Q1	2-1/2	0	95.5

3 Grooves

Part #	Cross. Ref.	List Price \$	Diameters			F = 2-1/2 inches					Weight
			Outside	Datum A Belts	Datum B Belts	H	Type	B	L	E	
3TB34	3TB34	38.00	3.75	3	3.4	1-1/16	3	P2	2-15/16	5/8	3.8
3TB36	3TB36	39.63	3.95	3.2	3.6	1-1/16	3	P2	2-15/16	5/8	4.4
3TB38	3TB38	42.27	4.15	3.4	3.8	5/8	5	P1	1-15/16	1-3/16	3.8
3TB40	3TB40	43.90	4.35	3.6	4	5/8	5	P1	1-15/16	1-3/16	4.5
3TB42	3TB42	45.53	4.55	3.8	4.2	5/8	5	P1	1-15/16	1-3/16	4.9
3TB44	3TB44	47.13	4.75	4	4.4	0	13B	P1	1-15/16	9/16	5.1
3TB46	3TB46	54.27	4.95	4.2	4.6	0	13W	P1	1-15/16	9/16	6
3TB48	3TB48	55.90	5.15	4.4	4.8	0	13W	P1	1-15/16	9/16	6.3
3TB50	3TB50	57.50	5.35	4.6	5	0	13W	P1	1-15/16	9/16	6.9
3TB52	3TB52	59.13	5.55	4.8	5.2	0	13W	P1	1-15/16	9/16	7.5
3TB54	3TB54	60.73	5.75	5	5.4	0	13W	P1	1-15/16	9/16	8.3
3TB56	3TB56	62.37	5.95	5.2	5.6	0	13W	P1	1-15/16	9/16	9
3TB58	3TB58	64.00	6.15	5.4	5.8	0	13W	P1	1-15/16	9/16	9.6
3TB60	3TB60	65.60	6.35	5.6	6	0	13W	P1	1-15/16	9/16	10.5
3TB62	3TB62	67.23	6.55	5.8	6.2	0	13W	P1	1-15/16	9/16	9.4
3TB64	3TB64	70.47	6.75	6	6.4	0	13W	P1	1-15/16	9/16	9.5
3TB66	3TB66	72.10	6.95	6.2	6.6	0	13W	P1	1-15/16	9/16	10
3TB68	3TB68	73.70	7.15	6.4	6.8	0	13W	P1	1-15/16	9/16	10.4
3TB70	3TB70	70.77	7.35	6.6	7	3/8	13W	Q1	2-1/2	3/8	13
3TB74	3TB74	72.40	7.75	7	7.4	3/8	13W	Q1	2-1/2	3/8	13.3
3TB80	3TB80	75.63	8.35	7.6	8	3/8	13W	Q1	2-1/2	3/8	15.3
3TB86	3TB86	82.13	8.95	8.2	8.6	3/8	13W	Q1	2-1/2	3/8	18.9
3TB90	3TB90	85.37	9.35	8.6	9	3/8	13A	Q1	2-1/2	3/8	18.1
3TB94	3TB94	88.60	9.75	9	9.4	3/8	13A	Q1	2-1/2	3/8	18
3TB110	3TB110	104.80	11.35	10.6	11	3/8	13A	Q1	2-1/2	3/8	21.3
3TB124	3TB124	121.00	12.75	12	12.4	3/8	13A	Q1	2-1/2	3/8	25.4
3TB136	3TB136	130.73	13.95	13.2	13.6	3/8	13A	Q1	2-1/2	3/8	27.4
3TB154*	3TB154	166.37	15.75	15	15.4	3/8	13A	Q1	2-1/2	3/8	29.8
3TB160*	3TB160	176.07	16.35	15.6	16	3/8	13A	Q1	2-1/2	3/8	32
3TB184*	3TB184	201.93	18.75	18	18.4	3/8	13A	Q1	2-1/2	3/8	37.8
3TB200*	3TB200	272.47	20.35	19.5	20	3/8	13A	Q1	2-1/2	3/8	49.9
3TB250*	3TB250	366.40	25.35	24.5	25	3/8	13A	Q1	2-1/2	3/8	61
3TB300*	3TB300	415.00	30.35	29.5	30	3/8	13A	Q1	2-1/2	3/8	78.5
3TB380*	3TB380	756.83	38.35	37.5	38	3/8	13A	Q1	2-1/2	3/8	110

\*Please contact Baldor-Maska for lead time

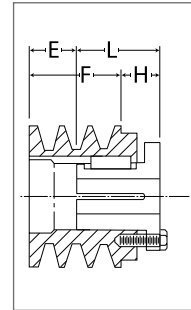

TYPE 3

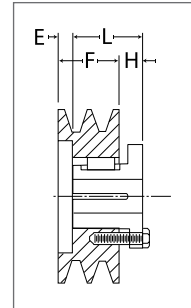

TYPE 5

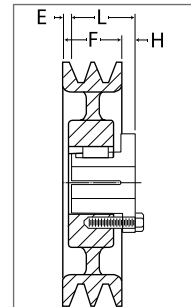

TYPE 13

PROMOTIONAL

BUSHINGS & HUBS

SHEAVES

SYNCHRONOUS DRIVES

COUPLINGS

BELTS

CROSS REFERENCES