

## One-Piece Weld-On Hinge Butts

### FEATURES

- .31" hot rolled steel stamping
- Plain, zinc plated, or stainless steel available
- Straight type or notched type available
- Optional hardware available - see hinge pins on pages 147-148

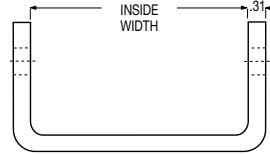
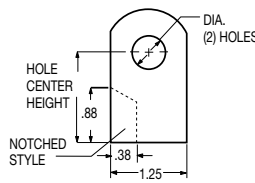

SWING DOOR – BUTTS, HINGES & PINS

### SPECIFICATIONS

part no.	weight (lbs.)	style	construction	hole dia.	inside width (in.)	height to hole center (in.)	rec. hinge	package	pkg qty	cross reference
<b>023-00583</b>	.61	notched	matte stainless steel	.51	2.88	1.75	022-00888, 022-00889	single	1	Dorsey
<b>023-00586</b>	.80	notched	matte stainless steel	.51	2.88	2.12	-	single	1	Dorsey
<b>023-00585</b>	.80	straight	matte stainless steel	.51	2.88	1.25	-	single	1	Dorsey
<b>023-01569</b>	.70	notched	plain steel	.51	2.88	2.12	-	single	1	Dorsey
<b>023-00639</b>	.84	straight	zinc plated	.51	4.25	1.12	022-00030	single	1	Miller
<b>023-00641</b>	.92	straight	zinc plated	.51	4.25	1.75	-	single	1	Miller
<b>023-00642</b>	.76	straight	zinc plated	.51	3.25	1.50	022-00490	single	1	Strick
<b>023-00645</b>	.64	notched	zinc plated	.51	4.25	1.12	022-00614	single	1	Kentucky
<b>023-00652</b>	.65	straight	plain steel	.51	2.88	1.25	-	single	1	Dorsey
<b>023-00659</b>	.64	notched	plain steel	.51	4.25	1.12	-	single	1	-
<b>023-00660</b>	.86	straight	plain steel	.51	2.88	2.13	-	single	1	Dorsey
<b>023-00662</b>	.60	notched	plain steel	.51	2.88	1.75	022-00888, 022-00889	single	1	Dorsey
<b>023-00664</b>	.62	notched	zinc plated	.51	4.25	1.38	023-00559	single	1	#HB-1156-6
<b>023-00669</b>	.54	notched	plain steel	.51	3.00	1.38	022-00975, 022-01047, 022-01105, 022-01182	single	1	Wabash
<b>023-00674</b>	.54	notched	zinc plated	.51	4.25	1.88	023-00557	single	1	Fruehauf
<b>023-00675</b>	.50	straight	zinc plated	.51	2.25	1.13	022-00013	single	1	Fruehauf
<b>023-00678</b>	.58	notched	plain steel	.63	3.00	1.63	023-00940	single	1	Trailmobile
<b>021-00308</b>	.50	notched	s.s cast	.51	3.00	1.38	022-00975, 022-01047, 022-01182	single	1	Wabash

## Dorsey Style Three-Hole Hinge

### FEATURES

- Steel stamping
- Zinc plated finish

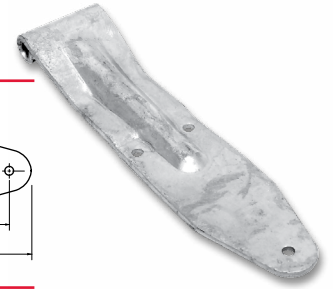
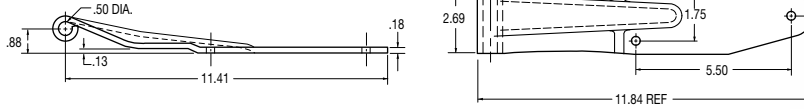

### SPECIFICATIONS

part no.	weight (lbs.)	recommended hinge pin	package	pkg qty	cross reference
<b>022-00391</b>	1.70	997-98022	single	1	Dorsey #4101482

## Dorsey Style Three-Hole Hinge

### FEATURES

- Steel stamping
- Zinc plated finish

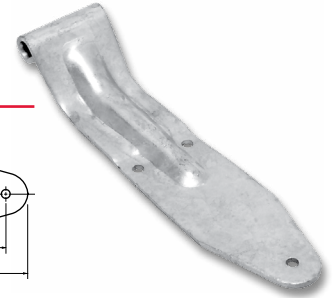
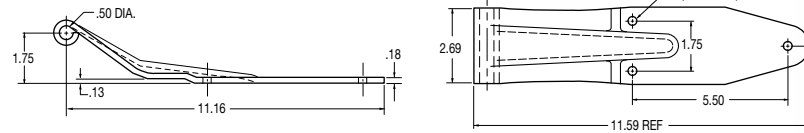

### SPECIFICATIONS

part no.	weight (lbs.)	recommended hinge pin	package	pkg qty	cross reference
<b>022-00392</b>	1.70	997-98022	single	1	Dorsey #4101481

## Dorsey Style Three-Hole Hinge

### FEATURES

- Steel stamping
- Zinc plated finish

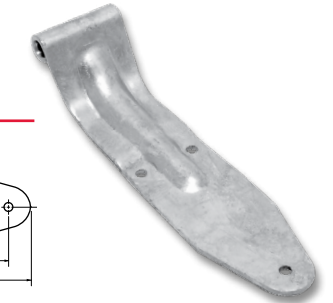
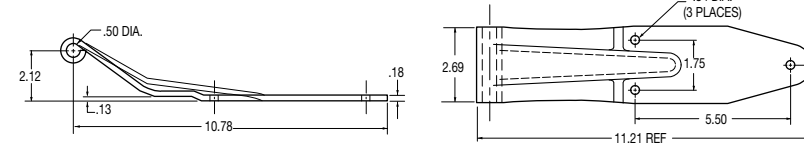

### SPECIFICATIONS

part no.	weight (lbs.)	recommended hinge pin	package	pkg qty	cross reference
<b>022-00393</b>	1.75	997-98022	single	1	Dorsey #5609022

## Dorsey Style Three-Hole Hinge

### FEATURES

- Aluminum extrusion

### ORDER DETAILS

- Orders in multiples of 10 shipped in shelf-ready box

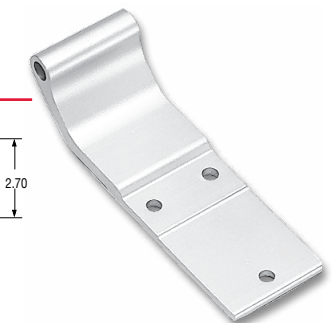
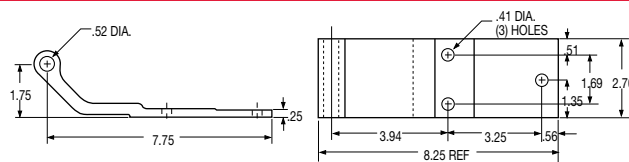

### SPECIFICATIONS

part no.	weight (lbs.)	recommended hinge butt	recommended hinge pin	package	pkg qty	cross reference
<b>022-00889</b>	.83	023-00662	997-98022	single	1	Dorsey #2810919

SWING DOOR – BUTTS, HINGES & PINS

## Dorsey Style Four-Hole Hinge

### FEATURES

- Aluminum extrusion

### ORDER DETAILS

- Orders in multiples of 10 shipped in shelf-ready box

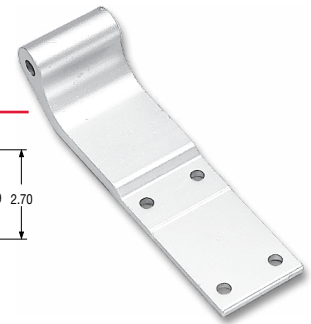
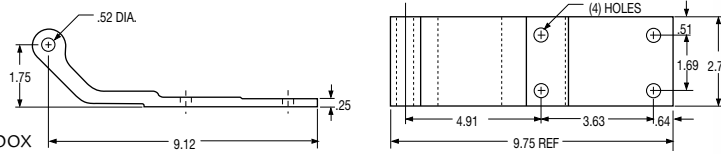

### SPECIFICATIONS

part no.	weight (lbs.)	recommended hinge butt	recommended hinge pin	package	pkg qty	cross reference
022-00888	1.14	023-00662	997-98022	single	1	Dorsey #2810093

## Fruehauf Style Three-Hole Hinge

### FEATURES

- Steel stamping
- Zinc plated finish

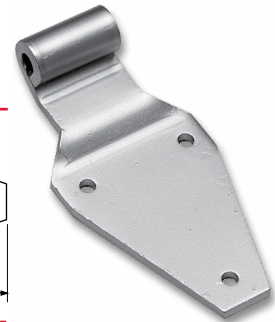
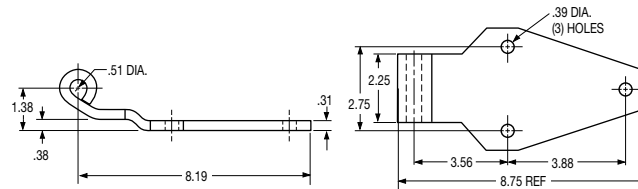

### SPECIFICATIONS

part no.	weight (lbs.)	package	pkg qty	cross reference
022-00007	2.40	single	1	Fruehauf #DCA-02-42

## Fruehauf Style Two-Hole Hinge

### FEATURES

- Steel stamping
- Zinc plated finish

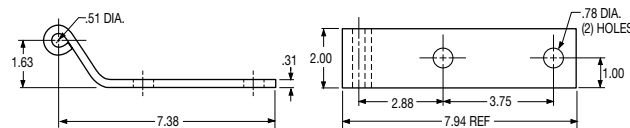

### SPECIFICATIONS

part no.	weight (lbs.)	description	package	pkg qty	cross reference
022-00013	1.75	door hinge	single	1	Fruehauf #DXA-0687

## Fruehauf Style Five-Hole Hinge

### FEATURES

- Aluminum extrusion

### ORDER DETAILS

- Orders in multiples of 10 shipped in shelf-ready box

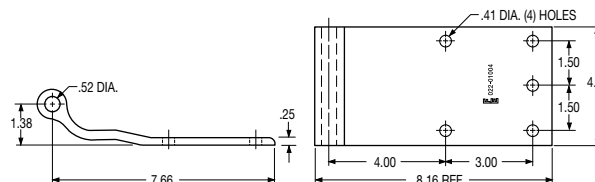

### SPECIFICATIONS

part no.	weight (lbs.)	recommended hinge pin	package	pkg qty	cross reference
022-01004	1.02	997-98017	single	1	Fruehauf BCF004678001, Fruehauf #DBA00158300

## Fruehauf Style Four-Hole Hinge (Radius Offset)

### FEATURES

- Steel construction
- Zinc plated finish

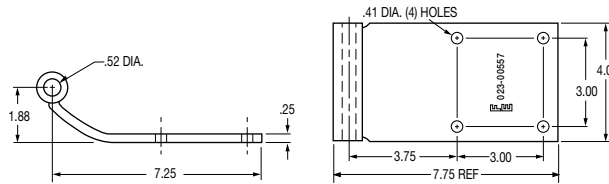

### SPECIFICATIONS

part no.	weight (lbs.)	recommended hinge pin	package	pkg qty	cross reference
023-00557	2.80	997-98017	single	1	Fruehauf #DCE-8681-1

## Fruehauf Style Four-Hole Hinge (Straight Offset)

### FEATURES

- Steel construction
- Zinc plated finish

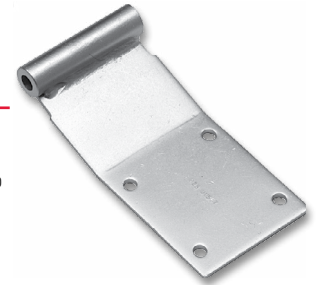
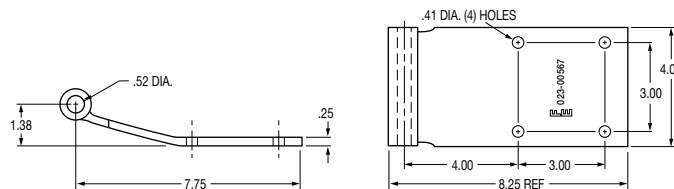

### SPECIFICATIONS

part no.	weight (lbs.)	recommended hinge pin	package	pkg qty	cross reference
023-00567	2.66	997-98017	single	1	Fruehauf #DCF-3980-1

## Gindy Style Three-Hole Hinge

### FEATURES

- Aluminum extrusion

### ORDER DETAILS

- Orders in multiples of 10 shipped in shelf-ready box

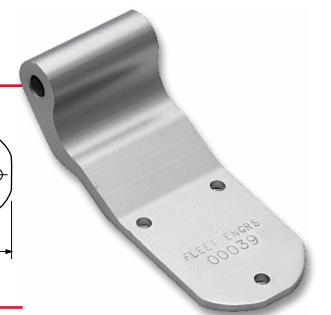
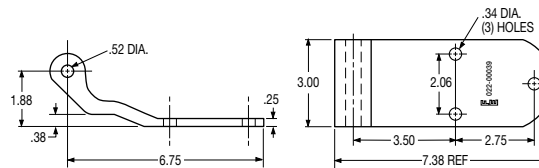

### SPECIFICATIONS

part no.	weight (lbs.)	package	pkg qty	cross reference
022-00039	1.00	single	1	Gindy #H04-B01073

## Great Dane Style Three-Hole Hinge

### FEATURES

- Aluminum extrusion
- With insert

### ORDER DETAILS

- Orders in multiples of 10 shipped in shelf-ready box

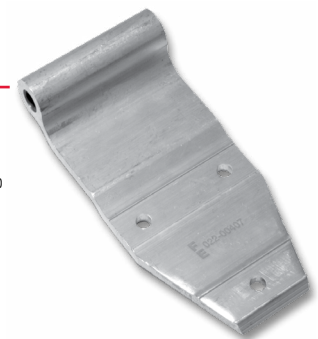
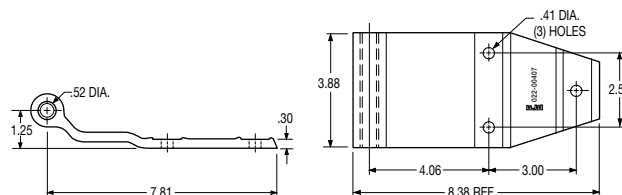

### SPECIFICATIONS

part no.	weight (lbs.)	recommended hinge pin	package	pkg qty	cross reference
022-00407	1.19	997-98027	single	1	Great Dane #31801018

SWING DOOR – BUTTS, HINGES & PINS

### Great Dane Style Three-Hole Hinge

**FEATURES**

- Aluminum extrusion

**ORDER DETAILS**

- Orders in multiples of 10 shipped in shelf-ready box

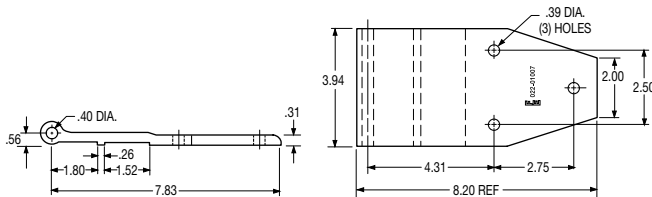

**SPECIFICATIONS**

part no.	weight (lbs.)	recommended hinge pin	package	pkg qty	cross reference
022-01007	.90	997-98015	single	1	Great Dane #15152

### Great Dane Style Four-Hole Hinge

**FEATURES**

- Aluminum extrusion
- With insert

**ORDER DETAILS**

- Orders in multiples of 10 shipped in shelf-ready box

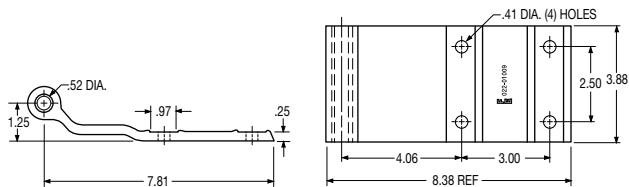

**SPECIFICATIONS**

part no.	weight (lbs.)	recommended hinge pin	package	pkg qty	cross reference
022-01009	1.19	997-98027	single	1	Great Dane #027-14488

### Great Dane Style Three-Hole Hinge

**FEATURES**

- Aluminum extrusion

**ORDER DETAILS**

- Orders in multiples of 10 shipped in shelf-ready box

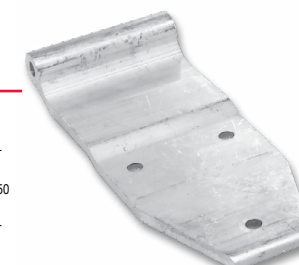
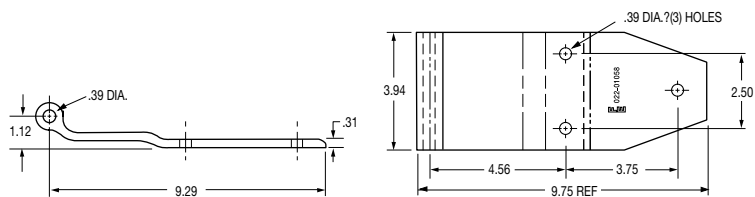

**SPECIFICATIONS**

part no.	weight (lbs.)	recommended hinge pin	package	pkg qty	cross reference
022-01058	1.16	997-98015	single	1	Great Dane #47563

### Great Dane Style Three-Hole Hinge

**FEATURES**

- Aluminum extrusion

**ORDER DETAILS**

- Orders in multiples of 10 shipped in shelf-ready box

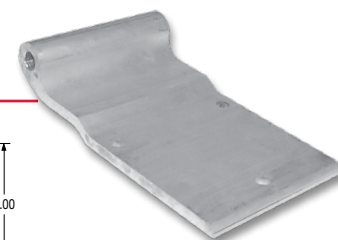
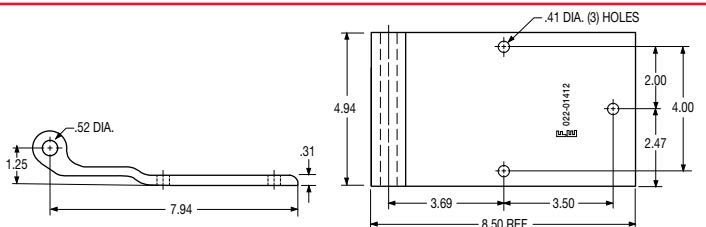

**SPECIFICATIONS**

part no.	weight (lbs.)	recommended hinge pin	package	pkg qty	cross reference
022-01412	1.61	-	single	1	Great Dane #43000124

## Great Dane Style Three-Hole Hinge (Reefer)

### FEATURES

- Aluminum extrusion

### ORDER DETAILS

- Orders in multiples of 10 shipped in shelf-ready box

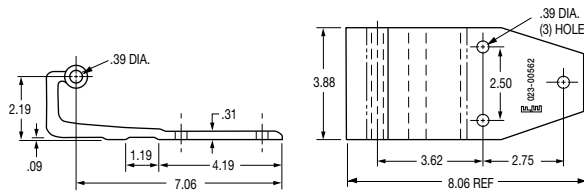

### SPECIFICATIONS

part no.	weight (lbs.)	recommended hinge pin	package	pkg qty	cross reference
023-00562	1.40	997-98015	single	1	Great Dane #08206

## Great Dane Style Three-Hole Hinge (Dry Freight)

### FEATURES

- Aluminum extrusion

### ORDER DETAILS

- Orders in multiples of 10 shipped in shelf-ready box

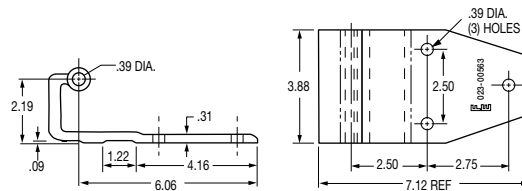

### SPECIFICATIONS

part no.	weight (lbs.)	recommended hinge pin	package	pkg qty	cross reference
023-00563	1.20	997-98015	single	1	Great Dane #08138

## Great Dane Style Three-Hole Hinge

### FEATURES

- Aluminum extrusion

### ORDER DETAILS

- Orders in multiples of 10 shipped in shelf-ready box

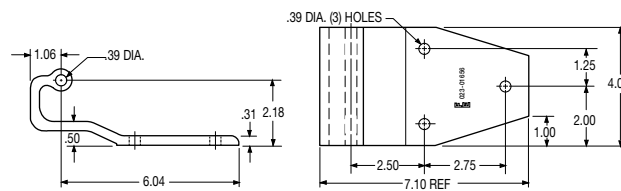

### SPECIFICATIONS

part no.	weight (lbs.)	recommended hinge pin	package	pkg qty	cross reference
023-01656	1.20	997-98015	single	1	Great Dane #42500813

## Hyundai Style Three-Hole Hinge

### FEATURES

- Aluminum extrusion
- With insert

### ORDER DETAILS

- Orders in multiples of 10 shipped in shelf-ready box

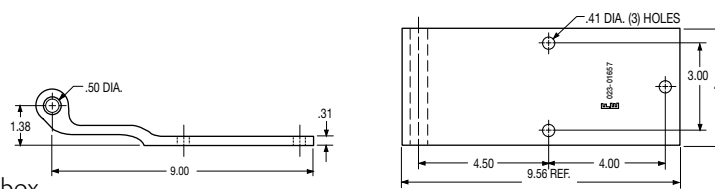

### SPECIFICATIONS

part no.	weight (lbs.)	package	pkg qty	cross reference
023-01657	1.51	single	1	Hyundai TRR7000C-AH and #20003977

SWING DOOR – BUTTS, HINGES & PINS

## Kentucky Style Three-Hole Hinge

### FEATURES

- Steel construction
- Zinc plated finish
- Reinforcing rib

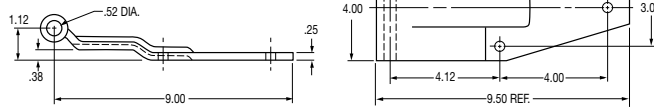

### SPECIFICATIONS

part no.	weight (lbs.)	recommended hinge butt	recommended hinge pin	package	pkg qty	cross reference
022-00614	2.70	023-00645	997-98017	single	1	Kentucky #2906, Eberhard #A1-5984-50

## Kentucky Style "Side Door" Hinge Assembly and Components

### FEATURES

- Aluminum extrusions
- With inserts

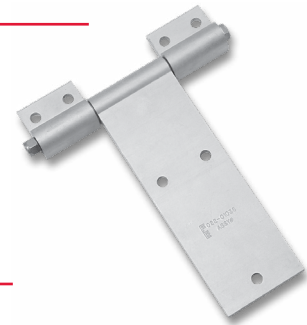
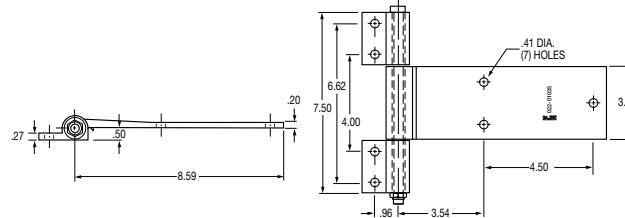

### SPECIFICATIONS

part no.	weight (lbs.)	description	package	pkg qty	cross reference
022-01035	1.47	assembly	single	1	Kentucky #6616396000
022-01092	0.71	hinge strap only	single	1	-
022-01093	0.23	hinge butt only - two bolt	single	1	-

## Kentucky Style "Belly Box" Hinge Assembly and Components

### FEATURES

- Aluminum extrusions
- With inserts

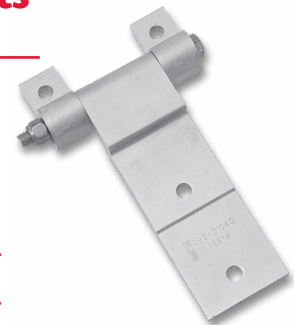
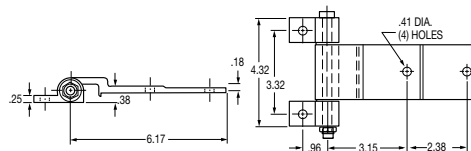

### SPECIFICATIONS

part no.	weight (lbs.)	description	package	pkg qty	cross reference
022-01040	.76	assembly	single	1	Kentucky #6616600000
022-01090	.41	hinge strap only	single	1	-
022-01091	.10	hinge butt only - single bolt	single	1	-

## Manac Style Three-Hole Hinge

### FEATURES

- Aluminum extrusion

### ORDER DETAILS

- Orders in multiples of 10 shipped in shelf-ready box

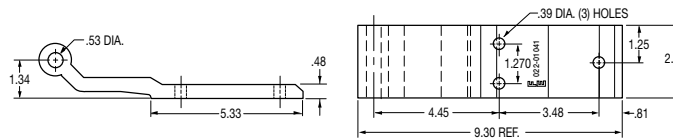

### SPECIFICATIONS

part no.	weight (lbs.)	package	pkg qty	cross reference
022-01041	1.15	single	1	Manac, #V3K00002

## Manac Style Hinge (No Holes)

### FEATURES

- Aluminum extrusion

### ORDER DETAILS

- Orders in multiples of 10 shipped in shelf-ready box

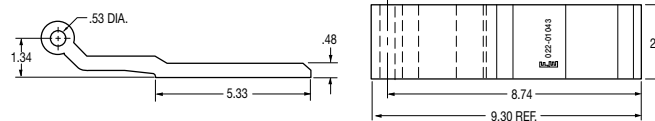

### SPECIFICATIONS

part no.	weight (lbs.)	package	pkg qty	cross reference
022-01043	1.15	single	1	Manac #353-239

## Miller Style Three-Hole Hinge

### FEATURES

- Steel stamping
- Zinc plated finish

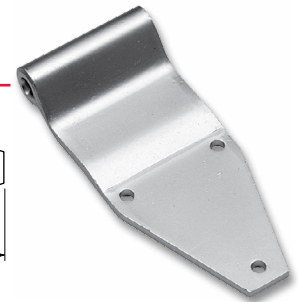
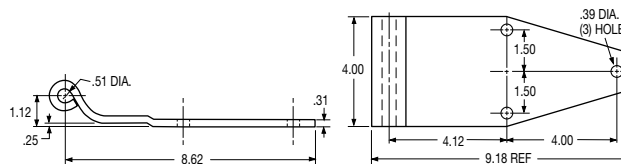

### SPECIFICATIONS

part no.	weight (lbs.)	recommended hinge pin	package	pkg qty	cross reference
022-00030	3.34	997-98017 021-00376	single	1	American #4-18-0055, Eberhard #5897, Miller #B17-0116C, Timpte #5897-2

SWING DOOR – BUTTS, HINGES & PINS

## Miner Style Five-Hole Hinge

### FEATURES

- Steel construction
- Zinc plated or hot-dipped galvanized finish

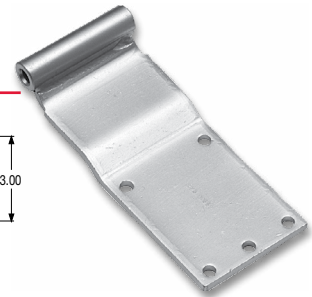
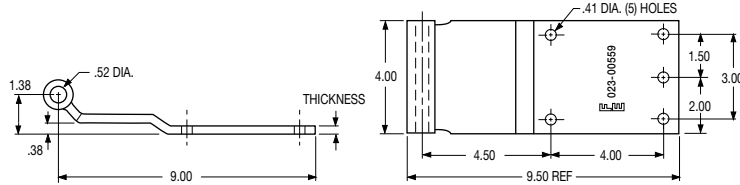

### SPECIFICATIONS

part no.	weight (lbs.)	thickness (in.)	finish	rec. hinge butt	rec. hinge pin	zerk fitting	package	pkg qty	cross reference
023-00559	3.70	.31	zinc	023-00664	997-98017	no	single	1	H-1060-3, H-1060-4
023-02009	3.70	.25	galvanized		997-98017	no	single	1	P108835, P108845, P108855

## Miner Style Three-Hole Hinges

### FEATURES

- Steel construction
- Zinc plated or hot-dipped galvanized finish
- Available with or without zerk fitting

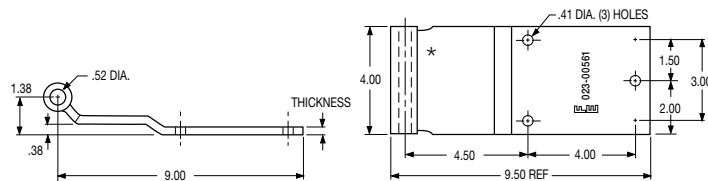

### SPECIFICATIONS

part no.	weight (lbs.)	thickness (in.)	mounting holes	finish	inserts	rec. hinge butt	rec. hinge pin	zerk fitting	package	pkg qty	cross reference
023-00561	3.10	.25	three	zinc	no	023-00664	997-98017	no	single	1	H-1081-3
023-01502	3.10	.25	three	zinc	no	023-00664	997-98017	yes	single	1	H-1081-3Z

## Monon Style Three-Hole Hinge

### FEATURES

- Aluminum extrusion

### ORDER DETAILS

- Orders in multiples of 10 shipped in shelf-ready box

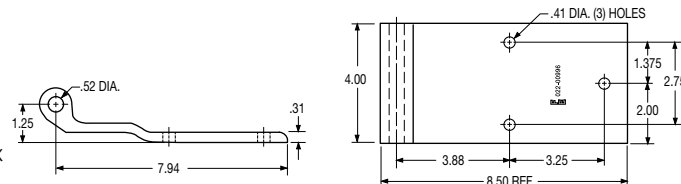

### SPECIFICATIONS

part no.	weight (lbs.)	package	pkg qty	cross reference
022-00996	1.33	single	1	Monon #PC1310

## Monon Style Three-Hole Hinge

### FEATURES

- Aluminum extrusion
- With insert

### ORDER DETAILS

- Orders in multiples of 10 shipped in shelf-ready box

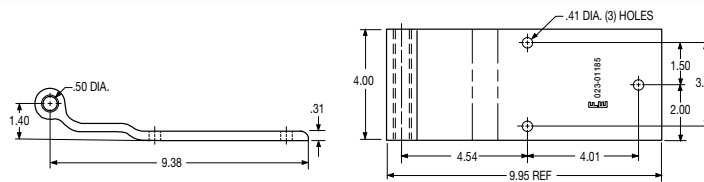

### SPECIFICATIONS

part no.	weight (lbs.)	package	pkg qty	cross reference
022-01185	1.32	single	1	Monon #ED045011

## Morgan Style Three-Hole Hinge (Dry Freight Rear Door)

### FEATURES

- Aluminum extrusion
- With Insert

### ORDER DETAILS

- Orders in multiples of 10 shipped in shelf-ready box

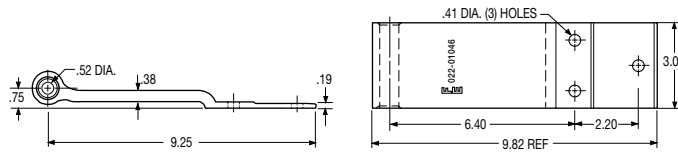

### SPECIFICATIONS

part no.	weight (lbs.)	package	pkg qty	cross reference
<b>022-01046</b>	1.02	single	1	Morgan #004161

## Morgan Style Three-Hole Hinge (Dry Freight Side Door)

### FEATURES

- Aluminum extrusion
- With insert

### ORDER DETAILS

- Orders in multiples of 10 shipped in shelf-ready box

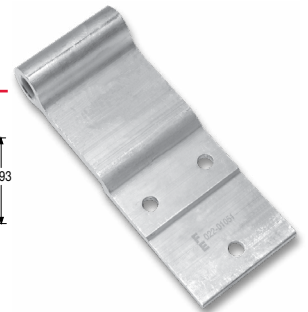
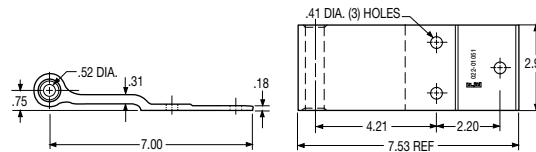

### SPECIFICATIONS

part no.	weight (lbs.)	package	pkg qty	cross reference
<b>022-01051</b>	.66	single	1	Morgan #004141

## Pines Style Three-Hole Hinge

### FEATURES

- Aluminum extrusion

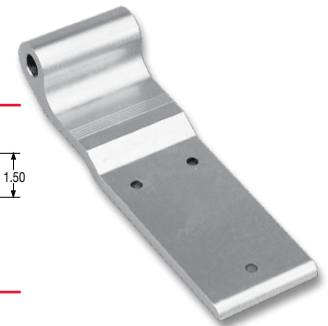
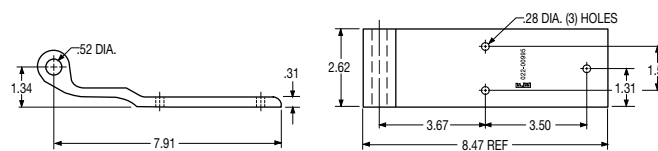

### SPECIFICATIONS

part no.	weight (lbs.)	package	pkg qty	cross reference
<b>022-00995</b>	.84	single	1	Pines #AE54111, REB-0395

## Stoughton Style Four-Hole Hinge

### FEATURES

- Aluminum extrusion
- With insert

### ORDER DETAILS

- Orders in multiples of 10 shipped in shelf-ready box

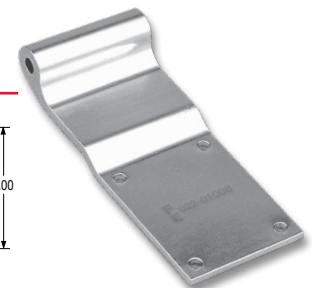
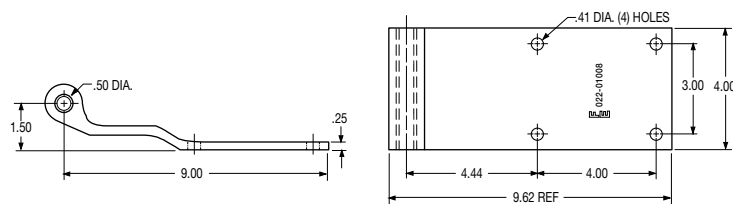

### SPECIFICATIONS

part no.	weight (lbs.)	recommended hinge pin	package	pkg qty	cross reference
<b>022-01008</b>	1.46	997-98017, 021-00376	single	1	Stoughton #04-08316-000-00

SWING DOOR – BUTTS, HINGES & PINS

## Stoughton Style Three-Hole Hinge

### FEATURES

- Aluminum extrusion
- With inserts that have "collars" - making it easier to open and close doors

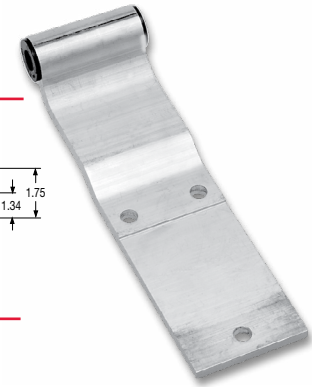
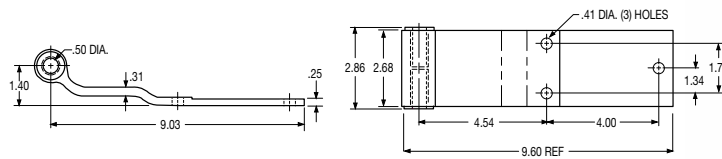

### SPECIFICATIONS

part no.	weight (lbs.)	package	pkg qty	cross reference
022-01081	.86	single	1	Stoughton #04-86386-001-00, #H-1086, #P108630

## Stoughton Style Five-Hole Hinge

### FEATURES

- Aluminum extrusion
- With inserts that have "collars" - making it easier to open and close doors
- Five hole design covers both three and four hole applications - reduces inventory

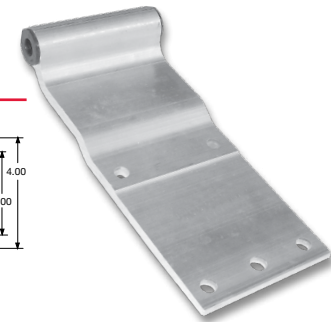
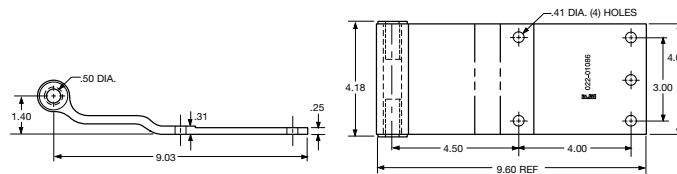

### ORDER DETAILS

- Orders in multiples of 10 shipped in shelf-ready box

### SPECIFICATIONS

part no.	weight (lbs.)	package	pkg qty	cross reference
022-01086	1.20	single	1	#P108530, #P108540, #H-1085

## Strick Style Four-Hole Hinge

### FEATURES

- Steel stamping
- Zinc plated finish

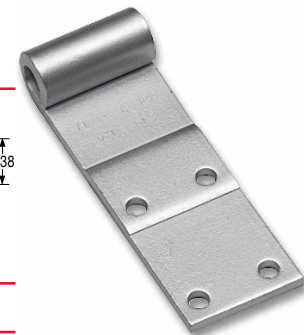
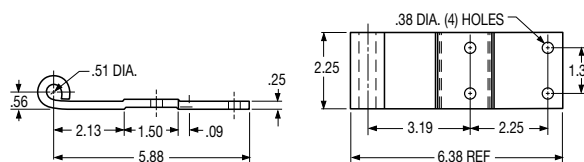

### SPECIFICATIONS

part no.	weight (lbs.)	package	pkg qty	cross reference
021-00010	1.20	single	1	Strick #6A-23557 and #AA35F00020100

## Strick Style Three-Hole Hinge (Offset)

### FEATURES

- Steel stamping
- Zinc plated finish

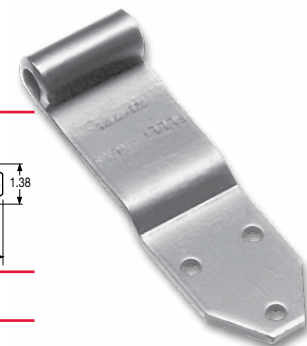
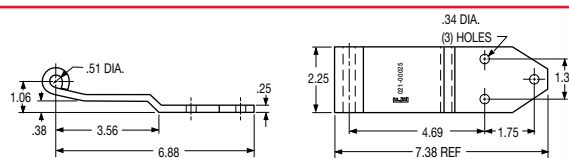

### SPECIFICATIONS

part no.	weight (lbs.)	package	pkg qty	cross reference
021-00025	1.30	single	1	Strick #AA35F00040100

## Strick Style Three-Hole Hinge (with Stamped Reinforcing Rib)

### FEATURES

- Steel construction
- Hot dip galvanized finish
- Stamped reinforcing rib

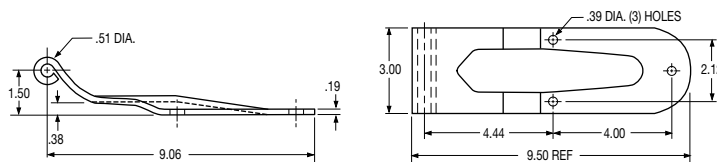

### SPECIFICATIONS

part no.	weight (lbs.)	recommended hinge butt	package	pkg qty	cross reference
022-00490	1.61	023-00642	single	1	Strick #AA33C01060100

## Strick Style Three-Hole Hinge

### FEATURES

- Aluminum extrusion
- With insert

### ORDER DETAILS

- Orders in multiples of 10 shipped in shelf-ready box

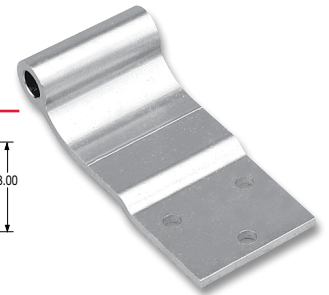
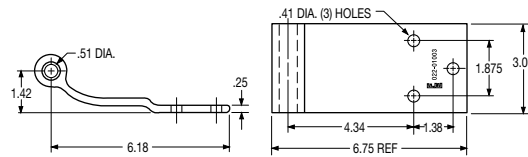

### SPECIFICATIONS

part no.	weight (lbs.)	package	pkg qty	cross reference
022-01003	.65	single	1	Strick #AA35F00100100

## Strick Style Four-Hole Hinge

### FEATURES

- Aluminum extrusion
- With insert

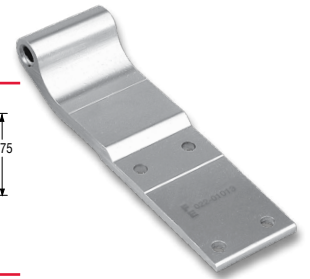
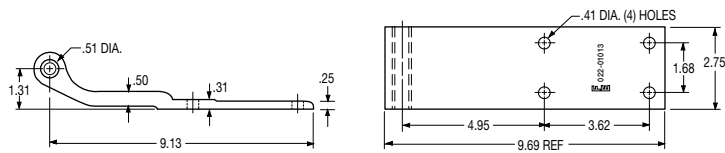

### SPECIFICATIONS

part no.	weight (lbs.)	package	pkg qty	cross reference
022-01013	1.13	single	1	Strick #AA35F00230100

## Trailmobile Style Three-Hole Hinge

### FEATURES

- Aluminum extrusion

### ORDER DETAILS

- Orders in multiples of 10 shipped in shelf-ready box

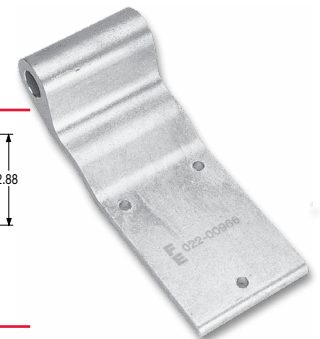
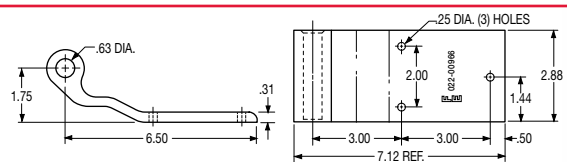

### SPECIFICATIONS

part no.	weight (lbs.)	recommended hinge butt	recommended hinge pin	package	pkg qty	cross reference
022-00966	.90	023-00678	997-98016	single	1	Trailmobile #515-10-65

SWING DOOR – BUTTS, HINGES & PINS

## Trailmobile Style Four-Hole Hinge

### FEATURES

- Aluminum extrusion

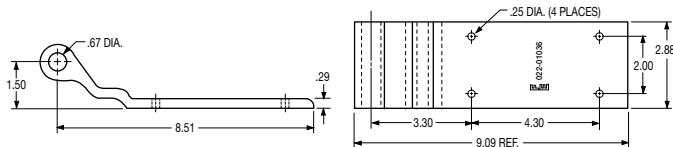

### SPECIFICATIONS

part no.	weight (lbs.)	recommended hinge pin	package	pkg qty	cross reference
<b>022-01036</b>	.91	997-98016	single	1	Trailmobile #515-10-78-1

## Trailmobile Style Three-Hole Hinge

### FEATURES

- Steel stamping
- Zinc plated finish

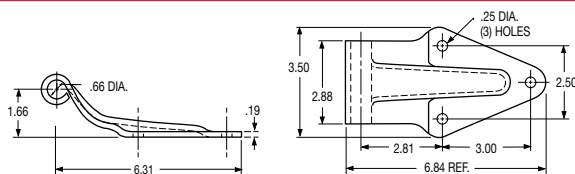

### SPECIFICATIONS

part no.	weight (lbs.)	recommended hinge butt	recommended hinge pin	package	pkg qty	cross reference
<b>023-00008</b>	1.20	023-00678	997-98016	single	1	Trailmobile #515-10-61A

## Trailmobile Style Three-Hole Hinge (Square End)

### FEATURES

- Steel stamping
- Zinc plated finish

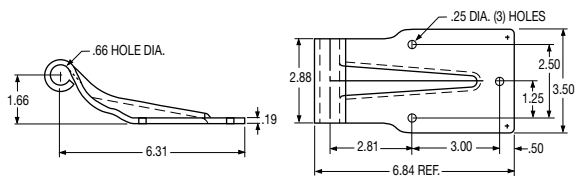

### SPECIFICATIONS

part no.	weight (lbs.)	recommended hinge butt	recommended hinge pin	package	pkg qty	cross reference
<b>023-00940</b>	1.40	023-00678	997-98016	single	1	Trailmobile #515-10-73A

## Utility Style Three-Hole Hinge

### FEATURES

- Aluminum hinge

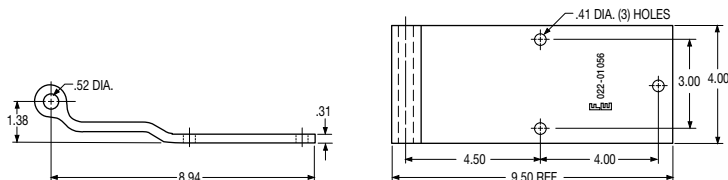

### SPECIFICATIONS

part no.	weight (lbs.)	recommended hinge pin	package	pkg qty	cross reference
<b>022-01056</b>	1.36	997-98017 or 997-98020	single	1	Utility #3410019

## Utility Style Three-Hole Hinge

### FEATURES

- Aluminum extrusion

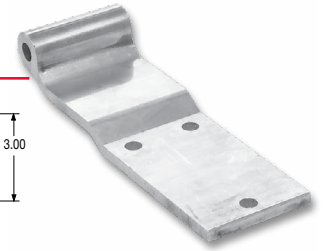
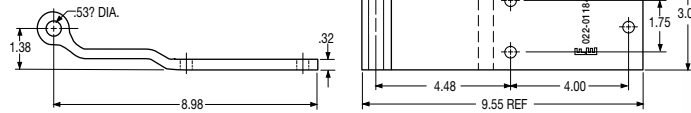

### SPECIFICATIONS

part no.	weight (lbs.)	package	pkg qty	cross reference
<b>022-01184</b>	1.07	single	1	Utility #3-4100-0022

## Utility Style Three-Hole Hinge

### FEATURES

- Steel construction
- Zinc plated finish
- Stamped reinforcing rib

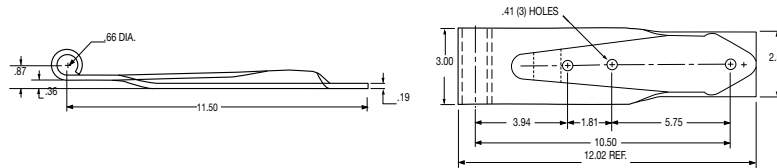

### SPECIFICATIONS

part no.	weight (lbs.)	recommended hinge pin	package	pkg qty	cross reference
<b>023-00943</b>	2.25	997-98019	single	1	Utility #1-4950-004

## Vanco Style Four-Hole Hinge

### FEATURES

- Aluminum Hinge

### ORDER DETAILS

- Orders in multiples of 10 shipped in shelf-ready box

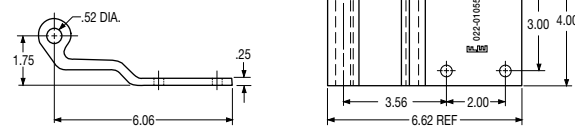

### SPECIFICATIONS

part no.	weight (lbs.)	recommended hinge pin	package	pkg qty	cross reference
<b>022-01055</b>	1.10	997-98017, 021-00376	single	1	Vanco #20038

## Vanguard Style Three-Hole Hinge

### FEATURES

- Aluminum extrusion

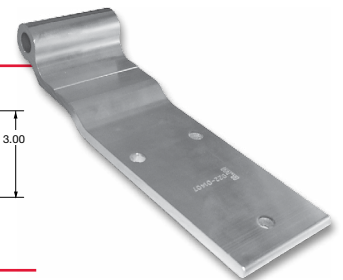
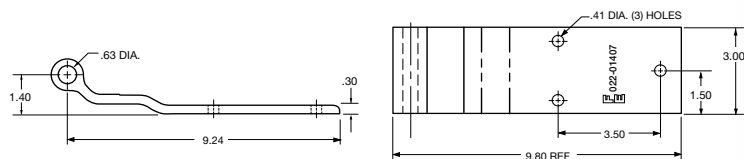

### SPECIFICATIONS

part no.	weight (lbs.)	description	package	pkg qty	cross reference
<b>022-01407</b>	1.00	hinge only	single	1	RFP00127
<b>022-01404</b>	.001	nylon insert only	single	1	BSH-0001

SWING DOOR – BUTTS, HINGES & PINS

## Wabash Style Four-Hole Hinge

### FEATURES

- Aluminum extrusion

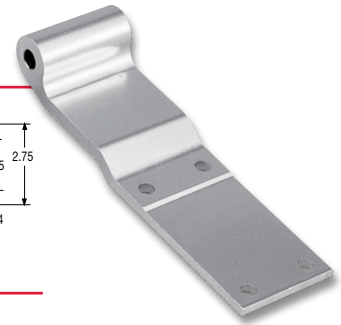
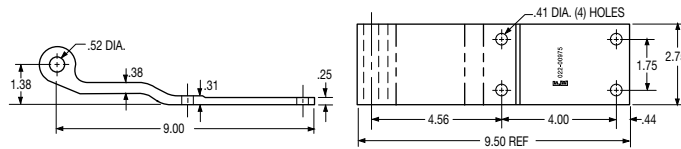

### SPECIFICATIONS

part no.	weight (lbs.)	recommended hinge butt	package	pkg qty	cross reference
022-00975	.86	023-00669, 021-00308	single	1	WABO6300291, Wabash #21100291

## Wabash Style Four-Hole Hinge (Reefer)

### FEATURES

- Aluminum extrusion

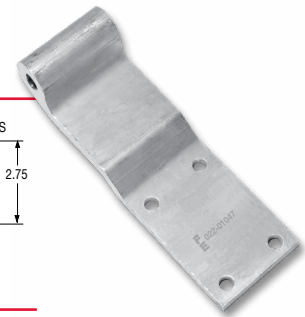
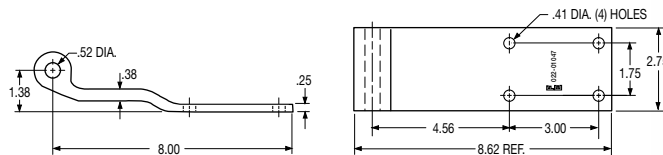

### SPECIFICATIONS

part no.	weight (lbs.)	recommended hinge butt	package	pkg qty	cross reference
022-01047	.96	023-00669, 021-00308	single	1	WABO6301272, Wabash #21101272

## Wabash Style Four-Hole Hinge

### FEATURES

- Aluminum extrusion
- With inserts that have "collars" - making it easier to open and close doors

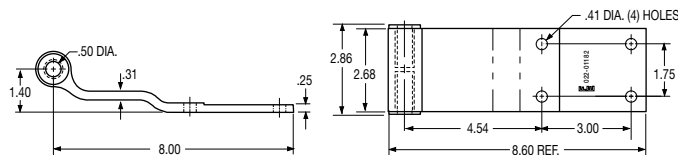

### SPECIFICATIONS

part no.	weight (lbs.)	recommended hinge butt	package	pkg qty	cross reference
022-01182	.78	023-00669, 021-00308	single	1	WABO6301527, WABO6302245, Miner #1089, Miner #P108940

## Dorsey Style Hinge Pin

### FEATURES

- Zinc plated finish
- End hole for cotter pin

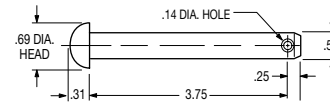

### SPECIFICATIONS

part no.	weight (lbs.)	dia. (in.)	length (in.)	recommended cotter pin	package	pkg qty	cross reference
997-98022	.25	.50	4.00	994-00105	single	1	Dorsey #5248614

## Fruehauf and Miner Style Hinge Pin

### FEATURES

- End hole for cotter pin

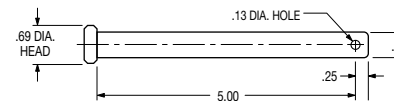

### SPECIFICATIONS

part no.	weight (lbs.)	description	dia. (in.)	length (in.)	recommended cotter pin	package	pkg qty	cross reference
997-98017	.31	zinc plated hinge pin	.50	5.25	994-00105	single	1	Fruehauf #WCE007812-001 Miner #HP-1054-4
997-98020	.30	stainless steel hinge pin	.50	5.25	994-00105	single	1	Miner #HP-1054-9

## Great Dane Style Hinge Pin (Round Head)

### FEATURES

- Zinc plated finish
- End hole for cotter pin

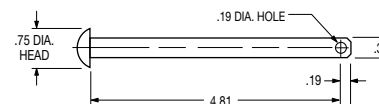

### SPECIFICATIONS

part no.	weight (lbs.)	dia. (in.)	length (in.)	recommended cotter pin	package	pkg qty	cross reference
997-98015	.17	.38	5.00	994-00105	single	1	Great Dane #44573

## Great Dane Style Hinge Pin

### FEATURES

- Zinc plated finish
- End hole for cotter pin

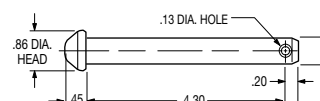

### SPECIFICATIONS

part no.	weight (lbs.)	dia. (in.)	length (in.)	recommended cotter pin	package	pkg qty	cross reference
997-98027	.29	.50	4.50	994-00105	single	1	Great Dane #3190100

SWING DOOR – BUTTS, HINGES & PINS

## Trailmobile Style Hinge Pin

### FEATURES

- Zinc plated finish
- End hole for cotter pin

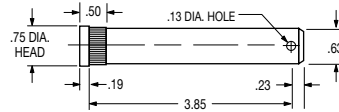

### SPECIFICATIONS

part no.	weight (lbs.)	dia. (in.)	length (in.)	recommended cotter pin	package	pkg qty	cross reference
997-98016	.37	.63	4.25	994-00105	single	1	Trailmobile #515-12-13

## Utility Style Hinge Pin

### FEATURES

- Zinc plated finish
- End hole for cotter pin

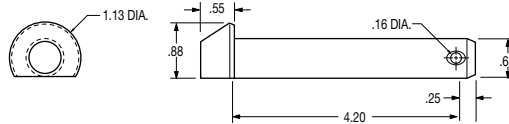

### SPECIFICATIONS

part no.	weight (lbs.)	dia. (in.)	length (in.)	recommended cotter pin	package	pkg qty	cross reference
997-98019	.44	.63	4.45	994-00105	single	1	Utility #3-6101-08, 3-6101-071

## Hinge Bolt-Pin Hardware Packaged Set

### FEATURES

- Steel construction
- Zinc plated finish
- Packaged Set includes one bolt, one nut, and four washers
- Bolt size is 1/2-13 x 5.50 long

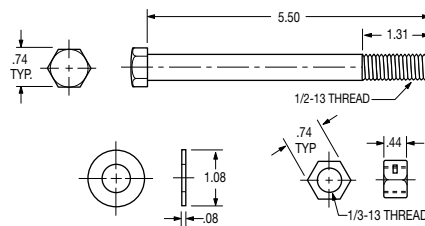

### SPECIFICATIONS

part no.	weight (lbs.)	package	pkg qty
021-00376	.42	packaged set	1

### 3.25" Narrow Butt Hinge Assembly

#### FEATURES

- Steel construction, plain finish
- Includes removable pin using nut, bolt, and thrust washers

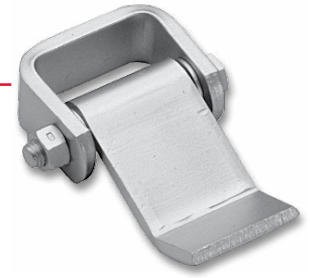
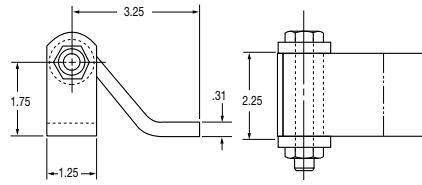

#### SPECIFICATIONS

part no.	weight (lbs.)	mount type	package	pkg qty	cross reference
<b>021-00181</b>	2.20	flush weld-on	single	1	Austin #AH-001

### 5.00" Square Butt Hinge Assembly

#### FEATURES

- Stamped steel construction
- Zinc plated finish
- Stamped reinforcing rib
- Non-removable steel pin and nylon sleeve bearings

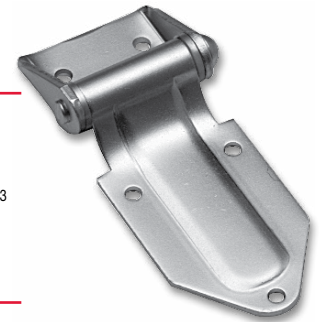
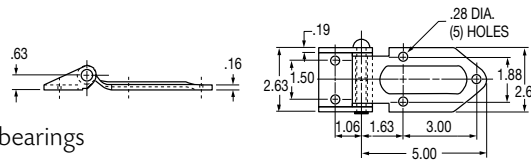

#### SPECIFICATIONS

part no.	weight (lbs.)	mount type	description	package	pkg qty	cross reference
<b>022-00631</b>	1.00	flush	left hand	single	1	Eberhard #5867
<b>022-00633</b>	1.00	flush	right hand	single	1	Eberhard #5867

### 8.00" Embossed Hinge Assembly (with Stamped Reinforcing Rib)

#### FEATURES

- Steel construction, zinc plated finish
- Stamped reinforcing rib
- Made with hardened steel truss bearings to effectively carry door loads
- Includes removable pin using nut, bolt, and thrust washers

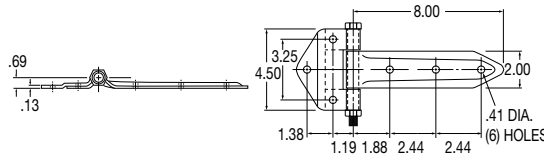

#### SPECIFICATIONS

part no.	weight (lbs.)	mount type	package	pkg qty	cross reference
<b>022-00605</b>	1.70	flush	single	1	Eberhard #1-5869 zinc, Polar #2008R

SWING DOOR – BUTTS, HINGES & PINS

## 8.00" Square Butt Leaf Hinge Assemblies

### FEATURES

- Stainless steel construction with spot welded leaves and thrust washers
- Polished finish
- .34" round hole
- Minimum order of 100 required

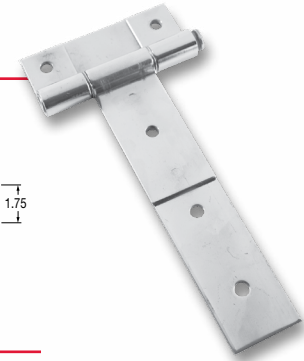
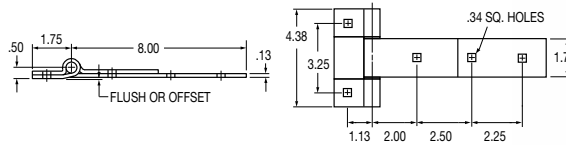

### SPECIFICATIONS

part no.	weight (lbs.)	mount type	hole type	pin	package	pkg qty	construction
022-00808	1.49	flush	round	removable	single	1	polished stainless steel

## 9.00" Narrow Butt Hinge Assemblies (with Embossed Rib)

### FEATURES

- Heavy-duty steel construction
- Zinc plated finish
- Includes nut, bolt, and thrust washers

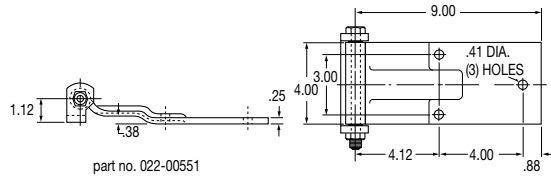

### SPECIFICATIONS

part no.	weight (lbs.)	mount type	hinge end type	package	pkg qty	cross reference
022-00551	4.10	flush w/ embossed rib (3-hole)	rolled	single	1	#A1-5884-U flush, zinc; #N1809-003B

## 9.00" Narrow Butt Hinge Assemblies (Miller Style)

### FEATURES

- Heavy-duty steel construction
- Zinc plated finish
- Includes nut, bolt, and thrust washers

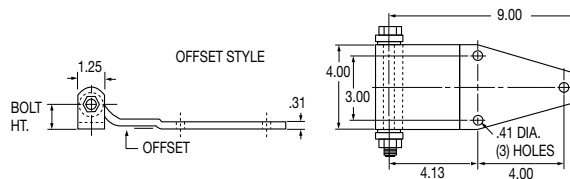

### SPECIFICATIONS

part no.	weight (lbs.)	offset dim.	bolt height	package	pkg qty	cross reference
022-00545	4.70	.62 offset	1.75	single	1	Austin #9-5
022-00830	4.48	flush	1.12	single	1	Austin #9-5