

# PrecisionTrak™

## Recessed or Flush Mount Wood Roll-Up Doors

From start to finish, the exacting standards of all PrecisionTrak wood roll-up doors are what set them apart from the competition. These economical roll-up doors are available in both **flush hinge with 2" rollers** and **recessed hinge with 1" rollers** and are manufactured with 3/4", 7-ply, transportation-grade, hardwood faced plywood.

**PrecisionTrak™**  
RECESSED 1" ROLLER



**PrecisionTrak™**  
FLUSH MOUNT 2" ROLLER



PRECISIONTRAK ROLL-UP DOORS

### FEATURES

- Available in universal trim-to-fit or custom sizes fully assembled ready to install
- Standard finishes: white primed ready-to-paint and pre-painted white with durable clear UV finish. Custom colors are available with minimum order requirements
- Routed interlocking tongue and groove panels provide precise alignment and moisture barrier
- Aluminum head seal retainer with removable rubber seal

#### RECESSED 1" Roller Wood Roll-Up Door

- Steel rollers for use with 1" track
- Zinc-plated spring assisted steel lock eliminates door bounce
- Galvanized bottom seal retainer with 2 point contact rubber seal
- Zinc-plated hinges are recessed, reducing freight hang-up
- Corrosion resistant stainless steel 7 x 19 cables, 1/4 nylon eye
- Zinc-plated heavy-duty lift handle, and 18" pull strap assembly

#### FLUSH MOUNT 2" Roller Wood Roll-up Door

- Nylon rollers for use with 2" track
- RoadKote spring assisted steel lock eliminates door bounce
- Aluminum bottom seal retainer with flexible PVC 3 point seal
- End hinges with removable covers to allow easy roller replacement
- Corrosion resistant stainless steel 7 x 19 cables, 5/16 aluminum eye
- RoadKote heavy-duty lift handle, and 18" pull strap assembly

### Door Height and Panel Size

#### PrecisionTrak Recessed Doors

Door Height	Bottom Panel	Intermediate Panels	Top Panel
75"	15.00"	(4) 12"	12.00"
80"	15.00"	(2) 15"	11.00"
85"	12.00"	(4) 15"	13.00"
90"	15.00"	(4) 15"	15.00"
95"	15.00"	(2) 15"	(3) 12.00"
96"	15.00"	(3) 15"	(2) 12.00"
100"	15.00"	(5) 15"	10.00"
105"	15.00"	(5) 15"	15.00"
110"	15.00"	(3) 15"	(3) 12.00"
114"	15.00"	(4) 15"	(2) 12.00"

### Door Height and Panel Size

#### PrecisionTrak Flushmount Doors

Door Height	Bottom Panel	Intermediate Panels	Top Panel
75"	15.50"	(3) 15.50"	13.00"
80"	15.50"	(2) 15.50"	(2) 11.50"
85"	15.50"	(3) 15.50"	(1) 11.50"
90"	15.50"	(4) 15.50"	12.50"
95"	15.50"	(3) 15.50"	(2) 11.50"
96"	15.50"	(3) 15.50"	(2) 11.50"
100"	15.50"	(4) 15.50"	(1) 11.50"
105"	15.50"	(5) 15.50"	12.00"
110"	15.50"	(3) 15.50"	(3) 11.50"
114"	15.50"	(4) 15.50"	(2) 11.50"

**NEED A FULLY ASSEMBLED DOOR MADE TO YOUR EXACT SIZE SPECIFICATIONS?**

Please call our Customer Service Team or visit DOOR SYSTEMS on our website

**ORDER DETAILS**

- Recessed Version: Installed components on the door includes handle, pull strap, and bottom seal and retainer. Loose components include lock, keeper, cable anchor brackets, cables, rollers, head seal and retainer, and associated hardware.
- Flush Mount Version: Installed components on the door includes handle, pull strap, and bottom seal and retainer. Loose components include, cable anchor brackets, cables, lock, keeper, rollers, head seal and retainer, latch plate, top fixture brackets, rubber door stop set, and associated hardware.
- Available with or without track and operator
- Select from standard products below or visit website for custom door order form
- For pre-painted white with durable clear UV finish, add "W" at the end of the part number (Example: 029-09090W)

**SPECIFICATIONS FOR RECESSED MOUNT 1" ROLLER WOOD ROLL-UP DOOR**

part no.	weight (lbs.)	width (in.)	height (in.)	track/operator	package	pkg qty	cross reference
<b>029-90090</b>	188.00	90.00	90.00	n/a	packaged set	1	-
<b>029-90100</b>	202.00	90.00	100.00	n/a	packaged set	1	-
<b>029-90105</b>	208.00	90.00	105.00	n/a	packaged set	1	-
<b>029-90112</b>	218.00	90.00	112.00	n/a	packaged set	1	-
<b>029-98090</b>	204.00	98.00	90.00	n/a	packaged set	1	W General Purpose
<b>029-98100</b>	219.00	98.00	100.00	n/a	packaged set	1	T #99836-2, W General Purpose
<b>029-98105</b>	227.00	98.00	105.00	n/a	packaged set	1	T #99837-2, W General Purpose
<b>029-98107</b>	230.00	98.00	107.00	n/a	packaged set	1	W General Purpose
<b>029-98112</b>	238.00	98.00	112.00	n/a	packaged set	1	T #99838-2, W General Purpose

**1" ROLLER WOOD DOOR WITH TRACK AND OPERATOR**

- 6" radius 1" track and single counterbalanced spring operator for quick, easy adjustment with grooved cable drums to prevent cables from binding or wearing prematurely

part no.	weight (lbs.)	width (in.)	height (in.)	track/operator	package	pkg qty	cross reference
<b>029C90090</b>	267.00	90.00	90.00	included	bulk set	1	-
<b>029C90100</b>	286.00	90.00	100.00	included	bulk set	1	-
<b>029C90105</b>	297.00	90.00	105.00	included	bulk set	1	-
<b>029C90112</b>	307.00	90.00	112.00	included	bulk set	1	-
<b>029C98090</b>	283.00	98.00	90.00	included	bulk set	1	T #99835-1
<b>029C98100</b>	303.00	98.00	100.00	included	bulk set	1	T #99836-1
<b>029C98105</b>	316.00	98.00	105.00	included	bulk set	1	T #99837-1
<b>029C98107</b>	319.00	98.00	107.00	included	bulk set	1	-
<b>029C98112</b>	327.00	98.00	112.00	included	bulk set	1	T #99838-1

**SPECIFICATIONS FOR FLUSH MOUNT 2" ROLLER WOOD ROLL-UP DOOR**

part no.	weight (lbs.)	width (in.)	height (in.)	track/operator	package	pkg qty
<b>029-90290</b>	190.00	90.00	90.00	n/a	packaged set	1
<b>029-90200</b>	204.00	90.00	100.00	n/a	packaged set	1
<b>029-90205</b>	210.00	90.00	105.00	n/a	packaged set	1
<b>029-90212</b>	220.00	90.00	112.00	n/a	packaged set	1
<b>029-98290</b>	204.00	98.00	90.00	n/a	packaged set	1
<b>029-98200</b>	219.00	98.00	100.00	n/a	packaged set	1
<b>029-98205</b>	227.00	98.00	105.00	n/a	packaged set	1
<b>029-98207</b>	230.00	98.00	107.00	n/a	packaged set	1
<b>029-98212</b>	238.00	98.00	112.00	n/a	packaged set	1

**2" ROLLER WOOD DOOR WITH TRACK AND OPERATOR**

- 8" radius 2" track, dual spring operator assembly with grooved cable drums to prevent cables from binding or wearing prematurely. Dual durometer side seals are included.

<b>029C90290</b>	269.00	90.00	90.00	included	bulk set	1
<b>029C90200</b>	288.00	90.00	100.00	included	bulk set	1
<b>029C90205</b>	299.00	90.00	105.00	included	bulk set	1
<b>029C90212</b>	309.00	90.00	112.00	included	bulk set	1
<b>029C98290</b>	283.00	98.00	90.00	included	bulk set	1
<b>029C98200</b>	303.00	98.00	100.00	included	bulk set	1
<b>029C98205</b>	316.00	98.00	105.00	included	bulk set	1
<b>029C98207</b>	319.00	98.00	107.00	included	bulk set	1
<b>029C98212</b>	327.00	98.00	112.00	included	bulk set	1

**PRECISIONTRAK ROLL-UP DOORS**

**PrecisionTrak Recessed 1" Roller Wood Roll-up Door**

**PRECISIONTRAK ROLL-UP DOORS**

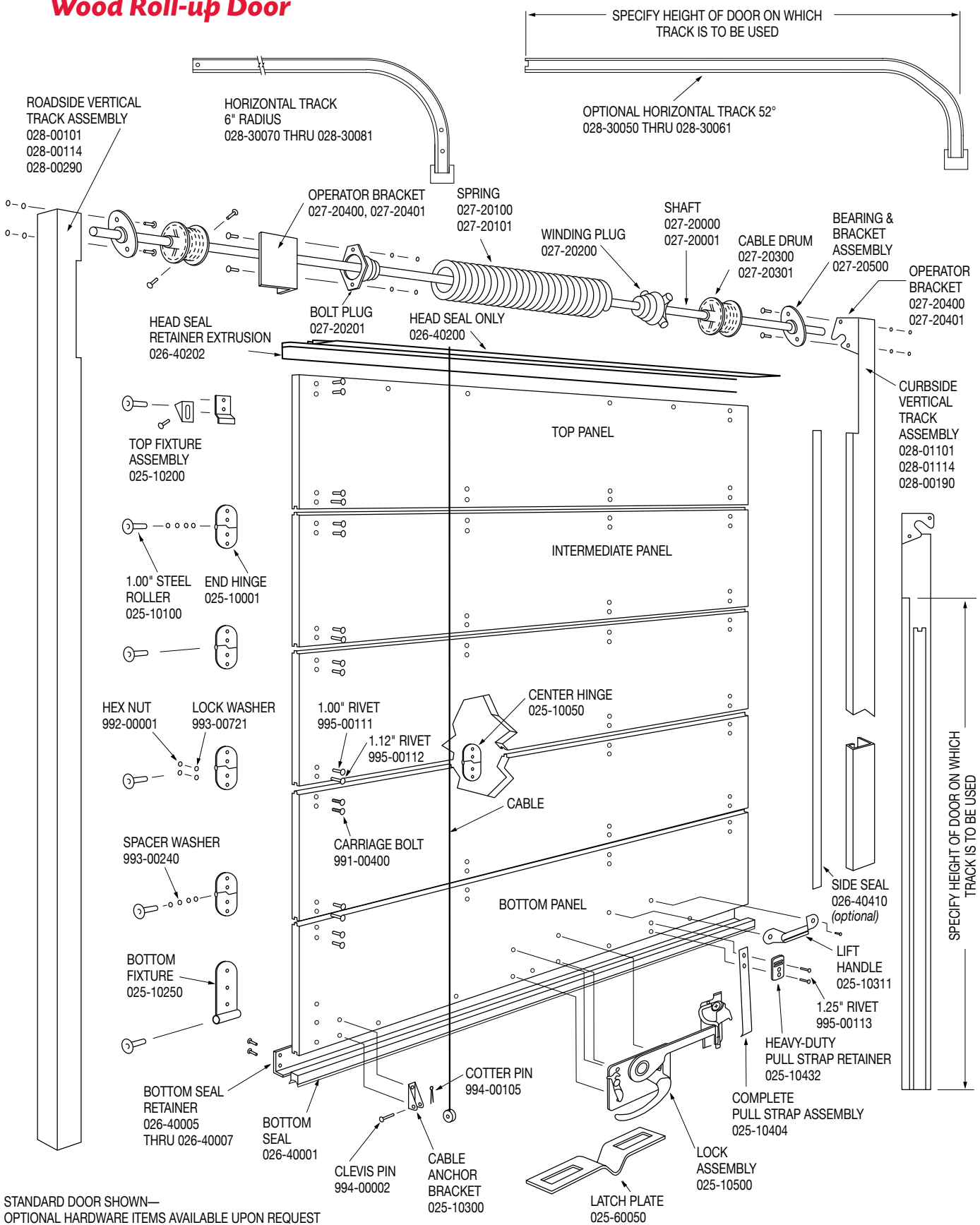

# PrecisionTrak Flush Mount 2" Roller Wood Roll-up Door

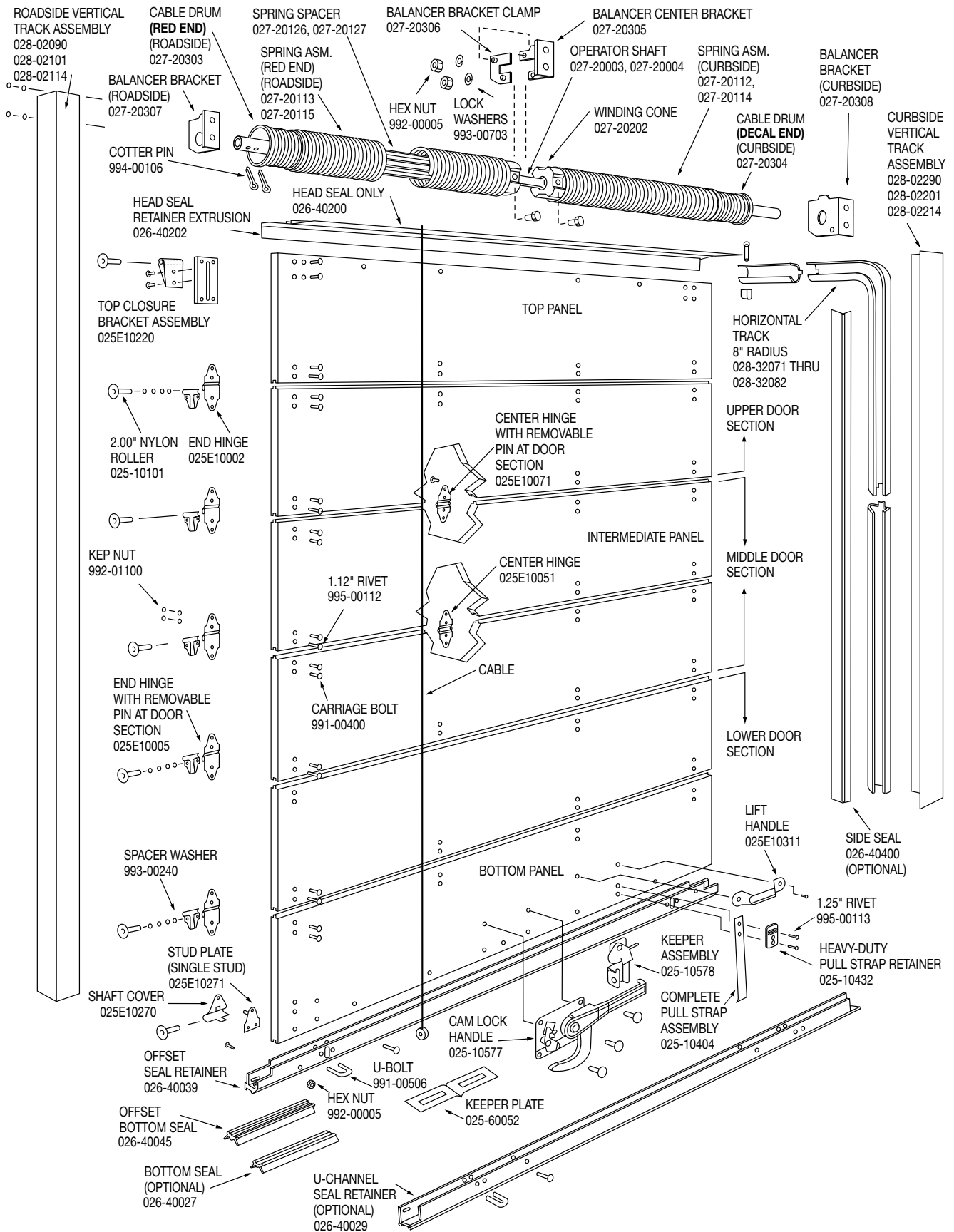

PRECISIONTRAK ROLL-UP DOORS

# ToughTrak™

## Steel Clad Roll-Up Door

Every ToughTrak door is engineered and manufactured to stand up to impact without deformation. Panels are abrasion resistant with an excellent performance-to-weight ratio. These doors are the most durable you'll find on the marketplace today and the galvanized steel skins are finished with automotive coatings that are easily cleaned. They stand up against salted winter roads and the hottest summer days. Even the hardware is tough – an extra row of reinforced, dual-coated hinges are the backbone of every ToughTrak door.



TOUGHTRAK ROLL-UP DOORS

### FEATURES

- 1/2" thick (13mm) composite panel consisting of a high density polyethylene (HDPE) core between two galvanized steel skins
- Baked on white enamel finish
- RoadKote/powdercoat spring assisted steel lock eliminates door bounce
- One-piece extruded rubber head seal
- Tongue and groove joints
- Stainless steel rivets/RoadKote/powder coated components
- Nylon rollers for use with 2" track
- One-piece flexible PVC bottom seal
- End hinges have removable covers to allow easy roller replacement
- Designed for use with dual spring operator

### Door Height and Panel Size

#### ToughTrak Doors

Door Height	Bottom Panel	Intermediate Panels	Top Panel
75"	15.00"	(4) 12.00"	12.00"
80"	15.00"	(2) 15.00" (2) 12.00"	11.00"
85"	15.00"	(4) 15.00"	10.00"
90"	15.00"	(4) 15.00"	15.00"
95"	15.00"	(3) 15.00" (2) 12.00"	11.00"
96"	15.00"	(3) 15.00" (2) 12.00"	12.00"
100"	15.00"	(5) 15.00"	10.00"
105"	15.00"	(5) 15.00"	15.00"
110"	15.00"	(4) 15.00" (2) 12.00"	11.00"
114"	15.00"	(5) 15.00" (1) 12.00"	12.00"

**TOUGHTRAK DOORS ARE MADE TO YOUR EXACT SIZE SPECIFICATIONS,**

Please call our Customer Service Team or visit [DOOR SYSTEMS](http://DOOR SYSTEMS) on our website

**ToughTrak Steel Clad Roll-Up Door**

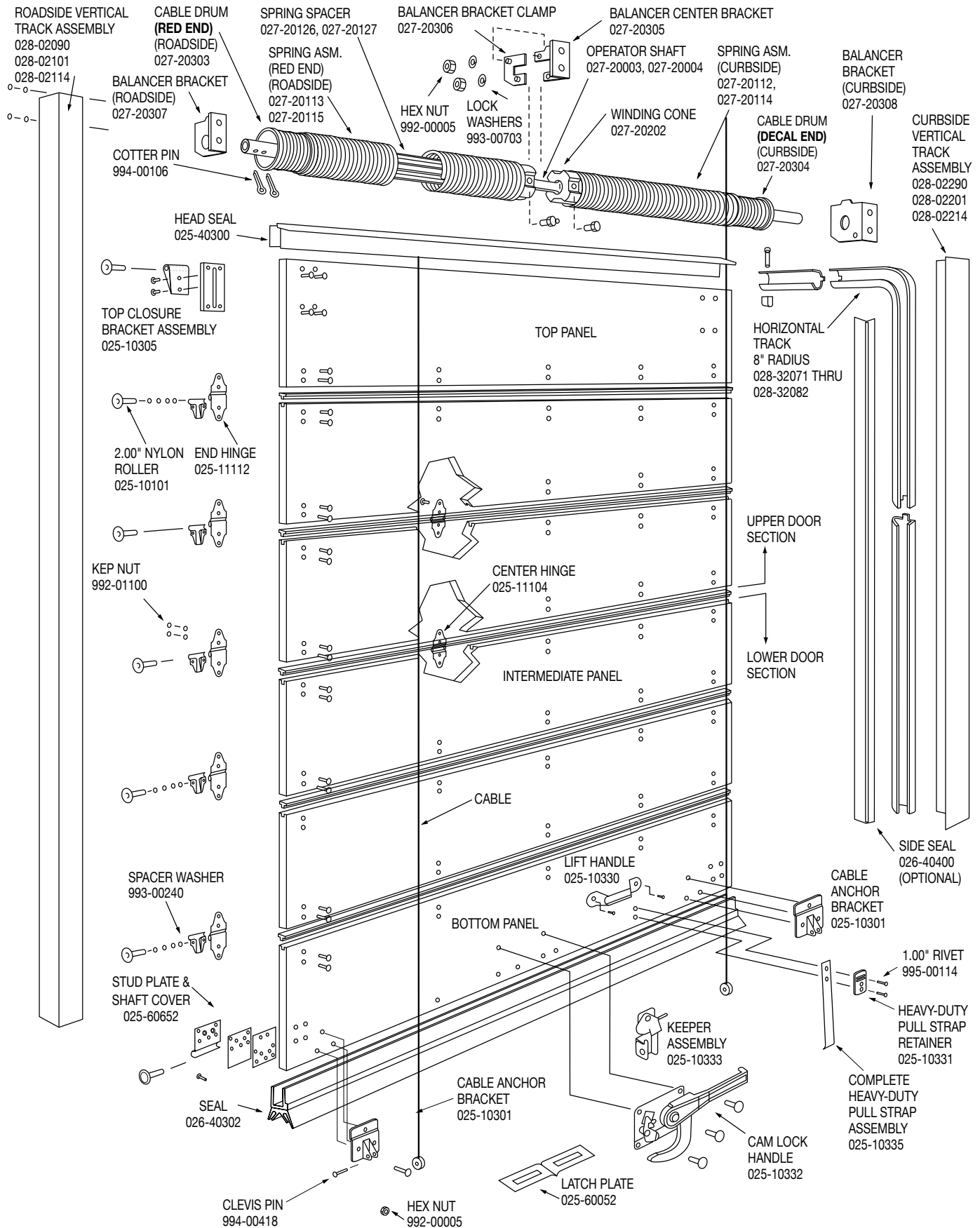

TOUGHTRAK ROLL-UP DOORS

# PolyTrak™

## Polypropylene Roll-Up Door

PolyTrak roll-up doors are our lightest and most moisture resistant option, ideal for units that must be cleaned on a regular basis, or wherever reducing weight is important. Panels do not absorb moisture keeping weight consistent throughout the life of the door, requiring fewer counterbalance adjustments and overall maintenance.



POLYTRAK ROLL-UP DOORS

### FEATURES

- Highly engineered panels are ribbed on the inside of the door for strength
- Galvanized steel channels reinforce every PolyTrak panel for stability
- Interchangeable with 2" rollers, flush mount hinges, and other industry standard components
- Polymer panels do not corrode, absorb moisture, or break down
- Light-weight panels
- Rivets are not exposed on the outside center of the door, leaving a smooth surface eliminating unsightly rust streaks, increasing brand image
- Panels are UV stabilized for a consistent color throughout the life of the door
- Weight stays consistent throughout the life of the door

### Door Height and Panel Size

#### PolyTrak Doors

Door Height	Bottom Panel	Intermediate Panels	Top Panel
75"	15.00"	(4) 12.00"	12.00"
80"	15.00"	(2) 15.00" (2) 12.00"	11.00"
85"	15.00"	(4) 15.00"	10.00"
90"	15.00"	(4) 15.00"	15.00"
95"	15.00"	(3) 15.00" (2) 12.00"	11.00"
96"	15.00"	(3) 15.00" (2) 12.00"	12.00"
100"	15.00"	(5) 15.00"	10.00"
105"	15.00"	(5) 15.00"	15.00"
110"	15.00"	(4) 15.00" (2) 12.00"	11.00"
114"	15.00"	(5) 15.00" (1) 12.00"	12.00"

**POLYTRAK DOORS ARE MADE TO YOUR EXACT SIZE SPECIFICATIONS,**

Please call our Customer Service Team or visit [DOOR SYSTEMS](http://DOOR SYSTEMS) on our website

**PolyTrak Roll-Up Doors**

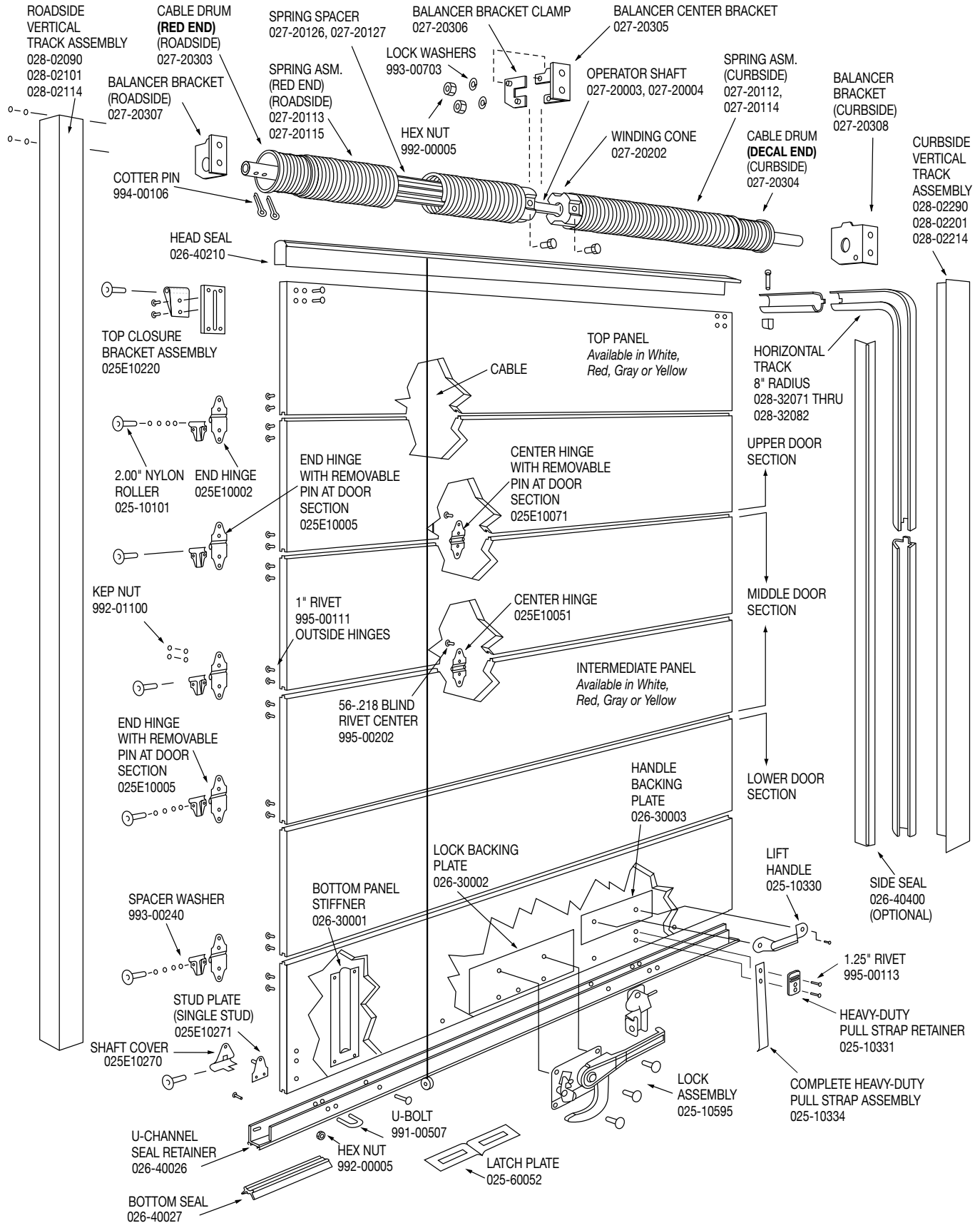

POLYTRAK ROLL-UP DOORS