

01 AIR OPERATED OIL PUMPS AND KITS

AIR OPERATED OIL PUMPS	6
PUMPMASTER 2 - 1:1 RATIO OIL PUMPS	8
PUMPMASTER 2 - 1:1 RATIO PUMP OIL PACKAGES	9
PUMPMASTER 2 - 3:1 RATIO OIL PUMPS	10
PUMPMASTER 2 - 3:1 RATIO PUMP PACKAGES	11
PUMPMASTER 4 - 3:1 RATIO OIL PUMPS	14
PUMPMASTER 4 - 5:1 RATIO OIL PUMPS	15
PUMPMASTER 4 - 3:1 AND 5:1 RATIO PUMP PACKAGES	16
PUMPMASTER 35 - 5:1 RATIO OIL PUMPS	17
PUMPMASTER 35 - 8:1 RATIO OIL PUMPS	18
PUMPMASTER 35 - 5:1 AND 8:1 RATIO PUMP PACKAGES	19
PUMPMASTER 45 - 3:1 RATIO OIL PUMP	20
PUMPMASTER 45 - 6:1 RATIO OIL PUMP	21
PUMPMASTER 45 - 10:1 RATIO OIL PUMPS	22
PUMPMASTER 60 - 6:1 RATIO OIL PUMP	23
PUMPMASTER 60 - 12:1 RATIO OIL PUMP	24
OIL PUMP ACCESSORIES	25



AIR OPERATED OIL PUMPS

It all starts with the pump; the heart of the system. The choice of a pump requires considering a wide variety of factors so that your system will provide years of dependable service. SAMSON has engineered a broad offering of oil pumps to handle a wide variety of applications. This range of pumps will fit original containers of different sizes and bulk storage tanks; covering applications that range from the transfer of oil to very large centralized systems.

PRESSURE AND VOLUME

An important, and often confusing, aspect of selecting a pump is how to determine which pump ratio and what pump size to select. The pump ratio is calculated by dividing the surface area of the air motor piston by the surface area of the fluid piston. The maximum pressure at the pump outlet is determined by multiplying the air inlet pressure by the pump pressure ratio. Restrictions such as the pipe length and diameter, hoses, hose reels, solenoid valves, pulse meters, control handles, and other system components create friction in the system. Sufficient fluid pressure is needed to overcome this friction, in order to get the required volume of oil to each dispense point.

Pump size determines the amount of fluid flowing through the piston pump outlet during each cycle of the pump. Three different sizes of pumps, with the same ratio, will each deliver a different flow rate. It is important to consider a variety of factors (number of dispense points, desired delivery, product dispensed...) in choosing the proper pump size for your system.

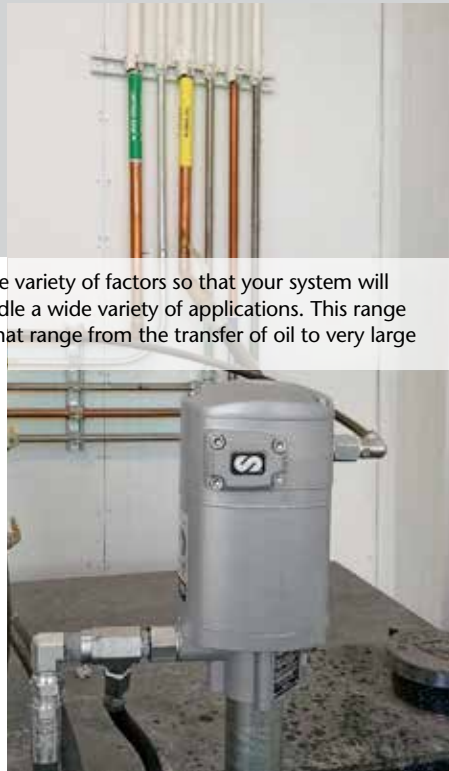

PUMP MASTER®

Maximum line length and number of simultaneous dispense points also depends on the line diameter, fluid viscosity and required delivery.



	PUMPMASTER 2 1:1	PUMPMASTER 2 3:1	PUMPMASTER 4 3:1	PUMPMASTER 4 5:1	PUMPMASTER 35 5:1	PUMPMASTER 35 8:1
PUMP DESCRIPTION	Utility Transfer	Utility Medium Pressure	Standard Duty Medium Pressure	Standard Duty Medium Pressure	Heavy-Duty Medium Pressure	Heavy-Duty High Pressure
SIMULTANEOUS OPERATION OUTLETS	1 (no reels)	1	1 to 2	1 to 2	1 to 3	1 to 2
MAX. LINE LENGTH	100' - 30 m	200' - 60 m	200' - 60 m -	500' - 150 m	500' - 150 m	650' - 200 m
APPLICATION	Service shops In-plant oil transfer Agriculture Marine	Auto dealers Service shops Fast lube centers Agriculture Marine	Auto dealers Service shops Fleet service Fast lube centers In-plant	Auto and truck dealers Fleet service Marine In-plant	Auto and truck dealers Fleet service Mining and construction Lube trucks Railroad and mass transit Marine In-plant	Vehicle maintenance Fleet service Marine Mining and construction Lube truck



PM45 HEAVY-DUTY SERIES

PM60 HEAVY-DUTY SERIES



PUMPMASTER 45 3:1	PUMPMASTER 45 6:1	PUMPMASTER 45 10:1	PUMPMASTER 60 6:1	PUMPMASTER 60 12:1
Heavy-Duty Volume Transfer	Heavy-Duty High Flow	Heavy-Duty Pressure Flow	Heavy-Duty High Delivery	Heavy-Duty High Performance
3 to 4	3 to 4	3 to 4	3 to 4	3 to 4
250' - 75 m	525' - 160 m	800' - 250 m	525' - 160 m	800' - 250 m
Construction equipment Mining equipment Large fleets Railroad and mass transit Marine In-plant oil distribution	Large auto and truck dealers Construction equipment Mining equipment Railroad and mass transit Large fleets Lube trucks Marine In-plant oil distribution	Large auto and truck dealers Construction equipment Mining equipment Railroad and mass transit Large fleets Lube trucks Marine In-plant oil distribution	Very large auto and truck dealers Construction equipment Mining equipment Large fleets Railroad and mass transit Marine In-plant oil distribution	Very large auto and truck dealers Construction equipment Mining equipment Large fleets Railroad and mass transit Marine In-plant oil distribution

PUMPMASTER 2 - 1:1 RATIO OIL PUMPS

200 SERIES

TRANSFER PUMPS

Double acting air operated low pressure pumps for transferring lubricants. Pumps include height adjustable 2" NPTM bung adaptor for tank or drum bung mounting.



FLUIDS HANDLED

- Synthetic and mineral based oil.
- Transmission fluid.
- Hydraulic oil.

MARKETS SERVED

- Service shops.
- In plant oil transfer.
- Agriculture.
- Marine.
- Mining and construction.

MODELS		
PART No.	APPLICATION	WEIGHT
351 120	Universal stub pump with bung adaptor	5.5 lb (2,5 kg)
356 120	16 gal (60 l) keg bung mounted with bung adaptor	10.6 lb (4,8 kg)
352 120	55 gal (205 l) drum bung mounted with bung adaptor	12 lb (5,4 kg)

TECHNICAL DATA PRESSURE RATIO 1:1	
Air pressure operating range	20 to 140 psi (1,5 - 10 bar)
Air consumption (1)	5.30 scfm (150 NL/min)
Maximum fluid outlet pressure	140 psi (10 bar)
Air motor diameter	2" (51 mm)
Air motor effective diameter	1 1/2" (35 mm)
Air motor stroke	3" (75 mm)
Delivery at 150 cpm	5.3 US gpm (20 l/min)
Maximum free flow delivery (2)	13.7 US gpm (52 l/min)
Air inlet	1/4" NPTF
Fluid inlet (stub pump only)	1" NPTF
Fluid outlet	3/4" NPTF
Wetted and seal materials	Aluminum / Steel / NBR / Acetal / Polyurethane
Noise level (3)	80 dB
Manual	835 808

DIMENSIONS Inches - (mm)			
PART No.	351 120	356 120	352 120
A	19 3/4" (500)	39 3/4" (1.010)	47 1/4" (1.200)
B	11 1/4" (285)	11 1/4" (285)	11 1/4" (285)
C	2" (52)	2" (52)	2" (52)
D	8 1/2" (215)	28 1/2" (725)	36" (915)

- (1) Air consumption with 90 psi (6 bar) air inlet pressure and 150 cycles per minute.
 (2) Maximum free delivery at 100 psi (7 bar).
 (3) Maximum noise level measured at 3' (1 m) from the pump, 100 psi (7 bar) air pressure and free delivery.

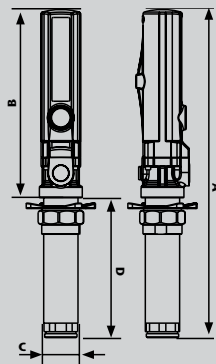

SAE 30 - 68 °F (20 °C) CAPACITY CURVE

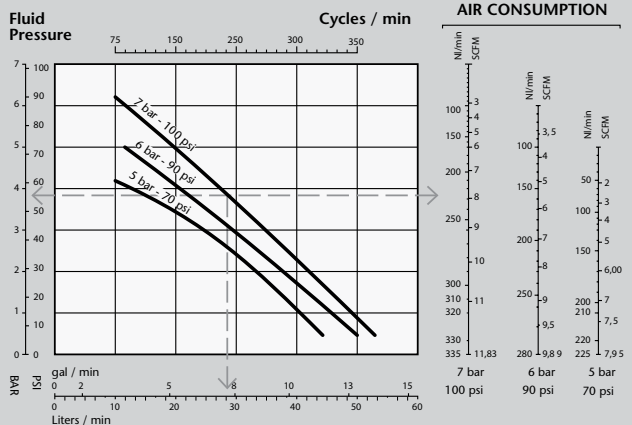

PUMPMASTER 2 - 1:1 RATIO PUMP OIL PACKAGES



PUMPMASTER 2 - 1:1 PUMP PACKAGES

Part No. 230

PumpMaster 2 1:1 ratio pump package (stub).

Includes the following:

Part No. 351 120 PumpMaster 2 - 1:1 ratio pump with bung bushing.

Part No. 904 Connecting hose hook-up kit.

Part No. 226

PumpMaster 2 1:1 ratio pump package for 16 gal bushing.

Includes the following:

Part No. 356 120 PumpMaster 2 - 1:1 ratio pump with bung bushing.

Part No. 904 Connecting hose hook-up kit.

Part No. 228

PumpMaster 2 1:1 pump package for 55 gal drums.

Includes the following:

Part No. 352 120 PumpMaster 2 - 1:1 ratio pump with bung bushing.

Part No. 904 Connecting hose hook-up kit

228



PUMPMASTER 2, 1:1 TRANSFER PUMP DRUM PACKAGES

Part No. 454 002

PUMPMASTER 2 1:1 ratio high flow transfer package for 55 gal drums.

Includes the following:

Part No. 352 120: PumpMaster 2 - 1:1 ratio pump with bung bushing.

Part No. 858: 10' x 3/4" delivery hose.

Part No. 361 000: Low pressure, high delivery nozzle.

Part No. 950 321: Air needle valve.

Part No. 955: Mini air filter regulator combo.

Part No. 2051 (x2): Pump to air valve and air valve to air filter regulator combo adaptor.

Part No. 454 003

PUMPMASTER 2 1:1 ratio transfer package for 55 gal drums.

Includes the following:

Part No. 352 120: PumpMaster 2 - 1:1 ratio pump with bung bushing.

Part No. 847: 10' x 1/2" delivery hose.

Part No. 363 114: Non-metered oil delivery handle with non drip tip.

Part No. 950 321: Air needle valve.

Part No. 955: Mini air filter regulator combo.

Part No. 2051 (x2): Pump to air valve and air valve to air filter regulator combo adaptor.

Part No. 2065: Pump to hose adaptor.

Part No. 454 010

PUMPMASTER 2 1:1 ratio metered transfer package for 55 gal drums.

Includes the following:

Part No. 352 120: PumpMaster 2 - 1:1 ratio pump with bung bushing.

Part No. 847: 10' x 1/2" delivery hose.

Part No. 365 534: Oil metered handle with non drip tip.

Part No. 950 321: Air needle valve.

Part No. 955: Mini air filter regulator combo.

Part No. 2051 (x2): Pump to air valve and air valve to air filter regulator combo adaptor.

Part No. 2065: Pump to hose adaptor.



454 002

454 010

SPIGOT PUMP WITH DRIP TRAY

Part No. 454 100

Spigot pump complete unit (fits 55 gal drum) includes PumpMaster 2 - 2:1 ratio pump, bung bushing adaptor, drain shelf with filter screen and curved outlet valve with spring loaded spigot valve. Shelf holds container, catches spills, drains back through filtered bushing into drum. Completely packaged as one SKU.



454 100

Recommended options:

Part No. 955 Air filter and regulator combo, 1/4" NPTF. Part No. 950 321 Air needle valve.

PUMPMaster 2 - 3:1 RATIO OIL PUMPS

200 SERIES

MEDIUM PRESSURE UTILITY PUMPS



Double acting air operated medium pressure pumps for dispensing lubricants from mobile units, oil distribution packages and small systems. Pumps include height adjustable 2" NPTM bung adaptor for tank or drum bung mounting. Built in pressure relief port for optional (PN 609 007) pressure relief valve.

FLUIDS HANDLED

- Synthetic and mineral based oil.
- Hydraulic oil.
- Gear lube.
- Transmission fluid.

MARKETS SERVED

- Auto dealers.
- Service shops.
- Fast lube centers.
- Agriculture.
- Marine.
- Mining and construction.

MODELS		
PART No.	APPLICATION	WEIGHT
353 120	Universal stub pump with bung adaptor	4.4 lb (2 kg)
358 120	16 gal (60 l) keg bung mounted with bung adaptor	6.6 lb (3 kg)
354 120	55 gal (205 l) drum bung mounted with bung adaptor	7.7 lb (3,5 kg)
213	275/500 tank (48") with bung adaptor	8.8 lb (5 kg)
260	60" tank with bung adaptor	9.9 lb (4,5 kg)

TECHNICAL DATA PRESSURE RATIO 3:1	
Air pressure operating range	20 to 140 psi (1,5 - 10 bar)
Air consumption (1)	6.4 scfm (180 NL/min)
Maximum fluid outlet pressure	420 psi (30 bar)
Air motor diameter	2" (51 mm)
Air motor effective diameter	1 1/2" (35 mm)
Air motor stroke	3" (75 mm)
Delivery at 200 cpm	2.7 US gpm (10 l/min)
Maximum free flow delivery (2)	9.3 US gpm (35 l/min)
Air inlet	1/4" NPTF
Fluid inlet (stub pump only)	3/4" NPTF
Fluid outlet	1/2" NPTF
Wetted and seal materials	Aluminum / Steel / NBR / PTFE
Noise level (3)	80 dB
Manual	835 809

DIMENSIONS Inches - (mm)			
PART No.	353 120	358 120	354 120
A	19 1/2" (495)	39" (995)	47" (1.200)
B	11 1/2" (295)	11 1/2" (295)	11 1/2" (295)
C	1 1/4" (34)	1 1/4" (34)	1 1/4" (34)
D	8" (200)	27 1/2" (700)	35 1/2" (905)
PART No.	213	260	
A	59 1/2" (1.510)	71 1/2" (1.815)	
B	11 1/2" (295)	11 1/2" (295)	
C	1 1/4" (34)	1 1/4" (34)	
D	48" (1.215)	60" (1.520)	

- (1) Air consumption with 90 psi (6 bar) air inlet pressure and 200 cycles per minute.
 (2) Maximum free delivery at 100 psi (7 bar).
 (3) Maximum noise level measured at 3' (1 m) from the pump, 100 psi (7 bar) air pressure and free delivery.

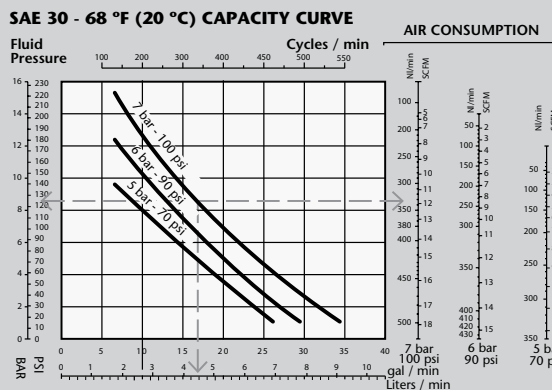
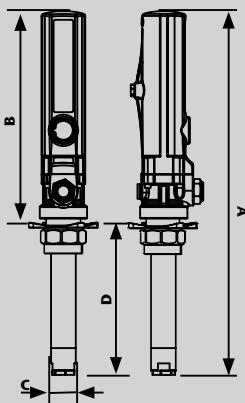

PUMPMaster 2 - 3:1 RATIO PUMP PACKAGES



PUMPMaster 2 - 3:1 PRESSURE RATIO PUMP, 16 GAL KEG SYSTEMS FOR GEAR LUBE, MOTOR OIL, ATF AND OTHER FLUIDS

Air operated 3:1 pressure ratio pump packages. The pump is designed to fit through the 2" bung opening on oil drums or to be mounted on a lid for open drums. The pump includes a height adjustable bung adaptor.

Part No. 202

PumpMaster 2 system for 16 gal bung type keg.

Includes the following:

Part No. 358 120: PumpMaster 2 - 3:1 ratio pump with 2" bung bushing.

Part No. 904: Connecting hose hook up kit.

Part No. 204

PumpMaster 2 system for 16 gal open top keg.

Includes the following:

Part No. 358 120: PumpMaster 2 - 3:1 ratio pump with cover mounting adaptor.

Part No. 1936: Deluxe drum cover for 16 gal drum.

Part No. 904: Connecting hose hook up kit.



PUMPMaster 2 - 3:1 PUMP SYSTEMS, DESIGNED FOR 55 GAL DRUMS AND BULK OIL SYSTEMS

Part No. 210

PumpMaster 2 - 3:1 ratio stub pump system.

Includes the following:

Part No. 353 120: Universal PumpMaster 2 - 3:1 stub pump with bung bushing.

Part No. 904: Connecting hose hook up kit.

Part No. 222

PumpMaster 2 - 3:1 ratio pump system for 55 gal drum or standard 36", 250 gal work bench type tank.

Includes the following:

Part No. 354 120: PumpMaster 2 - 3:1 pump with bung bushing.

Part No. 904: Connecting hose hook up kit.

Part No. 212

PumpMaster 2 - 3:1 ratio pump system for 44" to 48", 275 gal oval or 500 gal round tank.

Includes the following:

Part No. 213: PumpMaster 2 - 3:1 pump with bung bushing.

Part No. 904: Connecting hose hook up kit.

Part No. 266

PumpMaster 2 - 3:1 ratio pump system for 60" tanks with connection kit.

Includes the following:

Part No. 260: PumpMaster 2 - 3:1 ratio pump with bung bushing.

Part No. 904: Connecting hose hook up kit.



Recommended options:

Part No. 955 Air filter and regulator combo, 1/4" NPTF.

Part No. 609 007 Pressure relief valve.



PUMPMaster 2 - 3:1 RATIO PUMP PORTABLE PACKAGES

PUMPMaster 2 - 3:1 RATIO PUMP PORTABLE PACKAGES FOR 16 GAL KEGS

All packages include PumpMaster 2 - 3:1 ratio pump part no. 358 120 with the accessories listed.

203



207A



PART No.	203	203A	207	207A
PUMPMaster 2 - 3:1 PUMP	358 120	358 120	358 120	358 120
DRUM COVER	1936	1936	-	-
15' DELIVERY HOSE	848	848	848	848
METERED HANDLE	365 537	365 537	365 537	365 537
1/4" QUICK AIR COUPLER	930F04	930F04	930F04	930F04
1/4" QUICK AIR NIPPLE	933M04	933M04	933M04	933M04
1/4" MINI FILTER REGULATOR COMBO	955 (not shown)	955 (not shown)	955 (not shown)	955 (not shown)
BAND TYPE DOLLY	1304	-	1304	-
TWO WHEEL DRUM TRUCK	-	1301	-	-
FOUR WHEEL DRUM TRUCK	-	-	-	1303
PUMP TO HOSE CONNECTOR, 3/4" NPT (M) x 1/2" NPT (F)	2065	2065	2065	2065
PUMP TO FR CONNECTOR 1/4" NPT (M) BOTH ENDS	2051	2051	2051	2051

PUMPMaster 2 - 3:1 RATIO PUMP PORTABLE PACKAGES FOR 55 GAL DRUMS

All packages include PumpMaster 2 - 3:1 ratio pump part no. 354 120 with the accessories listed.

209B



209



PART No.	209	209A	209B	209C	211 001	454 111	454 112
PUMPMaster 2 - 3:1 PUMP	354 120	354 120	354 120	354 120	354 120	354 120	354 120
15' DELIVERY HOSE	848	848	848	848	-	-	-
30' x 1/2" 1400 SERIES HOSE REEL	-	-	-	-	1428	1428	1428
METERED HANDLE	365 537	365 537	365 537	365 537	365 537	-	2199*
OIL HANDLE (NO METER)	-	-	-	-	-	363 117	-
1/4" QUICK AIR COUPLER	930F04	930F04	930F04	930F04	930F04	930F04	930F04
1/4" QUICK AIR NIPPLE	933M04	933M04	933M04	933M04	933M04	933M04	933M04
1/4" MINI FILTER REGULATOR COMBO	955 (not shown)	955 (not shown)	955 (not shown)	955 (not shown)	955 (not shown)	955 (not shown)	955 (not shown)
X-FRAME DOLLY	-	1306	-	-	-	-	-
STANDARD DUTY PLATFORM TRUCK	-	-	1307	-	-	-	-
HEAVY DUTY PLATFORM TRUCK	-	-	-	1305	1305	1305	1305
REEL BRACKET	-	-	-	-	1399	1399	1399
5' REEL TO PUMP CONNECTION HOSE	-	-	-	-	846	846	846
PUMP TO HOSE CONNECTOR, 3/4" NPT (M) x 1/2" NPT (F)	2065	2065	2065	2065	2065	2065	2065
PUMP TO FR CONNECTOR 1/4" NPT (M) BOTH ENDS	2051	2051	2051	2051	2051	2051	2051

211 001



* Preset meter handle.

PUMPMASTER 2 - 3:1 RATIO PUMP PACKAGES FOR TOTES



PUMPMASTER 2 - 3:1 RATIO PUMP PACKAGES FOR TOTES, 275 / 330 GAL

PART No.	TOP OF TOTE MOUNTING		SIDE OF TOTE MOUNTING		
	454 694	454 694A	454 699	454 699A	454 150
PUMPMASTER 2 - 3:1 PUMP	353 120	353 120	353 120	353 120	353 120
PUMP BRACKET	900	900	900	900	900
TOTE BRACKET	360 106	360 106	360 107	360 107	360 108
SUCTION HOSE (1)	745 306	745 306	745 304	745 304	745 304
METERED HANDLE	365 537	365 537	365 537	365 537	365 537
HOSE REEL	30' x 1/2" 506 202	50' x 1/2" 504 250	30' x 1/2" 506 202	50' x 1/2" 504 250	-
REEL PIVOTING BRACKET	-	-	1388	1388	-
DELIVERY HOSE	-	-	-	-	20' x 1/2" (849)
1/4" QUICK AIR COUPLER	930F04	930F04	930F04	930F04	930F04
1/4" QUICK AIR NIPPLE	933M04	933M04	933M04	933M04	933M04
1/4" MINI FILTER REGULATOR COMBO	955 (not shown)	955 (not shown)	955 (not shown)	955 (not shown)	955 (not shown)
PUMP TO HOSE CONNECTOR, 3/4" NPT (M) x 1/2" NPT (F)	2065	2065	2065	2065	2065
PUMP TO FR CONNECTOR 1/4" NPT (M) BOTH ENDS	2051	2051	2051	2051	2051

(1) Includes adaptor for connecting to the tote lower outlet.
Pump packages do not include the tote.



454 694



454 699



454 150

PUMPMASTER 4 - 3:1 RATIO OIL PUMPS

400 SERIES

STANDARD-DUTY MEDIUM PRESSURE PUMPS

Double acting air operated medium pressure high volume pumps for dispensing lubricants in medium size installations. Pumps include height adjustable 2" NPTM bung adaptor for drum and tank bung mounting. Built in port for optional (PN 609 007) pressure relief valve.



FLUIDS HANDLED

- Synthetic and mineral based oil.
- Gear lube.
- Hydraulic oil.
- Transmission fluid.

MARKETS SERVED

- Vehicle maintenance centers.
- Auto dealers.
- Fleet service.
- Fast lube centers.
- In-plant.

MODELS		
PART No.	APPLICATION	WEIGHT
340 120	Universal stub pump with bung adaptor	13 lb (5,7 kg)
340 520	16 gal keg bung mounted with bung adaptor	15.5 lb (7 kg)
341 120	55 gal (205 l) drum bung mounted with bung adaptor	17 lb (7,7 kg)
433	275/500 gal tank (48") with bung adaptor	19 lb (8,6 kg)

TECHNICAL DATA PRESSURE RATIO 3:1	
Air pressure operating range	20 to 140 psi (1,5 - 10 bar)
Air consumption (1)	10 scfm (285 NL/min)
Maximum fluid outlet pressure	420 psi (30 bar)
Air motor diameter	3 1/2" (88 mm)
Air motor effective diameter	2 1/2" (60 mm)
Air motor stroke	4" (100 mm)
Delivery at 85 cpm	2.7 US gpm (10 l/min)
Maximum free flow delivery (2)	11.1 US gpm (42 l/min)
Air inlet	3/8" NPTF
Fluid inlet (stub pump only)	1" NPTF
Fluid outlet	3/4" NPTF
Wetted and seal materials	Aluminum / Steel / Polyurethane / NBR / PTFE
Noise level (3)	80 dB
Manual	834 810

DIMENSIONS Inches - (mm)			
PART No.	340 120	340 520	341 120
A	23 1/4" (585)	42 3/4" (1.085)	51" (1.295)
B	15 1/4" (385)	15 1/4" (385)	15 1/4" (385)
C	2" (52)	25" (52)	2" (52)
D	8" (200)	27 1/2" (700)	35 3/4" (910)
PART No.	433		
A	63 1/4" (1.600)		
B	15 1/4" (385)		
C	2" (52)		
D	48" (1.215)		

- (1) Air consumption with 90 psi (6 bar) air inlet pressure and 85 cycles per minute.
 (2) Maximum free delivery at 100 psi (7 bar).
 (3) Maximum noise level measured at 3' (1 m) from the pump, 100 psi (7 bar) air pressure and free delivery.

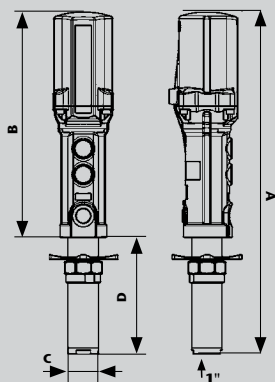

SAE 30 - 68 °F (20 °C) CAPACITY CURVE

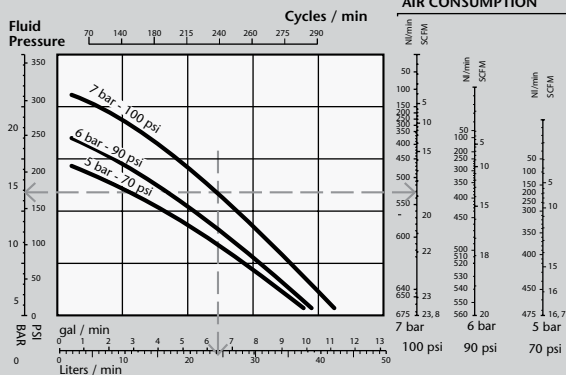

PUMPMASTER 4 - 5:1 RATIO OIL PUMPS



STANDARD-DUTY MEDIUM PRESSURE PUMPS

400 SERIES

Double acting air operated medium pressure pumps for dispensing lubricants in medium to large size installations, that include multiple outlets with simultaneous operation. Pumps include height adjustable bung adaptor 2" NPTM for drum and tank bung mounting. Built in port for optional (PN 609 007) pressure relief valve.

FLUIDS HANDLED

- Synthetic and mineral based oil.
- Gear lube.
- Hydraulic oil.
- Transmission fluid.

MARKETS SERVED

- Auto and truck dealers.
- Fleet service facilities.
- Marine.
- In-plant.



MODELS		
PART No.	APPLICATION	WEIGHT
347 120	Universal stub pump with bung adaptor	12.5 lb (5,6 kg)
347 520	16 gal keg with bung adaptor	15 lb (6,8 kg)
348 120	55 gal (205 l) drum bung mounted with bung adaptor	16.5 lb (7,4 kg)
413	275/500 gal tank (48") with bung adaptor	18.5 kg (8,4 kg)
460	60" tank with bung adaptor	20.5 lb (9,3 kg)

TECHNICAL DATA PRESSURE RATIO 5:1	
Air pressure operating range	20 to 140 psi (1,5 - 10 bar)
Air consumption (1)	14 scfm (400 NL/min)
Maximum fluid outlet pressure	700 psi (50 bar)
Air motor diameter	3 1/2" (88 mm)
Air motor effective diameter	2 1/2" (60 mm)
Air motor stroke	4" (100 mm)
Delivery at 125 cpm	2.7 US gpm (10 l/min)
Maximum free flow delivery (2)	6.6 US gpm (25 l/min)
Air inlet	3/8" NPTF
Fluid inlet (stub pump only)	1" NPTF
Fluid outlet	3/4" NPTF
Wetted and seal materials	Aluminum / Steel / Polyurethane / NBR / PTFE
Noise level (3)	80 dB
Manual	834 811

- (1) Air consumption with 90 psi (6 bar) air inlet pressure and 125 cycles per minute.
 (2) Maximum free delivery at 100 psi (7 bar).
 (3) Maximum noise level measured at 3' (1 m) from the pump, 100 psi (7 bar) air pressure and free delivery.

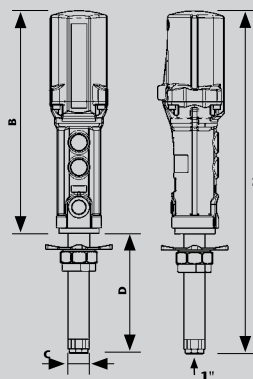
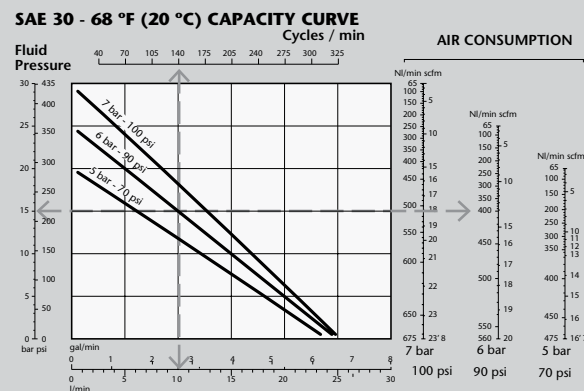

DIMENSIONS Inches - (mm)			
PART No.	347 120	347 520	348 120
A	26 1/4" (663)	42 3/4" (1.085)	51 1/4" (1.300)
B	15 1/4" (385)	15 1/4" (385)	15 1/4" (385)
C	1 3/4" (42)	1 3/4" (42)	1 3/4" (42)
D	11" (278)	27 1/2" (700)	36" (915)
PART No.	413	460	
A	63 1/4" (1.600)	75 1/4" (1.910)	
B	15 1/4" (385)	15 1/4" (385)	
C	1 3/4" (42)	1 3/4" (42)	
D	48" (1.215)	60" (1.525)	



PUMPMaster 4 - 3:1 AND 5:1 RATIO PUMP PACKAGES

PUMPMaster 4 - 3:1 AND 5:1 RATIO UNIVERSAL STUB PUMP AND BULK TANK PACKAGES



410

Part No. 410

PumpMaster 4 - 5:1 ratio pump system.

Includes the following:

Part No. 347 120: Universal PumpMaster 4 - 5:1 stub pump with bung bushing.

Part No. 906: Connecting hose hook up kit.

Part No. 412

PumpMaster 4 - 5:1 ratio pump system for 44" - 48" 275 gal oval or 500 gal round tank.

Includes the following:

Part No. 413: PumpMaster 4 - 5:1 pump with bung bushing.

Part No. 906: Connecting hose hook up kit.

Part No. 466

PumpMaster 4 - 5:1 ratio pump system for 60" tanks.

Includes the following:

Part No. 460: PumpMaster 4 - 5:1 pump with bung bushing.

Part No. 906: Connecting hose hook up kit.

Part No. 440

PumpMaster 4 - 3:1 ratio pump system.

Includes the following:

Part No. 340 120: Universal PumpMaster 4 - 3:1 stub pump with bung bushing.

Part No. 906: Connecting hose hook up kit.

Part No. 442

PumpMaster 4 - 3:1 ratio pump system for 44" - 48" 275 gal oval or 500 gal round tank.

Includes the following:

Part No. 433: PumpMaster 4 - 3:1 pump with bung bushing.

Part No. 906: Connecting hose hook up kit.

PUMPMaster 4 - 3:1 AND 5:1 RATIO PUMP PACKAGES FOR DRUMS



422

Pump systems with air operated PumpMaster 4 - 3:1 or 5:1 pressure ratio pump. The pump is designed to fit through the 2" bung open on oil drums and standard 36" 250 gallon work bench style tanks. The pump includes a height adjustable bung adaptor.

Part No. 422

PumpMaster 4 - 5:1 ratio pump system for 55 gal drum or standard 250 gal work bench type tank.

Includes the following:

Part No. 348 120: PumpMaster 4 - 5:1 pump with bung bushing.

Part No. 906: Connecting hose hook up kit.

Part No. 452

PumpMaster 4 - 3:1 ratio pump system for 55 gal drum or standard 250 gal work bench type tank.

Includes the following:

Part No. 341 120: PumpMaster 4 - 3:1 pump with bung bushing.

Part No. 906: Connecting hose hook up kit.

Recommended options:

Part No. 957 air filter and regulator combo, 3/8" NPTF.

Part No. 609 007 pressure relief valve.

PUMPMASTER 35 - 5:1 RATIO OIL PUMPS



HEAVY-DUTY MEDIUM PRESSURE PUMP

PM35 HEAVY-DUTY SERIES

Double acting air operated medium pressure delivery pump for oil distribution applications. Built in port for optional (PN 609 007) pressure relief valve. Bung adaptor.

FLUIDS HANDLED

- Synthetic and mineral based oil.
- Hydraulic oil.
- Gear lube.
- Transmission fluid.

MARKETS SERVED

- Auto and truck dealers.
- Fleet service facilities.
- Mining and construction.
- Lube trucks.
- Railroad and mass transit maintenance.
- Marine.
- In-plant.

MODELS

PART No.	APPLICATION	WEIGHT
535 531	Universal stub pump with bung adaptor	12.4 lb (5.6 kg)
535 581	Universal stub pump	11.7 lb (5.3 kg)
535 511	55 gal (205 l) drum bung mounted with bung adaptor	17.6 lb (8 kg)

TECHNICAL DATA

Pump pressure ratio	5:1
Air pressure operating range	30 to 175 psi (2 to 12 bar)
Air consumption (1)	12.4 scfm (350 NI/min)
Maximum fluid outlet pressure	875 psi (60 bar)
Air motor effective diameter	3.15" (80 mm)
Air motor stroke	3.15" (80 mm)
Delivery at 80 cpm	3.2 gal/min (12 l/min)
Maximum free flow delivery	8 gal/min (30 l/min)
Air inlet	3/8" NPT (F)
Fluid inlet	1 1/2" NPT (F)
Fluid outlet	1/2" NPT (F)
Wetted and seal materials	Hard chromed steel / Steel / Polyurethane / NBR / Aluminum
Noise level (2)	80 dB
Manual	853 826



(1) Maximum air consumption with 72 psi (5 bar) air inlet pressure and 80 cpm.

(2) Maximum noise level measured at 3' (1 m) from the pump, 100 psi (7 bar) air pressure and free delivery.

SAE 10, 70 °F (21 °C) CAPACITY CURVE

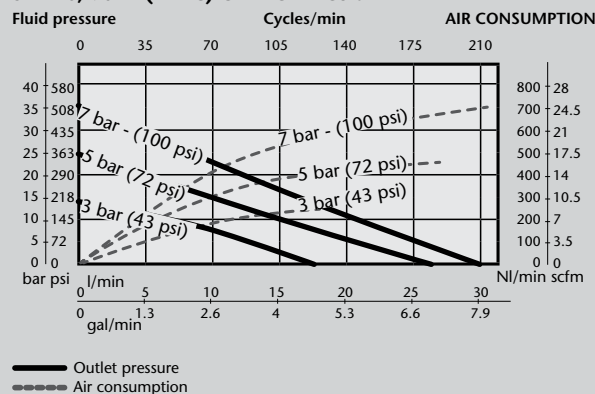

DIMENSIONS Inches - (mm)			
PART No.	535 531	535 581	535 511
A	18 1/2" (469)	18 1/2" (469)	47" (1,194)
B	10 1/2" (269)	10 1/2" (269)	10 1/2" (269)
C	2" (50)	2" (50)	2" (50)
D	8" (200)	8" (200)	36 1/2" (925)

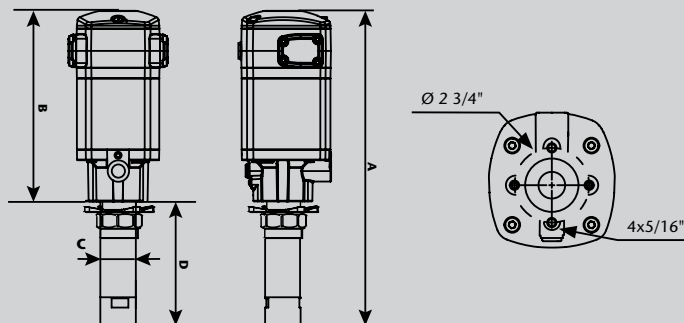



PUMPMASTER 35 - 8:1 RATIO OIL PUMP

PM35 HEAVY-DUTY SERIES

HEAVY-DUTY HIGH PRESSURE PUMP

Double acting air operated high pressure and reliable delivery pump for oil distribution applications. Built in port for optional (PN 609 008) pressure relief valve. Cast iron pump body for high pressure operation.



FLUIDS HANDLED

- Synthetic and mineral based oil.
- Hydraulic oil.
- Gear lube.
- Transmission fluid.
- Corrosion protection fluids.

MARKETS SERVED

- Vehicle maintenance centers.
- Fleet service.
- Mining and construction.
- Lube trucks.
- Railroad and mass transit maintenance.
- Marine.
- In-plant.

MODELS

PART No.	APPLICATION	WEIGHT
535 831	Universal stub pump with bung adaptor	15 lb (6.8 kg)
535 881	Universal stub pump	14 lb (6.4 kg)
535 811	55 gal (205 l) drum bung mounted with bung adaptor	18.3 lb (8.3 kg)

TECHNICAL DATA

Pump pressure ratio	8:1
Air pressure operating range	30 to 175 psi (2 to 12 bar)
Air consumption (1)	12.4 scfm (350 NI/min)
Maximum fluid outlet pressure	1,400 psi (96 bar)
Air motor effective diameter	3.15" (80 mm)
Air motor stroke	3.15" (80 mm)
Delivery at 80 cpm	1.9 gal/min (7 l/min)
Maximum free flow delivery	4.5 gal/min (17 l/min)
Air inlet	3/8" NPT (F)
Fluid inlet	1" NPT (F)
Fluid outlet	1/2" NPT (F)
Wetted and seal materials	Cast iron / Hard chromed steel / Steel / Polyurethane / NBR
Noise level (2)	80 dB
Manual	853 829

DIMENSIONS Inches - (mm)

PART No.	535 831	535 881	535 811
A	19 1/4" (487)	19 1/4" (487)	47 3/4" (1,212)
B	11 1/4" (287)	11 1/4" (287)	11 1/4" (287)
C	1 2/3" (42)	1 2/3" (42)	1 2/3" (42)
D	8" (200)	8" (200)	36 1/2" (925)

(1) Maximum air consumption with 5 psi (72 bar) air inlet pressure and 80 cpm.

(2) Maximum noise level measured at 3' (1 m) from the pump, 100 psi (7 bar) air pressure and free delivery.

SAE 10, 70 °F (21 °C) CAPACITY CURVE

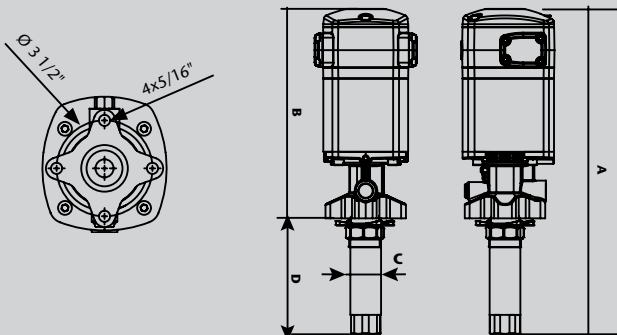
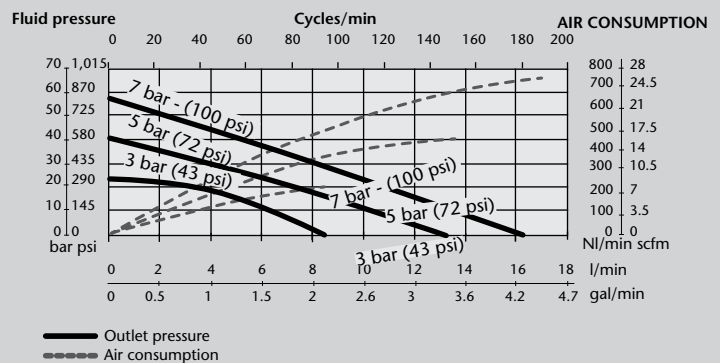

PUMPMaster 35 - 5:1 AND 8:1 RATIO PUMP PACKAGES



PUMPMaster 35 - 5:1 AND 8:1 RATIO UNIVERSAL STUB PUMP SYSTEMS

535 531A**Part No. 535 531A**

PumpMaster 35 - 5:1 ratio pump system.

Includes the following:

Part No. 535 531: Universal PumpMaster 35 - 5:1 ratio stub pump with bung bushing.

Part No. 916: Connecting hose hook up kit.

Part No. 535 831A

PumpMaster 35 - 8:1 ratio pump system.

Includes the following:

Part No. 535 831: Universal PumpMaster 35 - 8:1 ratio stub pump with bung bushing.

Part No. 916: Connecting hose hook up kit.



PUMPMaster 35 - 5:1 AND 8:1 RATIO PUMP PACKAGES FOR DRUMS

535 511A

Pump packages with air operated PumpMaster 35 - 5:1 or 8:1 pressure ratio pump. The pump is designed to fit through the 2" bung open on oil drums or to be mounted on a lid for open drums. The pump includes a height adjustable bung adaptor.

Part No. 535 511A

PumpMaster 35 - 5:1 ratio pump system for standard 250 gal work bench type tank and 55 gal drums.

Includes the following:

Part No. 535 511: PumpMaster 35 - 5:1 pump with bung bushing.

Part No. 916: Connecting hose hook up kit.

Part No. 535 811A

PumpMaster 35 - 8:1 ratio pump system for standard 250 gal work bench type tank and 55 gal drums.

Includes the following:

Part No. 535 811: PumpMaster 35 - 8:1 pump with bung bushing.

Part No. 916: Connecting hose hook up kit.

**Recommended options:**

Part No. 957 air filter and regulator combo, 3/8" NPTF.

Part No. 609 007 pressure relief valve, approx. 900 psi for PM35 5:1.

Part No. 609 008 pressure relief valve, approx. 1,450 psi for PM35 8:1.



PUMPMASTER 45 - 3:1 RATIO OIL PUMP

PM45 HEAVY-DUTY SERIES

HEAVY-DUTY VOLUME TRANSFER PUMP

Double acting air operated medium pressure and high delivery pump for large volume transfer applications. Built in port for optional (PN 609 007) pressure relief valve. **Flange mounted pump.**



FLUIDS HANDLED

- Synthetic and mineral based oil.
- Hydraulic oil.
- Gear lube.
- Transmission fluid.

MARKETS SERVED

- Construction equipment.
- Mining equipment.
- Large fleets.
- Railroad and mass transit maintenance.
- Marine.
- In plant oil distribution and transfer.

MODELS		
PART No.	APPLICATION	WEIGHT
536 331	Universal stub pump. Flange mounted	38 lb (17 kg)

TECHNICAL DATA PRESSURE RATIO 3:1	
Air pressure operating range	20 to 170 psi (1,5 to 12 bar)
Air consumption (1)	28 scfm (800 NI/min)
Maximum fluid outlet pressure	510 psi (36 bar)
Air motor effective diameter	4 1/2" (115 mm)
Air motor stroke	4" (100 mm)
Delivery at 80 cpm	12 gal/min (45 l/min)
Maximum free flow delivery	32 gal/min (120 l/min)
Air inlet	1/2" NPTF
Fluid inlet	1 1/2" NPTF
Fluid outlet	3/4" NPTF
Wetted and seal materials	Cast iron / Nickel / Aluminum / Steel / Polyurethane / NBR
Noise level (2)	80 dB
Manual	853 817

DIMENSIONS Inches - (mm)	
PART No.	536 331
A	28" (702)
B	20" (502)
C	3 1/2" (90)
D	8" (200)

(1) Maximum air consumption with 72 psi (5 bar) air inlet pressure and 80 cpm.
 (2) Maximum noise level measured at 3' (1 m) from the pump, 100 psi (7 bar) air pressure and free delivery.

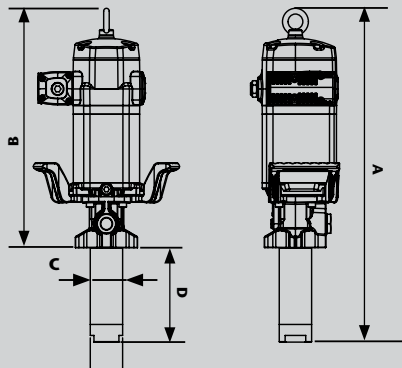
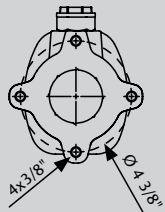

SAE 10, 70 °F (21 °C) CAPACITY CURVE

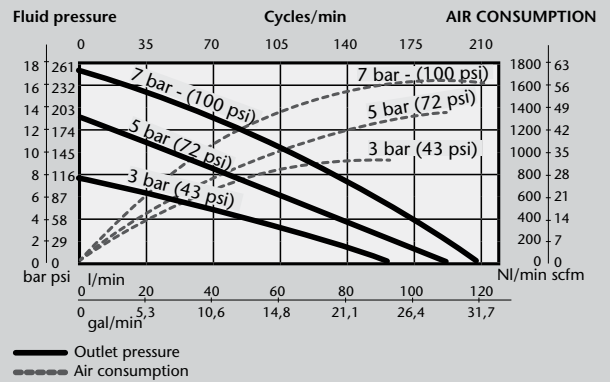

PUMPMASTER 45 - 6:1 RATIO OIL PUMP



HEAVY-DUTY HIGH FLOW PUMP

PM45 HEAVY-DUTY SERIES

Double action air operated medium pressure pump for large system with simultaneous operation outlets that require a high delivery pump. Built in port for optional (PN 609 007) pressure relief valve. **Flange mounted pump.**

PRODUCTS HANDLED

- Synthetic and mineral based oil.
- Hydraulic oil.
- Gear lube.
- Transmission fluid.

MARKETS

- Large auto and truck dealers.
- Construction equipment maintenance.
- Mining equipment maintenance.
- Large fleets.
- Railroad and mass transit maintenance.
- Marine.
- In plant oil distribution.



MODELS		
PART No.	APPLICATION	WEIGHT
536 631	Universal stub pump. Flange mount	38 lb (17 kg)

TECHNICAL DATA PRESSURE RATIO 6:1	
Air pressure operating range	20 to 170 psi (1,5 to 12 bar)
Air consumption (1)	29 scfm (830 NI/min)
Maximum fluid outlet pressure	1,020 psi (72 bar)
Air motor effective diameter	4 1/2" (115 mm)
Air motor stroke	4" (100 mm)
Delivery at 80 cpm	6.60 gal/min (25 l/min)
Maximum free flow delivery	25 gal/min (95 l/min)
Air inlet	1/2" NPTF
Fluid inlet	1 1/2" NPTF
Fluid outlet	3/4" NPTF
Wetted and seal materials	Cast iron / Hard chromed steel / Steel / Polyurethane / NBR
Noise level (2)	80 dB
Manual	853 813

(1) Maximum air consumption with 72 psi (5 bar) air inlet pressure and 80 cpm.
 (2) Maximum noise level measured at 3' (1 m) from the pump, 100 psi (7 bar) air pressure and free delivery.

DIMENSIONS Inches - (mm)	
PART No.	536 631
A	28" (702)
B	20" (502)
C	2 3/4" (70)
D	8" (200)

SAE 10, 70 °F (21 °C) CAPACITY CURVE

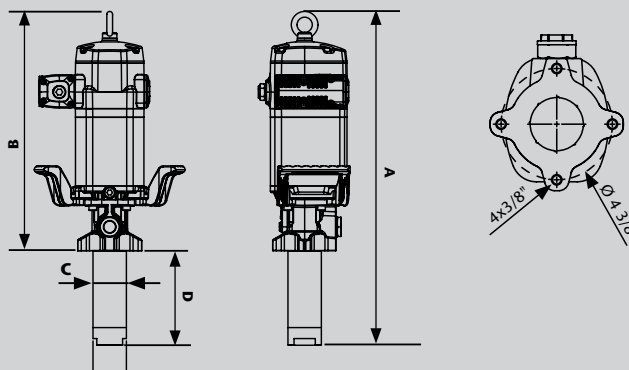
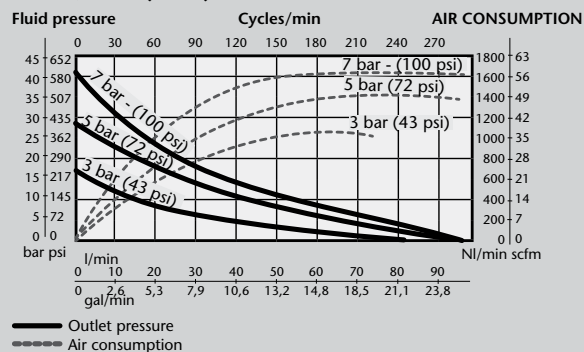



PUMPMASTER 45 -10:1 RATIO OIL PUMPS

PM45 HEAVY-DUTY SERIES

HEAVY-DUTY PRESSURE FLOW PUMPS

Double acting air operated moderate pressure pump for very large oil systems or when low air pressure or cold temperatures would limit pump performance. Built in port for optional (PN 609 008) pressure relief valve. Flange mounted pumps. Pump 536 011 can also use bung adaptor (PN: 360 006) for bung mounting.



PRODUCTS HANDLED

- Synthetic and mineral based oil.
- Hydraulic oil.
- Gear lube.
- Transmission fluid.

MARKETS

- Large auto and truck dealers.
- Construction equipment maintenance.
- Mining equipment maintenance.
- Railroad and mass transit maintenance.
- Large fleets.
- Lube trucks.
- Marine.
- In plant oil distribution.

MODELS		
PART No.	APPLICATION	WEIGHT
536 031	Universal stub pump. Flange mounted pump, bung bushing optional	36 lb (16,5 kg)
536 011	55 gal (205 l) drum. Flange mounted pump, bung bushing optional	38 lb (17 kg)

TECHNICAL DATA PRESSURE RATIO 10:1

Air pressure operating range	20 to 170 psi (1,5 to 12 bar)
Air consumption (1)	30 scfm (850 NI/min)
Maximum fluid outlet pressure	1,700 psi (120 bar)
Air motor effective diameter	4 1/2" (115 mm)
Air motor stroke	4" (100 mm)
Delivery at 80 cpm	4 gal/min (15 l/min)
Maximum free flow delivery	17.2 gal/min (65 l/min)
Air inlet	1/2" NPTF
Fluid inlet	1 1/2" NPTF
Fluid outlet	3/4" NPTF
Wetted and seal materials	Cast iron / Hard chromed steel / Steel / Polyurethane / NBR
Noise level (2)	80 dB
Manual	853 812

DIMENSIONS Inches - (mm)		
PART No.	536 031	536 011
A	28" (702)	54" (1.357)
B	20" (502)	20" (502)
C	2" (54)	2" (54)
D	8" (200)	34" (855)

(1) Maximum air consumption with 72 psi (5 bar) air inlet pressure and 80 cpm.
 (2) Maximum noise level measured at 3' (1 m) from the pump, 100 psi (7 bar) air pressure and free delivery.

SAE 10, 70 °F (21 °C) CAPACITY CURVE

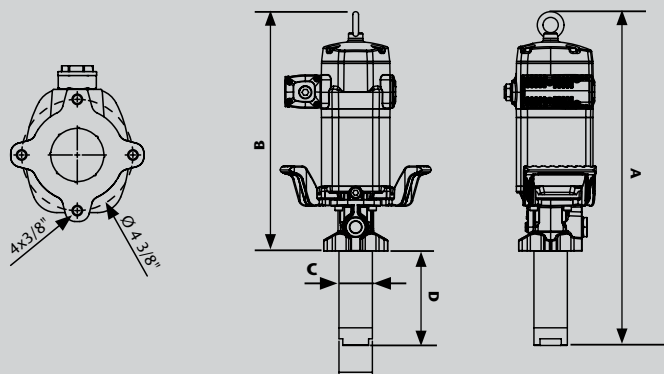
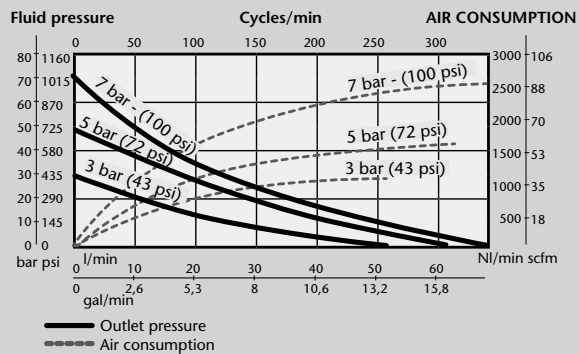

PUMPMASTER 60 - 6:1 RATIO OIL PUMP



HEAVY-DUTY HIGH DELIVERY PUMP

PM60 HEAVY-DUTY SERIES

Double acting air operated medium pressure and high delivery pump, for large installations with simultaneous operation outlets and applications that require large, constant delivery rates. Built in port for optional (PN 609 007) pressure relief valve. **Flange mounted pump.**

PRODUCTS HANDLED

- Synthetic and mineral based oil.
- Hydraulic oil.
- Gear lube.
- Transmission fluid.

MARKETS

- Very large auto and truck dealers.
- Construction equipment maintenance.
- Mining equipment maintenance.
- Large fleets.
- Railroad and mass transit maintenance.
- Marine.
- In plant oil distribution.



MODELS		
PART No.	APPLICATION	WEIGHT
537 631	Universal stub pump. Flange mounted	42 lb (19 kg)

TECHNICAL DATA PRESSURE RATIO 6:1	
Air pressure operating range	20 to 170 psi (1,5 to 12 bar)
Air consumption (1)	39 scfm (1.100 NI)
Maximum fluid outlet pressure	1,020 psi (72 bar)
Air motor effective diameter	6" (150 mm)
Air motor stroke	4" (100 mm)
Delivery at 60 cpm	9.25 gal/min (35 l/min)
Maximum free flow delivery	26.5 gal/min (100 l/min)
Air inlet	1/2" NPTF
Fluid inlet	1 1/2" NPTF
Fluid outlet	3/4" NPTF
Wetted and seal materials	Cast iron / Aluminum / Nickel / Steel / Polyurethane / NBR
Noise level (2)	80 dB
Manual	853 821

(1) Maximum air consumption with 72 psi (5 bar) air inlet pressure and 60 cpm.

(2) Maximum noise level measured at 3' (1 m) from the pump, 100 psi (7 bar) air pressure and free delivery.

DIMENSIONS Inches - (mm)	
PART No.	537 631
A	28 1/4" (716)
B	20 1/4" (516)
C	3 1/2" (90)
D	8" (200)

SAE 10, 70 °F (21 °C) CAPACITY CURVE

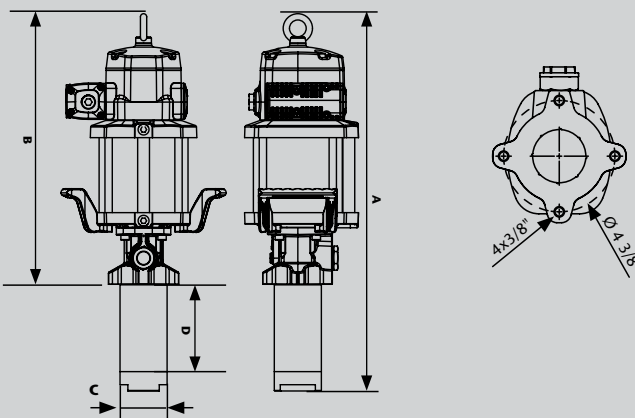
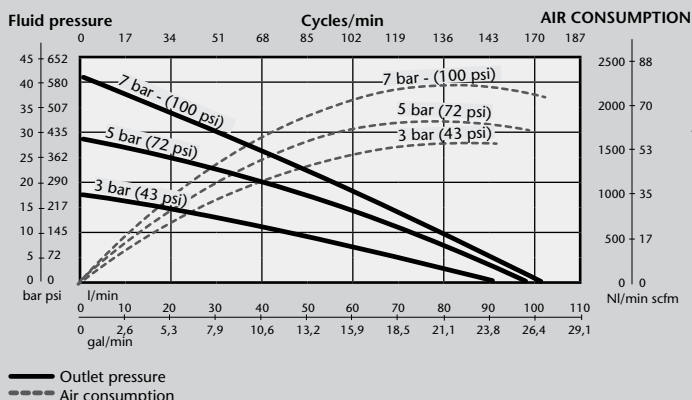

PUMPMASTER 60 - 12:1 RATIO OIL PUMP

PM60 HEAVY-DUTY SERIES

HEAVY-DUTY HIGH PERFORMANCE PUMP

Double acting air operated moderate pressure and high delivery pump for very large installation with simultaneous operation outlets or when low air pressure or low temperatures would limit pump performance. Built in port for optional (PN 609 008) pressure relief valve. **Flange mounted pump.**



PRODUCTS HANDLED

- Synthetic and mineral based oil.
- Hydraulic oil.
- Gear lube.
- Transmission fluid.

MARKETS

- Very large auto and truck dealers.
- Construction equipment maintenance.
- Mining equipment maintenance.
- Large fleets.
- Railroad and mass transit maintenance.
- Marine.
- In plant oil distribution.

MODELS		
PART No.	APPLICATION	WEIGHT
537 131	Universal stub pump. Flange mounted	41.9 lb (19 kg)

TECHNICAL DATA PRESSURE RATIO 12:1	
Air pressure operating range	20 to 170 psi (1,5 to 12 bar)
Air consumption (1)	41 scfm (1.150 NI)
Maximum fluid outlet pressure	2,040 psi (144 bar)
Air motor effective diameter	6" (150 mm)
Air motor stroke	4" (100 mm)
Delivery at 60 cpm	5.3 gal/min (20 l/min)
Maximum free flow delivery	17 gal/min (65 l/min)
Air inlet	1/2" NPTF
Fluid inlet	1 1/2" NPTF
Fluid outlet	3/4" NPTF
Wetted and seal materials	Cast iron / Hard chromed steel / Steel / Polyurethane / NBR
Noise level (2)	80 dB
Manual	853 818

DIMENSIONS Inches - (mm)	
PART No.	537 131
A	28 1/4" (716)
B	20 1/4" (516)
C	2 3/4" (70)
D	8" (200)

(1) Maximum air consumption with 72 psi (5 bar) air inlet pressure and 60 cpm.
 (2) Maximum noise level measured at 3' (1 m) from the pump, 100 psi (7 bar) air pressure and free delivery.

SAE 10, 70 °F (21 °C) CAPACITY CURVE

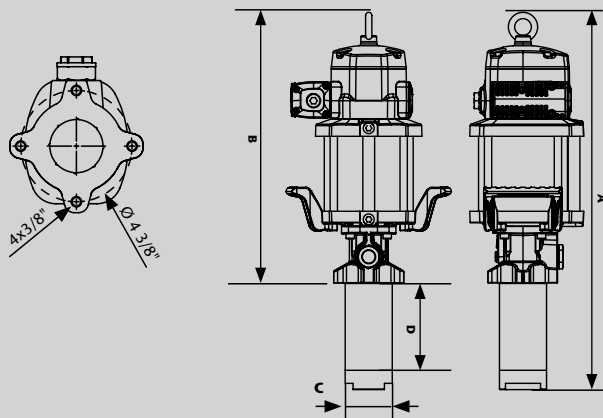
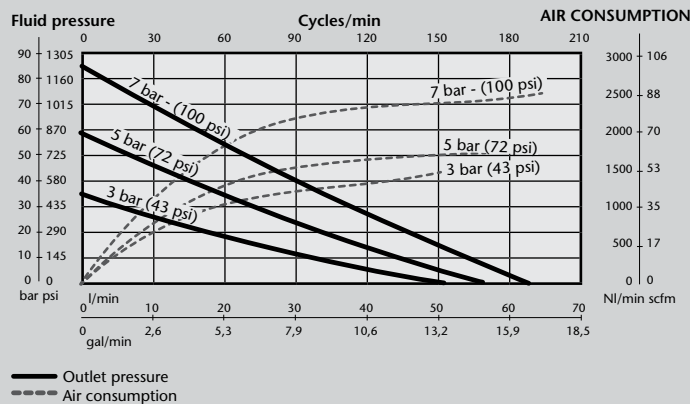

OIL PUMP ACCESSORIES

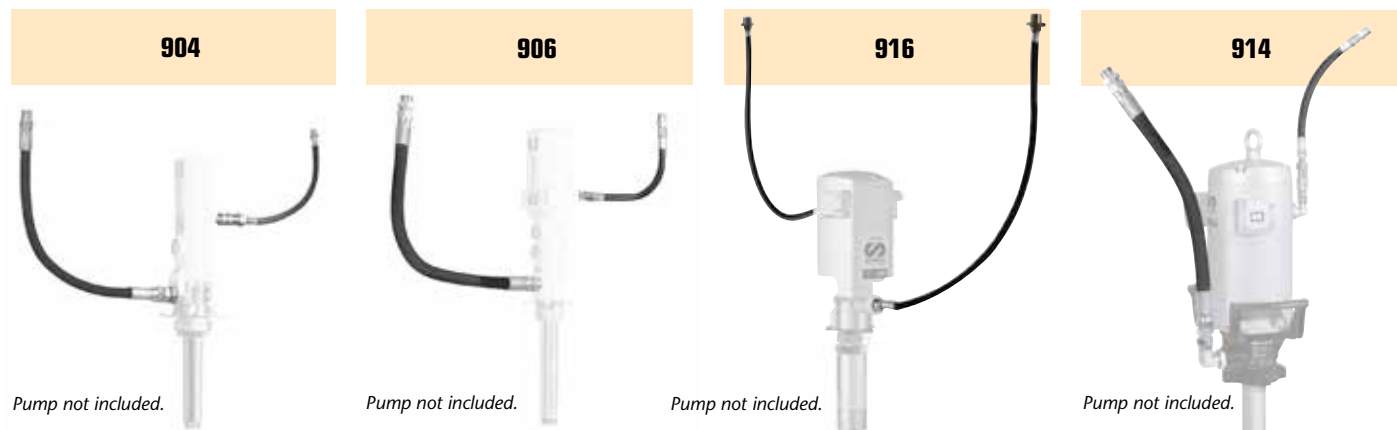

Pump not included.

Pump not included.

Pump not included.

Pump not included.

HOSE CONNECTION KITS

Part No. 904

Medium pressure hose installation hook-up connection kit for PumpMaster 2 - 1:1 and 3:1 oil pumps.

Includes the following:

- Part No. 802: 5' air hose, 1/4" NPTM both ends.
- Part No. 930F04: Quick air coupler, 1/4" NPTF.
- Part No. 933M04: Quick air nipple, 1/4" NPTM.
- Part No. 857: 5' medium pressure 3/4" hose, 3/4" NPTM both ends.

Recommended option:

Part No. 955 air filter regulator combo, 1/4" NTPF.

Part No. 906

Medium pressure hose installation hook-up connection kit for PumpMaster 4 - 3:1 and 5:1 oil pumps.

Includes the following:

- Part No. 813: 5' air hose, 3/8" NPTM both ends.
- Part No. 930F06: Quick air coupler, 3/8" NPTF.
- Part No. 933M06: Quick air nipple, 3/8" NPTM.
- Part No. 857: 5' medium pressure 3/4" hose, 3/4" NPTM both ends.

Recommended option:

Part No. 957 air filter regulator combo, 3/8" NTPF.

Part No. 916

Medium pressure hose hook-up connection kit for PumpMaster 35 - 5:1 and 8:1 oil pumps.

Includes the following:

- Part No. 813: 5' air hose, 3/8" NPTM both ends.
- Part No. 930F06: Quick air coupler, 3/8" NPTF.
- Part No. 933M06: Quick air nipple, 3/8" NPTM.
- Part No. 846: 5' medium pressure 1/2" hose, 1/2" NPTM both ends.

Recommended option:

Part No. 957 air filter regulator combo, 3/8" NTPF.

Part No. 914

Medium pressure hose installation hook-up connection kit for PumpMaster 45 and 60 oil pumps.

Includes the following:

- Part No. 823: 5' air hose, 1/2" NPTM both ends.
- Part No. 935F08: Quick air coupler, 1/2" NPTF.
- Part No. 936M08: Quick air nipple, 1/2" NPTM.
- Part No. 857: 5' medium pressure 3/4" hose, 3/4" NPTM both ends.
- Part No. 1981: 90° swivel, 1/2" NPTF x 1/2" NPTM.
- Part No. 1982: 90° swivel, 3/4" NPTF x 3/4" NPTM.

Recommended option:

Part No. 958 air filter regulator combo, 1/2" NTPF.

All air and oil hoses have one swivel end.

PUMP BRACKETS

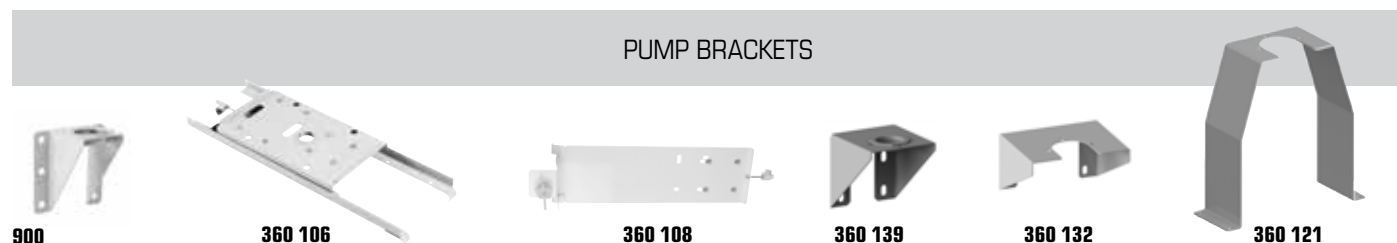

PART No.	FOR PUMPMaster 2 AND PUMPMaster 4 OIL PUMPS
900	Wall mount bracket. 2" NPTF bung opening.
360 106	Bracket for mounting PumpMaster 2 or PumpMaster 4 pump and reel to top of a 275/330 gal tote. (Requires pump bracket 900 extra)
360 107	Bracket for mounting PumpMaster 2 or PumpMaster 4 pump and reel on one side of a 275/330 gal tote. (Requires pump bracket 900, pivoting bracket 1388 optional)
360 108	Bracket for mounting a PumpMaster 2 or PumpMaster 4 pump on one side of a 275/330 gal tote. (Requires pump bracket 900)
360 120	Floor bracket for PumpMaster 2 and PumpMaster 4 pumps
PART No.	FOR PUMPMaster 35 OIL PUMPS (5:1 AND 8:1)
360 139	Wall mount bracket, 2" NPTF bung opening
360 140	Wall mount bracket, flange mounted pumps.
PART No.	FOR PUMPMaster 45 AND PUMPMaster 60 OIL PUMPS
360 121	Floor mount bracket. For PM45 and PM60 flange mounted pumps
360 132	Wall mount bracket. For PM45 and PM60 flange mounted pumps



OIL PUMP ACCESSORIES

DRUM COVERS



1936

Deluxe Drum Covers

2" NPTF bung opening, allows mounting a PM2 or a PM4 pump to an open top 55 or 16 gal drum. For PumpMaster 2 and PumpMaster 4 oil pumps.

Part No. 1936

Deluxe cover for 16 gal open top kegs.

Part No. 1938

Deluxe cover for 55 gal open top drums.



418 026

Heavy-Duty Drum Covers

Allows mounting a flange mounted PM45 - 10:1 pump to an open top keg or drum.

Part No. 418 017

Deluxe cover for 16 gal open top kegs.

Part No. 418 026

Deluxe cover for 55 gal open top drums.



360 133

Part No. 360 133

Bung mount adaptor for flange type drum cover.

Converts flange mount to standard 2" NPT bung opening. Permits the use of bung mounted type pumps (PM2, PM4 and PM35) with Heavy-Duty drum cover.



360 006

Part No. 360 001 For PM2 - 1:1 pressure ratio pumps and PM4 - 3:1 pressure ratio pumps.

Part No. 360 000 For PM2 - 3:1 pressure ratio pump.

Part No. 360 002 For PM4 - 5:1 pressure ratio pumps and PM35- 8:1 pressure ratio pumps.

Part No. 609 004 For PM35 - 5:1 pressure ratio pumps.

Part No. 360 006 For PM45 - 10:1 pressure ratio pumps.



244 901

Part No. 244 901

All weather protection bung adaptor cover. When placed between the pump and the bung adaptor, prevents water passing to the oil container in outdoors applications. For PM2 - 3:1, PM4 - 5:1 and PM35 - 8:1 pumps.

BUNG BUSHING ADAPTORS

SUCTION ACCESSORIES



912

Part No. 910 Siphon kit for pumps

Use with PumpMaster 2 and PumpMaster 4 pumps. Siphon kit consisting of 40" suction tube with foot valve, 2" bung bushing adaptor, 8' spring reinforced transparent hose, 3/4" (F) swivel end, one PM2 - 3:1 pump to hose connector, 3/4" MM and one PM4 - 3:1 and 5:1 pump to hose connector, 3/4" M x 1" M. Suction tube length: 46"

Part No. 912 Siphon kit for wall mount pumps

Use with PumpMaster 2 - 3:1 and PumpMaster 4 - 3:1 and 5:1 pumps.

Includes the following:

Part No. 900: Wall mount bracket.

Part No. 910: Siphon kit.

Part No. 926 Suction hose kit for wall mounted pumps

Use with PumpMaster 35, PumpMaster 45 and PumpMaster 60 pumps.

Includes the following:

Part No. 863 506: 6' medium pressure 1 1/2" hose, 1 1/2" NPTM both ends, swivel one end.

Part No. 2520: Elbow 1 1/2" NPT M x 1 1/2" NPT F.

Order bracket 360 139 for PM35 pumps or 360 132 for PM45 and PM60 pumps separately.

OIL PUMP ACCESSORIES



PRESSURE RELIEF VALVES

609 007 - 94112023

Fluids submitted to temperature increase in confined spaces, such as rigid pipes and even hoses, can create a rise in pressure due to the thermal expansion. System over pressure might occur and it can result in equipment rupture and personal injury. All Samson oil pumps include a 1/4" plug that can be removed and replaced with a pressure relief valve. Relief valves include 36" transparent return tube.

Part No. 609 007

Pressure relief valve. Opens at approx. 900 psi, for PumpMaster 2 - 3:1 pumps, PumpMaster 4 - 3:1 and 5:1 pumps, PumpMaster 35 - 5:1 pumps, PumpMaster 45 - 3:1, 6:1 pumps and PumpMaster 60 - 6:1 pumps.



Part No. 609 008

Pressure relief valve. Opens at approx. 1,450 psi, for PumpMaster 35 - 8:1 pumps, PumpMaster 45 - 10:1 pumps and PumpMaster 60 - 12:1 pumps.



Part No. 94112023

Double tap bushing, 2" (M) x 1-1/2" (F) threads. With a 1/8" NPTF opening for pressure relief return line. Use with 1-1/2" (MM) adaptor for PM35 - 5:1 pumps. Use with 1-1/2" (M) x 1" (M) adaptor for PM4 - 3:1 and 5:1 pumps.

AUTO STOP VALVES

2525

The auto stop valve is designed to stop operation of a reciprocating type air motor in the event of a ruptured outlet hose or the pump runs out of material. The auto stop valve senses an increased volume of air to the pump, beyond the pre-adjusted setting, and shuts off the air to the pump.

Part No. 2525

Auto stop valve, 1/4" inlet and outlet.



Part No. 2550

Auto stop valve, 1/2" inlet and outlet.

SHUT OFF VALVES

2074 - 2013

LOW PRESSURE BALL VALVES		MEDIUM PRESSURE BALL VALVES		HIGH PRESSURE NEEDLE VALVES	
600 psi		2,000 psi		10,000 psi	
PART No.	NPTF	PART No.	NPTF	PART No.	NPTF
2013	1/4"	2074	1/2"	2077	1/2"
2088	1/2"	2083	3/4"	2089	3/4"
2091	3/4"	2090	1"	2093	1"
2084	1"	2082	1 1/2"		





OIL PUMP ACCESSORIES

OIL PUMP MOUNTING ACCESSORIES QUICK REFERENCE CHART

PUMP	PUMPMASTER 2		PUMPMASTER 4		PUMPMASTER 35		PUMPMASTER 45			PUMPMASTER 60	
	1:1	3:1	3:1	5:1	5:1	8:1	3:1	6:1	10:1	6:1	12:1
BUNG ADAPTOR	360 001	360 000	360 001	360 002	609 004	360 002	(1)	(1)	360 006	(1)	(1)
CONNECTION HOSE KIT	904	904	906	906	916	916	914	914	914	914	914
WALL MOUNTING BRACKET	900	900	900	900	360 139	360 140	360 132	360 132	360 132	360 132	360 132
FLOOR BRACKET	360 120	360 120	360 120	360 120	-	-	360 121	360 121	360 121	360 121	360 121
THERMAL RELIEF KIT	Not needed	609 007	609 007	609 007	609 007	609 008	609 007	609 007	609 008	609 007	609 008
AIR REGULATOR WITH GAUGE	991	991	973	973	973	973	976	976	976	976	976
AIR FILTER REGULATOR (F/R)	955	955	957	957	957	957	958	958	958	958	958
FRL	995	995	984	984	984	984	985	985	985	985	985
AIRLINE SHUTOFF VALVE	2013	2013	2088	2088	2088	2088	2088	2088	2088	2088	2088
FLUID SHUTOFF VALVE	2083	2083	2083	2083	2074	2074	2083	2083	2083	2083	2083
SUCTION KIT (*)	910	910	910	910	926	926	(2)	(2)	926	(2)	(2)
QUICK AIR COUPLER	930F04	930F04	930F06	930F06	930F06	930F06	935F08	938F08	938F08	938F08	938F08
QUICK AIR NIPPLE	933M04	933M04	933M06	933M06	933M06	933M06	947M08	947M08	947M08	947M08	947M08
AIR CONNECTION ACCESSORIES I.D.	1/4" 6 mm	1/4" 6 mm	3/8" 8 mm	3/8" 8 mm	3/8" 8 mm	3/8" 8 mm	1/2" 12 mm	1/2" 12,5 mm	1/2" 12,5 mm	1/2" 12,5 mm	1/2" 12,5 mm

(*) Suction kit for 55 gal (200 l) drum. Pump bracket not included.
 (1) Pump must be wall or floor mounted.
 (2) SAMSON recommends using 1 1/2" x 6' maximum length hose as suction kit.

Pump installation recommendations

- Always use a ball valve between the tank outlet and the suction hose in flooded suction installations.
- Always use a ball valve between the pump outlet hose and the fluid distribution line.